

BENCHMARK:

1. "□" Cut in South Side of Hardtner Cir., 40' East of end of Existing Pavment, or 10' East and 14.5' North of Northwest corner of Lot 18, Block A.
Elev. = 145.85 (City Datum)

2. "□" Cut in Top of Curb Adjacent to the Southeast Corner of Lot 1, Block A.
Elev. = 147.34

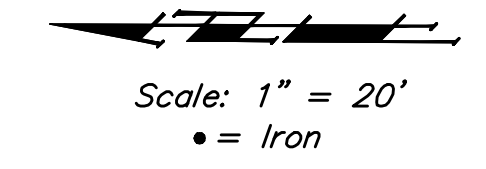

VALVE LOCATION TABLE			
VALVE NUMBER	BASELINE STATION	OFFSET DISTANCE	OFFSET DIRECTION
V1	6+00.65	21'	Rt.
V2	8+08.58	40.38'	Lt.

Paving contractor will be responsible to operate all water valves on the project, in the presence of the inspector, to ensure accessibility to the valves, and that all valves are left in the "ON" position when the project is completed.

P.V.I.
Elev. = 43.62
No V.C.

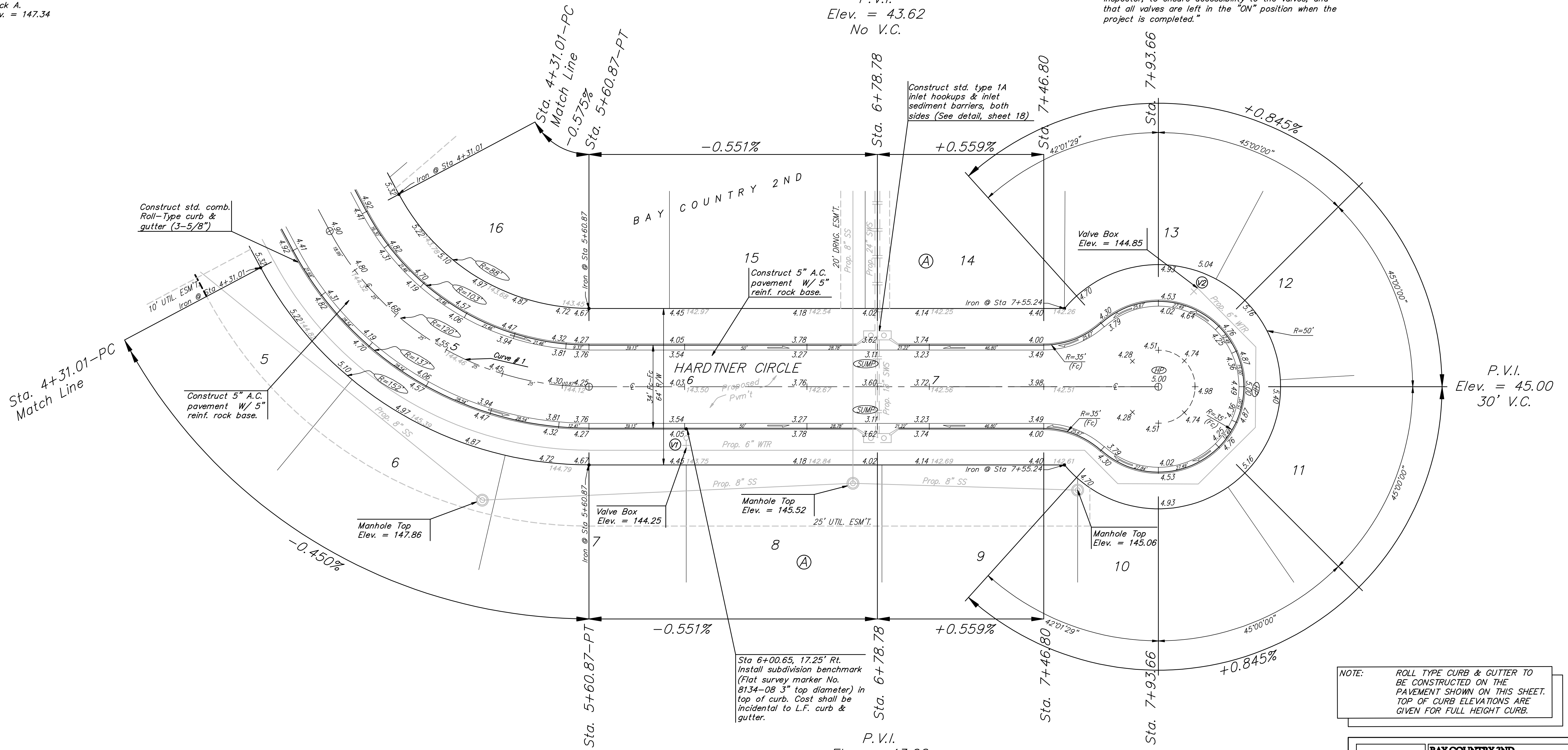

P.V.I.
Elev. = 45.00
30' V.C.

NOTE: ROLL TYPE CURB & GUTTER TO BE CONSTRUCTED ON THE PAVEMENT SHOWN ON THIS SHEET. TOP OF CURB ELEVATIONS ARE GIVEN FOR FULL HEIGHT CURB.

Subdivision Bench Marks		
Street & Station	Location Description	Elevation
Hardtner Circle (-----) 6+00.65, 17.25' Rt.	Adjacent to Fire Hydrant Between Lots 7 and 8, Block A.	

Curve #1
Curve Data Based on Centerline
Rad. = 120' Delta = 62°00'23" Tangent = 72.11'
Arc = 129.86' L.C. = 123.62' Def./Ft. = 14.32459 Min.

Station	Arc	Face Chord Lengths		Defl.	Total Defl.
		8' Left	8' Right		
4+31.01	-	-	-	0°00'00"	0°00'00"
4+50.00	18.99'	15.02'	22.92'	4°32'01"	4°32'01"
4+75.00	25.00'	19.76'	30.16'	5°58'07"	10°30'08"
5+00.00	25.00'	19.76'	30.16'	5°58'07"	16°28'15"
5+25.00	25.00'	19.76'	30.16'	5°58'07"	22°26'22"
5+50.00	25.00'	19.76'	30.16'	5°58'07"	28°24'29"
5+60.87	10.87'	8.60'	13.13'	2°35'42"	31°00'11"

Baughman		BAY COUNTRY 2ND	
Hardtner Circle		Sta 4+31.01 to Sta 7+93.66	
Baughman Company, P.A. 315 10th St. White, NJ 07211 F316487721 F316487049			
ENGINEERING SURVEYING PLANNING LANDSCAPE ARCHITECTURE			
PROJECT NUMBER	DESIGN	DRAWN	
	NBW	TT	
REVISIONS:	APPROVED	DATE	
	NBW	2/22/2010	
	SCALE	Noted	
	SHEET	5 OF 21	
B:\Bay Country 2nd\Hardtner Cir\STR 650\05STR R1.dwg 06-05-11			