

BENCHMARKS:
 C.O.W. Disc SE Corner West St. & 47th S.
 Elev. = 92.29 (City Datum)

RR Spike in N. face of power pole, SE Corner
 47th So. & Kessler
 Elev. = 91.74 (City Datum)

"□" Cut in Top of Curb Adjacent to the NW
 Corner Lot 27, Block C.
 Elev. = 93.57 (City Datum)

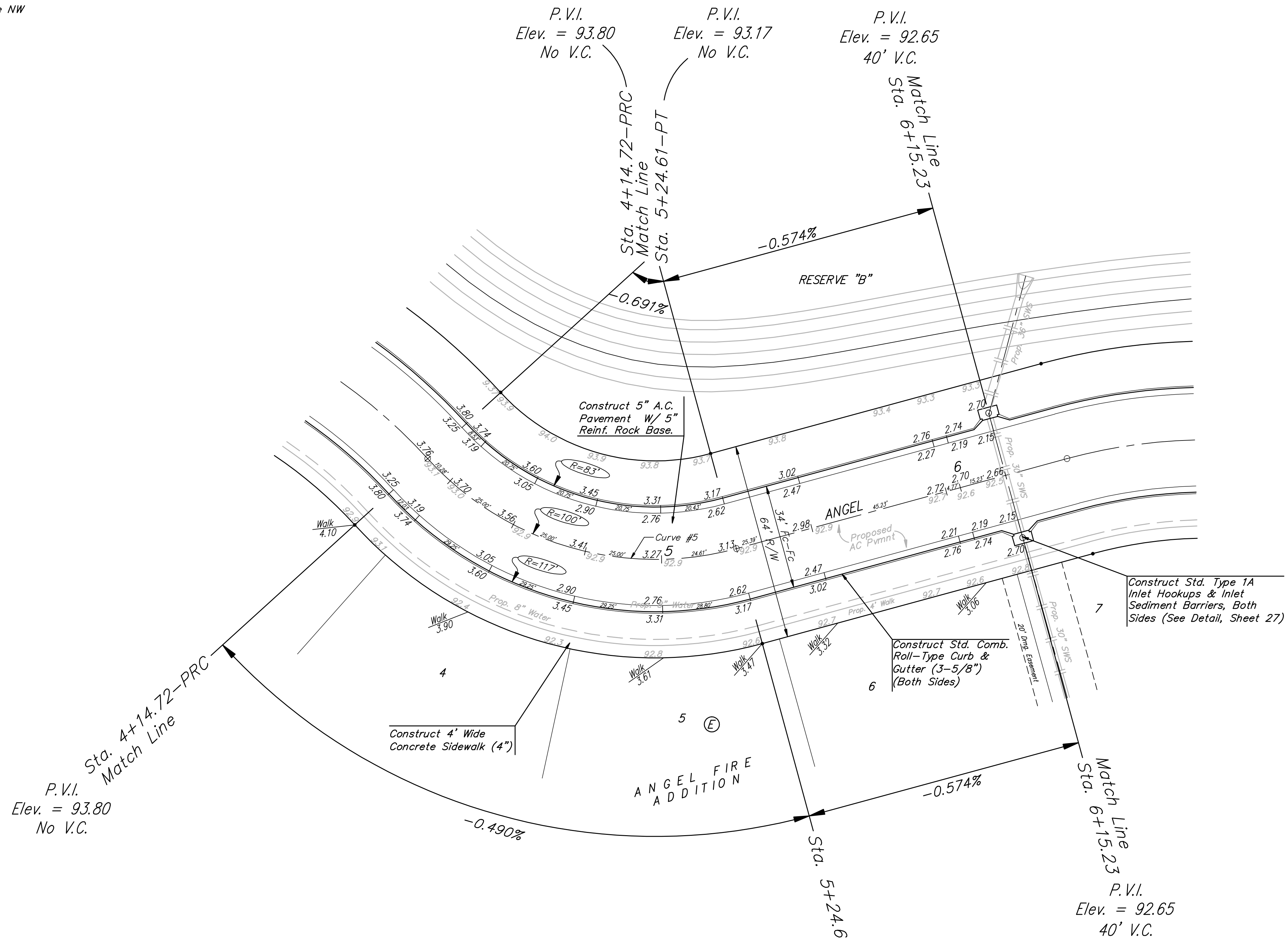
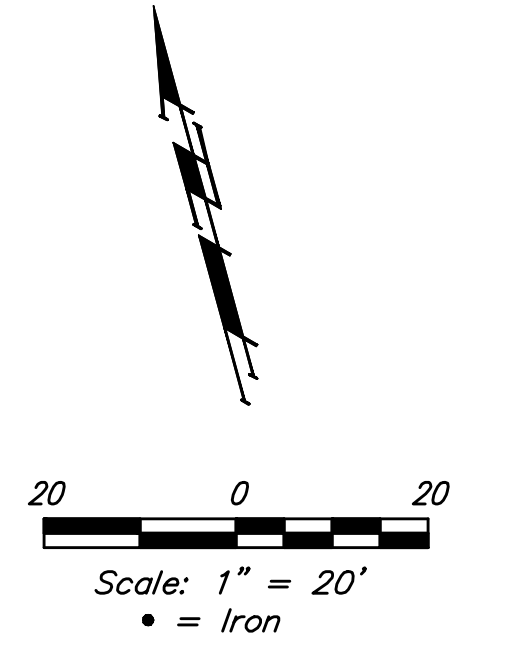

Curve #5

Curve Data Based on Centerline

Rad. = 100' Delta = 62°57'51" Tangent = 61.24'
 Arc = 109.89' L.C. = 104.45' Def./Ft. = 17.18923 Min.

Station	Arc	Face Chord Lengths		Defl.	Total Defl.
		8' Left	8' Right		
4+14.72	-	-	-	0°00'00"	0°00'00"
4+25.00	10.28'	7.71'	12.84'	2°56'42"	2°56'42"
4+50.00	25.00'	18.70'	31.17'	7°09'44"	10°06'26"
4+75.00	25.00'	18.70'	31.17'	7°09'44"	17°16'10"
5+00.00	25.00'	18.70'	31.17'	7°09'44"	24°25'54"
5+24.61	24.61'	18.41'	30.69'	7°03'01"	31°28'55"

NOTE: ROLL TYPE CURB & GUTTER TO BE CONSTRUCTED ON THE PAVEMENT SHOWN ON THIS SHEET. TOP OF CURB ELEVATIONS ARE GIVEN FOR FULL HEIGHT CURB.

ANGEL FIRE ADDITION PH. 2
ANGEL
STA. 414.72 - 6+15.23
STREET/SWS IMPROVEMENTS

Baughman ENGINEERING | SURVEYING | PLANNING | LANDSCAPE ARCHITECTURE

310 W. 8th St., Wichita, KS 67211 P 316.262.7271 F 316.262.0149

PROJECT NUMBER 472-04886	DRAWN ABO
REVISIONS	TITLE TNT
	APPROVED ABO
	DATE 05/12/2010
	SCALE NOTED
	SHEET 12 OF 46

Project: Angel Fire Ph. 2/SFR 1002-B456