

BENCHMARKS:
 C.O.W. Disc SE Corner West St. & 47th S.
 Elev. = 92.29 (City Datum)
 RR Spike in N. face of power pole, SE Corner
 47th So. & Kessler
 Elev. = 91.74 (City Datum)
 "□" Cut in Top of Curb Adjacent to the NW
 Corner Lot 27, Block C.
 Elev. = 93.57 (City Datum)

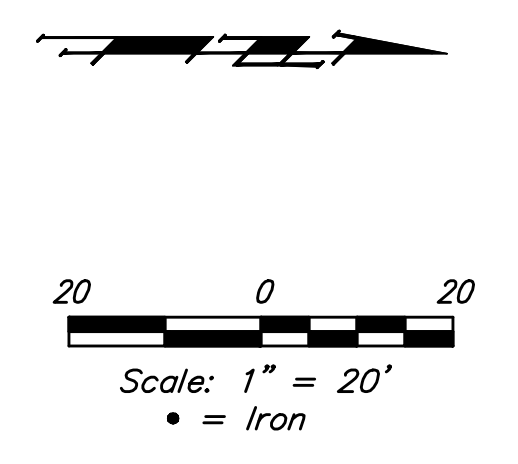
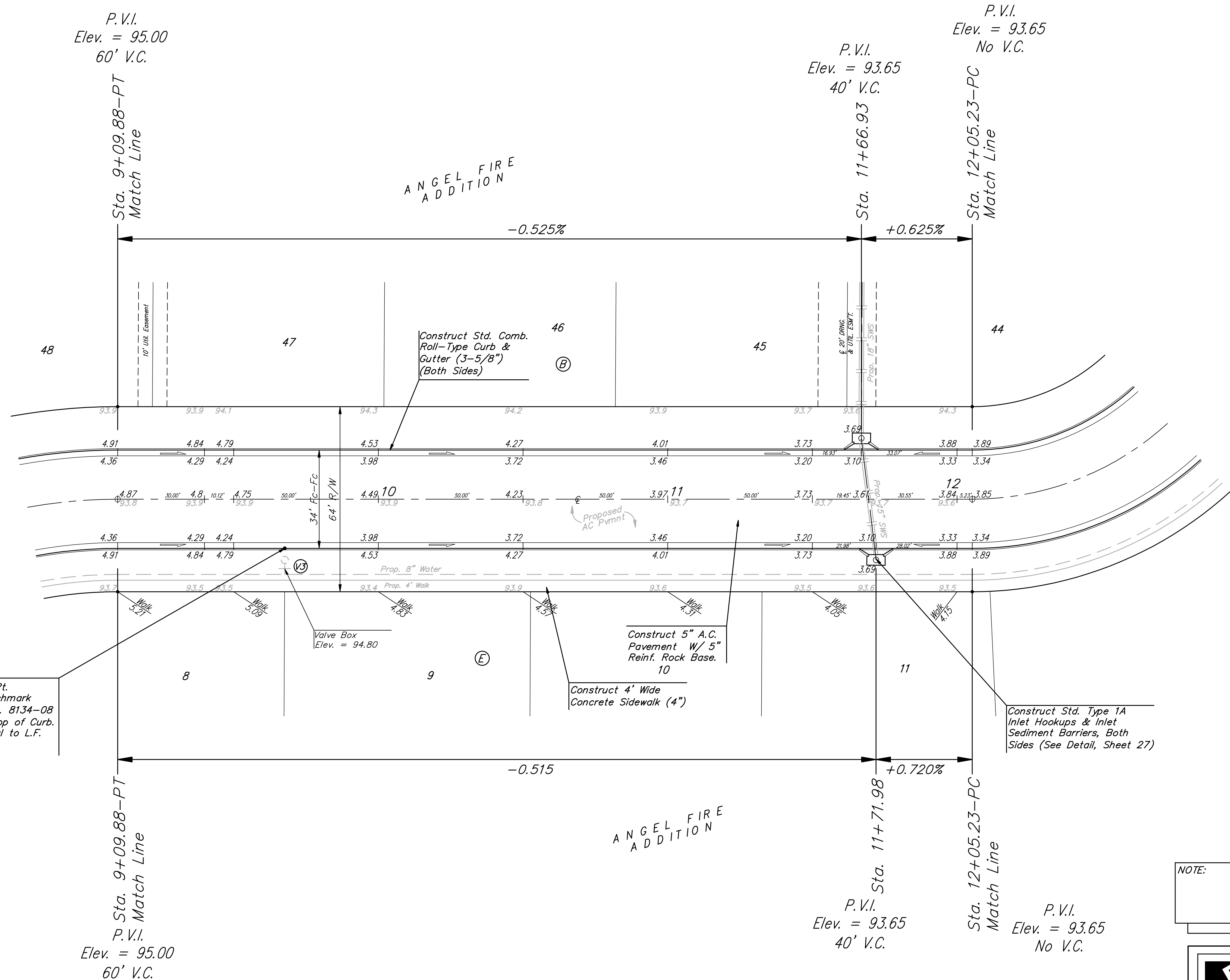

Sta. 9+67.62, 17.00' Rt.
 Install Subdivision Benchmark
 (Flat Survey Marker No. 8134-08
 3" Top Diameter) in Top of Curb.
 Cost Shall be Incidental to L.F.
 Curb & Gutter.

NOTE: ROLL TYPE CURB & GUTTER TO BE CONSTRUCTED ON THE PAVEMENT SHOWN ON THIS SHEET. TOP OF CURB ELEVATIONS ARE GIVEN FOR FULL HEIGHT CURB.

VALVE LOCATION TABLE

| VALVE NUMBER | BASELINE STATION | OFFSET DISTANCE | OFFSET DIRECTION |
|--------------|------------------|-----------------|------------------|
| V3 | 9+67.62 | 24 | Rt. |

Paving contractor will be responsible to operate all water valves on the project, in the presence of the inspector, to ensure accessibility to the valves, and that all valves are left in the "ON" position when the project is completed.

Baughman ENGINEERING | SURVEYING | PLANNING | LANDSCAPE ARCHITECTURE

ANGEL FIRE ADDITION PH. 2
 STA 9+09.88 - 12+05.23
 STREET/ SWS IMPROVEMENTS

PROJECT NUMBER: 472-8486
 DESIGN: AEG
 DRAWN: TNT
 APPROVED: AEG
 DATE: 05/12/2010

SCALE: NOTED
 SHEET: 14 OF 46

Project: Angel Fire Ph. 2 STR 10028456