

BENCHMARKS:
 C.O.W. Disc SE Corner West St. &
 47th S.
 Elev. = 92.29 (City Datum)

RR Spike in N. face of power pole,
 SE Corner 47th So. & Kessler
 Elev. = 91.74 (City Datum)

"□" Cut in Top of Curb Adjacent
 to the NW Corner Lot 27, Block C.
 Elev. = 93.57 (City Datum)

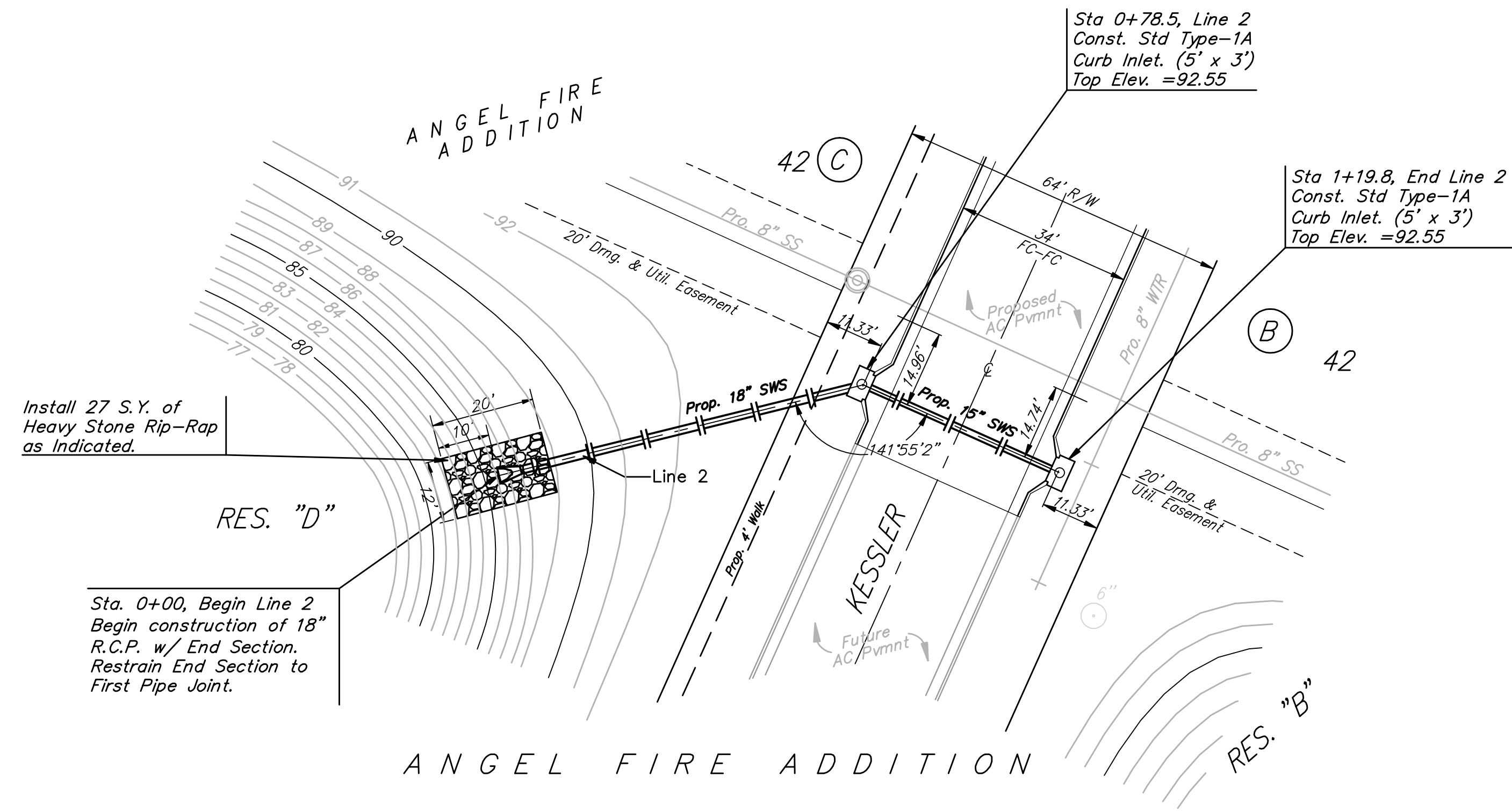

See Sheet 19 for
 Rip-Rap Detail

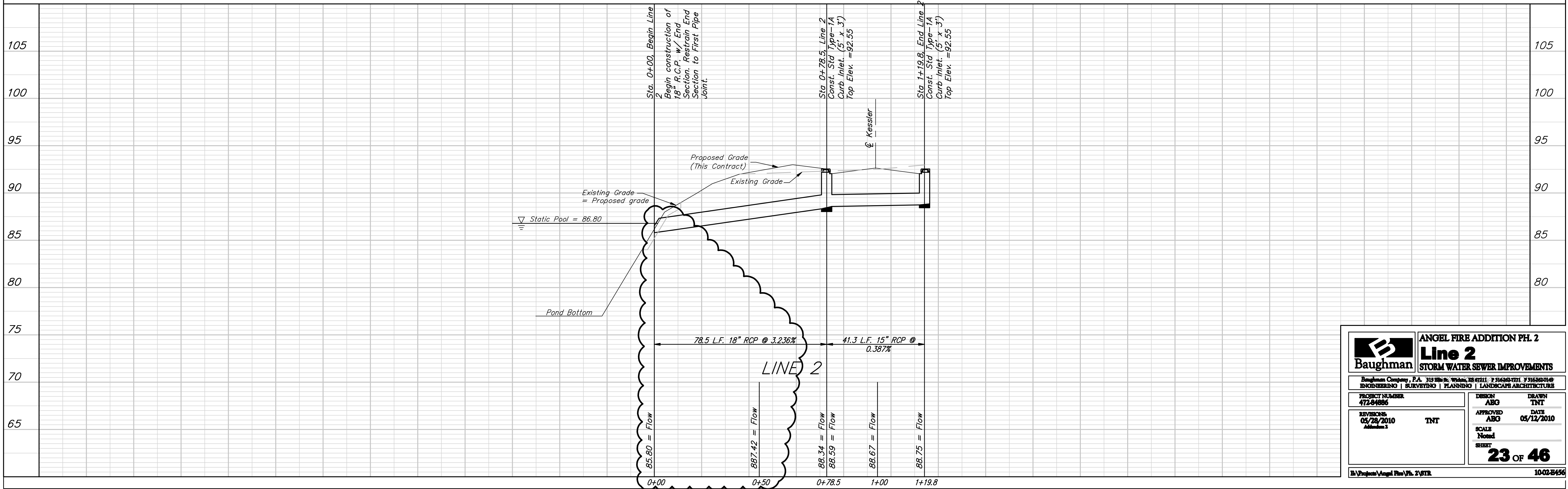
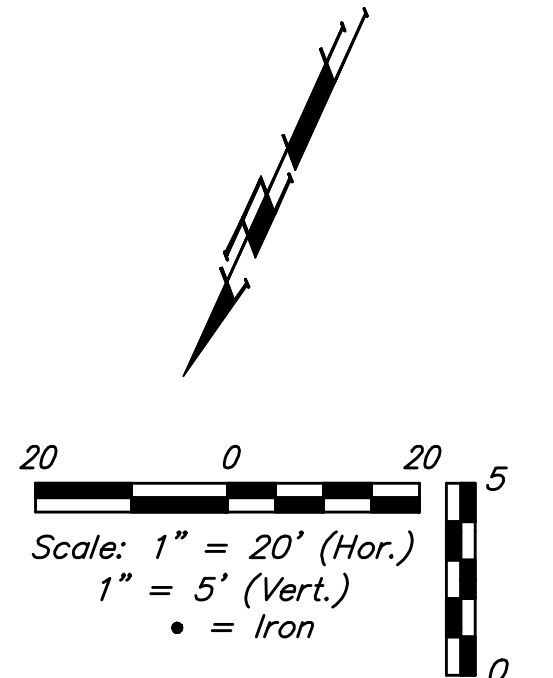

		ANGEL FIRE ADDITION PH. 2 Line 2 STORM WATER SEWER IMPROVEMENTS	
		<small>Baughman Company, P.A. 315 18th St. Naples, FL 34102 P 314-982-7711 F 314-982-0140 ENGINEERING SURVEYING PLANNING LANDSCAPE ARCHITECTURE</small>	
<small>PROJECT NUMBER</small> 472-94886	<small>DESIGN</small> ABG	<small>DRAWN</small> TNT	
<small>REVISIONS</small> 05/28/2010 <small>Admission 2</small>	<small>APPROVED</small> ABG	<small>DATE</small> 05/12/2010	
<small>SCALE</small> Noted		<small>SHEET</small> 23 of 46	
<small>Project: Angel Fire Ph. 2 SWS</small>			<small>10023456</small>