

Sheet Index

- 1 Title Sheet
- 2 Key Sheet
- 3 General Notes
- 4-6 Typical Pavement Sections
- 7-8 Pavement Details
- 9 Drive Details
- 10 Retaining Wall Details
- 11-21 Hillside Paving Plans
- 22 Hillside Joint Plan
- 23-25 Intersection Joint & Grading Plans
- 26 Valley Gutter Details
- 27 Side Street Details
- 28-30 Retaining Wall Plan/Profiles
- 31-36 Storm Water Sewer Plan/Profiles
- 37-42 Storm Water Sewer Details
- 43-59 Hillside Water Line Plans
- 60-65 Traffic Signal & Wiring Plans
- 66-68 Traffic Signal Details
- 69-79 Pavement Marking Plan
- 80 Signing Details
- 81 Traffic Control Typical Sections
- 82-83 Traffic Control Plans
- 84-86 Traffic Control Details
- 87 Restoration Areas
- 88 Drainage Area Map
- 89-91 Recapitulations of Quantities
- 92 Erosion Control Plan
- 93-96 Erosion Control Details
- 97-117 Earthwork Cross Sections
- 118 Earthwork Quantities

STATE OF KANSAS
DEPARTMENT OF TRANSPORTATION

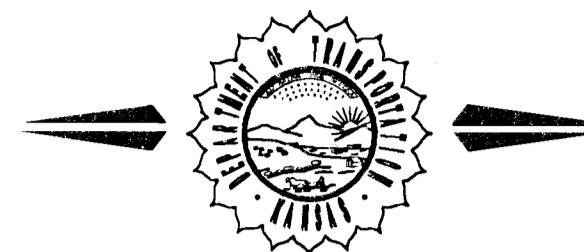

CONSTRUCTION PLANS FOR PROPOSED
HILLSIDE AVENUE
KELLOGG TO 3RD STREET NORTH
FEDERAL AID URBAN SYSTEM PROJECT

FOR
THE CITY OF WICHITA,
SEDGWICK COUNTY, KANSAS

James L. Armour, P.E. City Engineer

FHWA REGION NO.	STATE	PROJECT NO.	FISCAL YEAR	SHEET NO.	TOTAL SHEETS
7	KANSAS	87N-0226-01	2006	1	118

CMQ N-022(601)

- GRADING
- STORM SEWER
- SURFACING
- SIGNALIZATION
- PAVEMENT MARKING
- SODDING

Note:
All Dimensions shown without the SI suffix are in meters. All elevations shown are in meters

Traffic Note:
Traffic shall be carried through construction.
See sheet no. 76-77 for Construction Sequences.

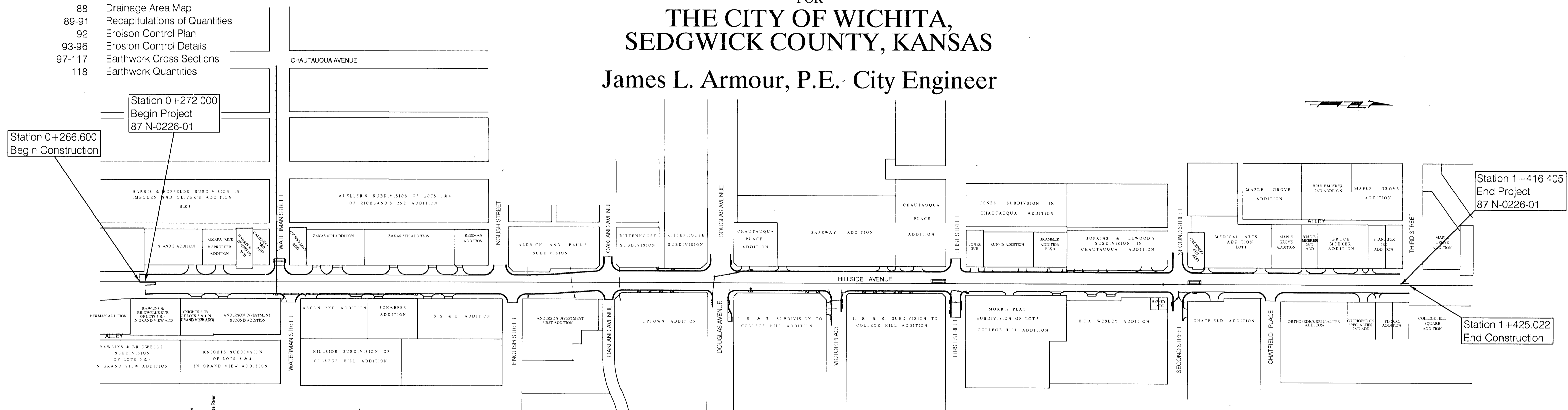

SITE

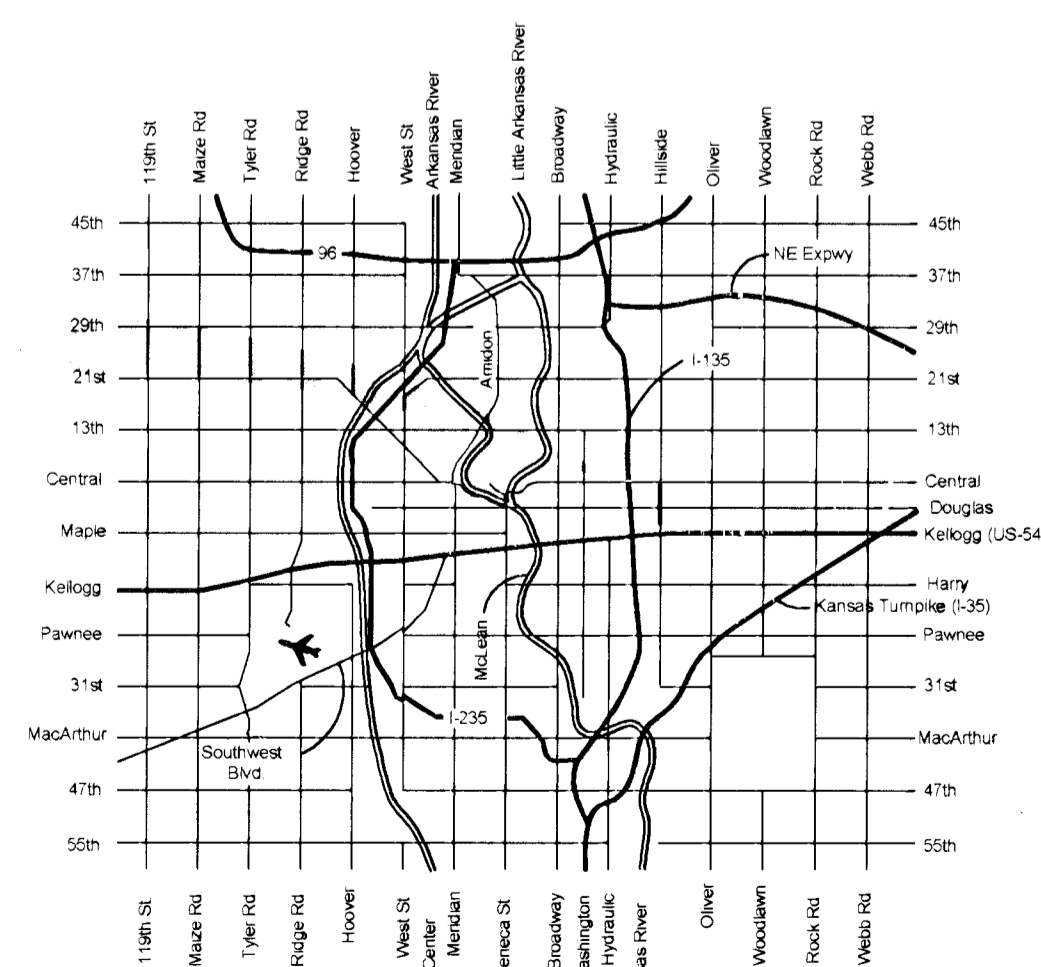

Vicinity Map

87 N-0226-01

City Project: 472-83862
O.C.A. No. 706867

May, 2006

Design Data

AADT (2000)	20,000
AADT (2030)	26,000
DHV	8%
T	3%
V	55 km/hr
C of A	N/A
Clear Zone	1.6m

Gross Length of Project	1144.405 m
Exceptions	0.000 m
Additions	0.000 m
Net Length of Project	1144.405 m
Net Length of Bridges	0.000 m
Net Length of Road	1144.405 m



APPROVED - DATE May 25, 2006

James L. Armour
JAMES L. ARMOUR, P.E., CITY ENGINEER
CITY OF WICHITA, KANSAS



BAUGHMAN COMPANY, P.A.
ENGINEERING, SURVEYING, & PLANNING
316-262-7271 • 315 ELLIS • WICHITA, KANSAS 67211