

**STATE OF KANSAS**  
**DEPARTMENT OF TRANSPORTATION**

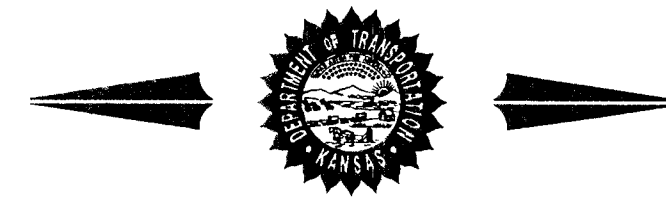

**PLAN AND PROFILE OF PROPOSED**  
**INTERSECTION OF TYLER ROAD AND YOSEMITE**

**FEDERAL AID PROJECT**  
**CITY OF WICHITA PROJECT NO. 472-84176**  
**OCA # 706917**  
**WICHITA, SEDGWICK COUNTY**

STATE	PROJECT NO.	YEAR	SHEET NO.	TOTAL SHEETS
KANSAS	87 N-0239-01	2004	1	47

**PROJECT NO. 87 N-0239-01**  
**F.A. NO. STP NO23 (901)**  
 GRADING  
 PAVEMENT MARKING  
 SURFACING  
 SEEDING

INDEX OF SHEETS

1	TITLE SHEET
2	TYPICAL SECTIONS
3-4	PLAN
5	GRADING PLAN
6-14	GUARDFENCE PLAN AND DETAILS
15-20	RCB DETAILS
21	SUMMARY OF QUANTITIES
22-25	TEMPORARY EROSION & POLLUTION CONTROL
26-28	PAVEMENT MARKING
29-39	TRAFFIC CONTROL
40-47	CROSS SECTIONS

DATE	
BY	
SURVEY	
CADD TECHNICIAN	
DESIGNERS	
SQUAD	

STA. 603+36.66, END  
 PROJ. 87 N-0239-01

STA. 594+88.15, BEGIN  
 PROJ. 87 N-0239-01

TYLER ROAD DESIGN DESIGNATION

AADT (2003)	4598
AADT (2023)	6934
DHV	11%
D	65%
T	7%
V	50 mph
C of A	none
Clear Zone	30 ft.

CITY OF WICHITA  
 POPULATION: 312,000

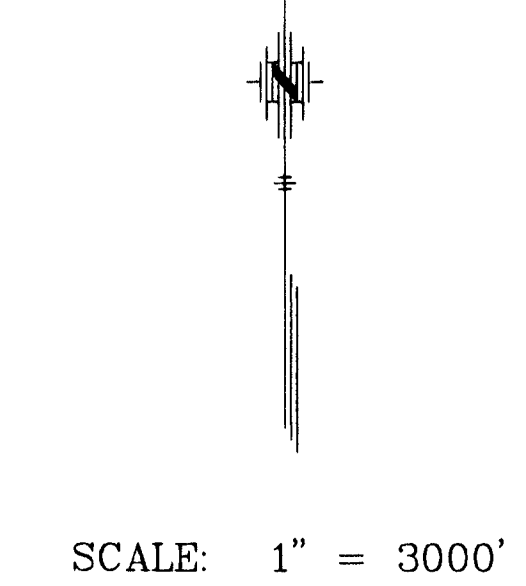
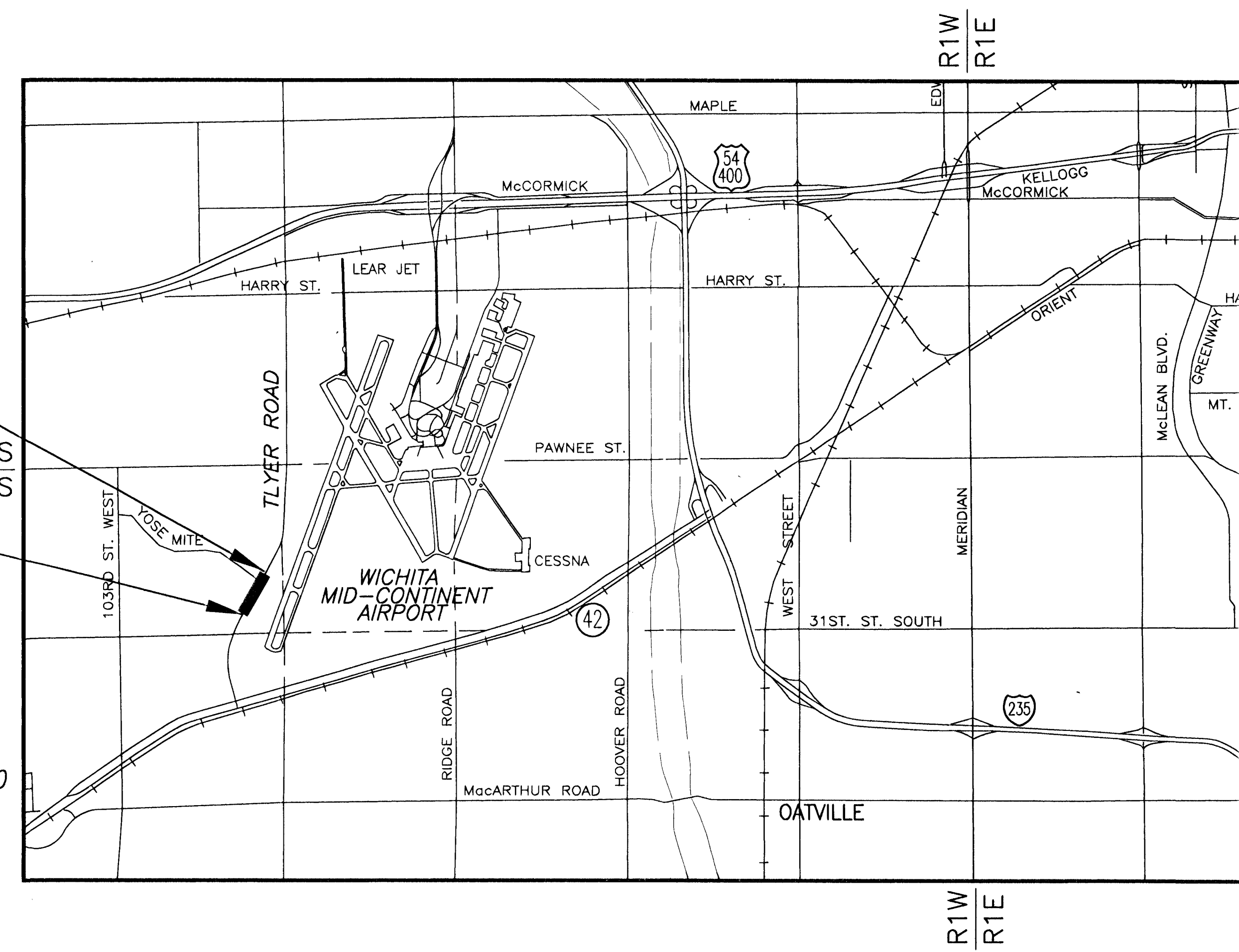

NOTE:  
 Traffic to be carried through construction.

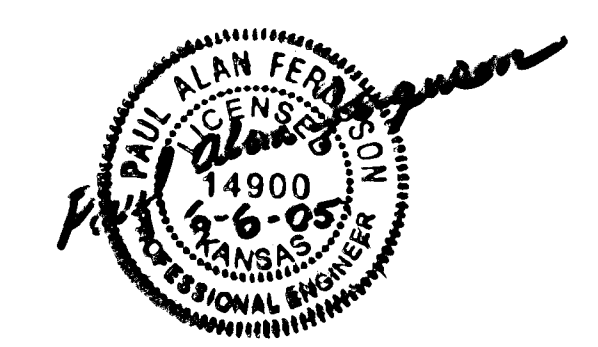

CONVENTIONAL SIGNS

COUNTY LINE	---	CENTER LINE OF PROJECT	---
CITY LIMITS	----	TERRACE	----
STATE OR NATIONAL LINE	----	CULVERTS	----
TOWNSHIP, SECTION or GRANT LINE	----	DROP INLET & STORM SEWER	----
PROPERTY LINE	----	ACCESS CONTROL	----
HIGHWAY FENCE	----	POWER POLE	----
EXISTING FENCE	----	TELEPHONE POLE	----
GUARD FENCE	----	MARSH	----
CONSTRUCTION LIMITS	----	HEDGE	----
RIGHT OF WAY LINE	----	TREES	----
TRAVELED WAY	----	PROFILE ELEVATION	----
RAILROADS	----	STREAM or CREEK	----

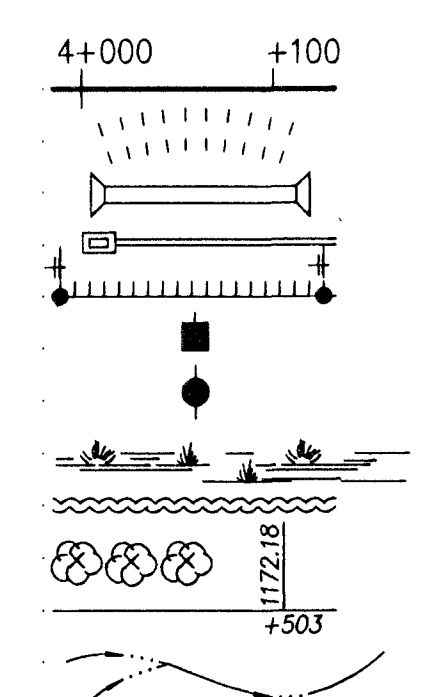

GROSS LENGTH OF PROJECT	848.51	ft.
EXCEPTIONS	0.00	ft.
NET LENGTH OF PROJECT	848.51	ft.
NET LENGTH OF BRIDGES	0.00	ft.
NET LENGTH OF ROAD	848.51	ft.

All dimensions shown without a suffix are in feet. All elevations shown are in feet.

**POE & ASSOCIATES, INC.**  
 CONSULTING ENGINEERS  
 1940 E. Central, Suite 200 • Wichita, KS 67208-4242  
 Phone 316/685-4114 • FAX 316/685-4444

APPROVED - DATE \_\_\_\_\_

JAMES ARMOUR, P.E.  
 CITY ENGINEER  
 CITY OF WICHITA PROJECT NO. 472-84176