

| | | |
|-------------|-----------|--------------|
| PROJECT NO. | SHEET NO. | TOTAL SHEETS |
| 472-84021 | 27 | 35 |

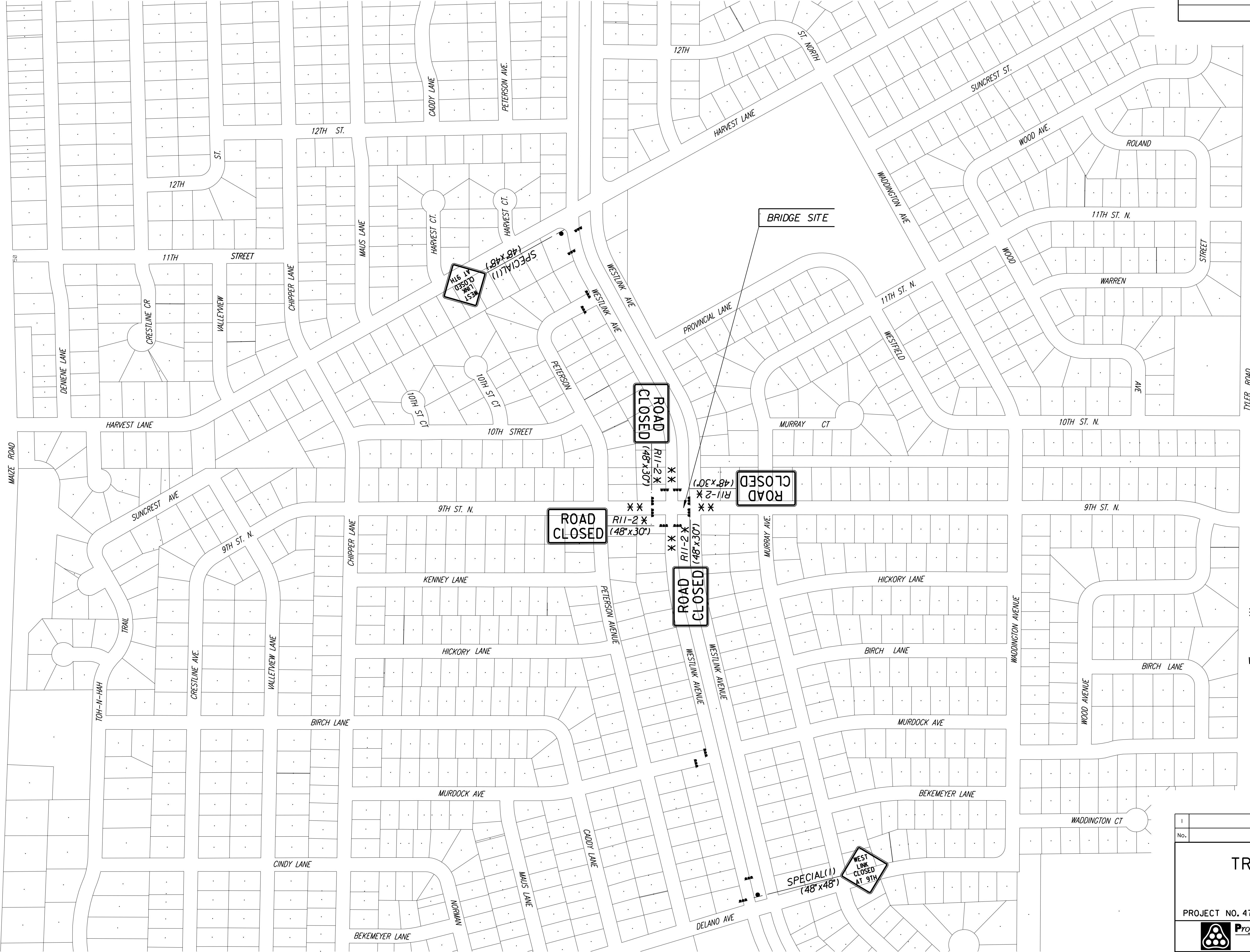

Scale: 1" = 200'

X X Type III Barricades to Totally Close Westlink Avenue.
Westlink Avenue Closed at 9th Street.

drawn by : SDB
 plotted by : drp 9-8-2004
 File: I:\2004\04330\off\tech\04330_C-Detail\EP1.dgn

| | | | |
|--|-----------|-----------------|-----------|
| 1 | | | |
| No. | Revisions | By | Date |
| CITY OF WICHITA, KANSAS TRAFFIC CONTROL STAGE I | | | |
| PROJECT NO. 472-84021 | | SEDGWICK COUNTY | |
| Professional Engineering Consultants, P.A. <small>303 S. TOPEKA • WICHITA, KANSAS 67202 316-262-2691 • FAX 316-262-3003</small> | | | |
| Designed by | RAS | Checked by | RAS |
| Drawn by | SDB | Date | JULY 2004 |
| | | Job No. | 04330 |