

LEGEND

- | | | |
|--|--|------------------------------------|
| | | Traffic Signal Controller |
| | | Traffic Signal Head |
| | | Traffic Signal Head with Backplate |
| | | Pedestrian Signal Pole |
| | | Traffic Signal Pole |
| | | Luminaire |
| | | Movement Number |
| | | Pole Number |
| | | Street Name Sign |
| | | Signal Service Box |
| | | Westar Energy Manhole |
| | | Westar Energy Wood Pole |
| | | Westar Energy Metal Pole |
| | | SWB Wood Pole |
| | | City Metal Pole |
| | | Fire Hydrant |
| | | Water Valve |
| | | Pavement & Walk Removal |
| | | Video Detection Camera |
| | | Zone Detection Number |

SIGNAL HEADS

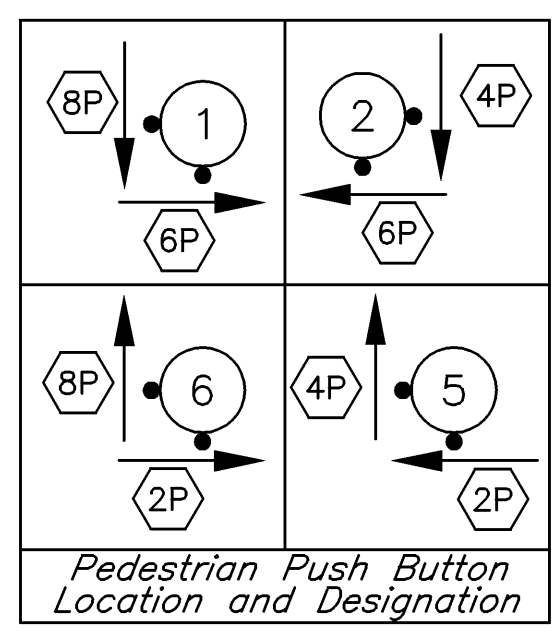
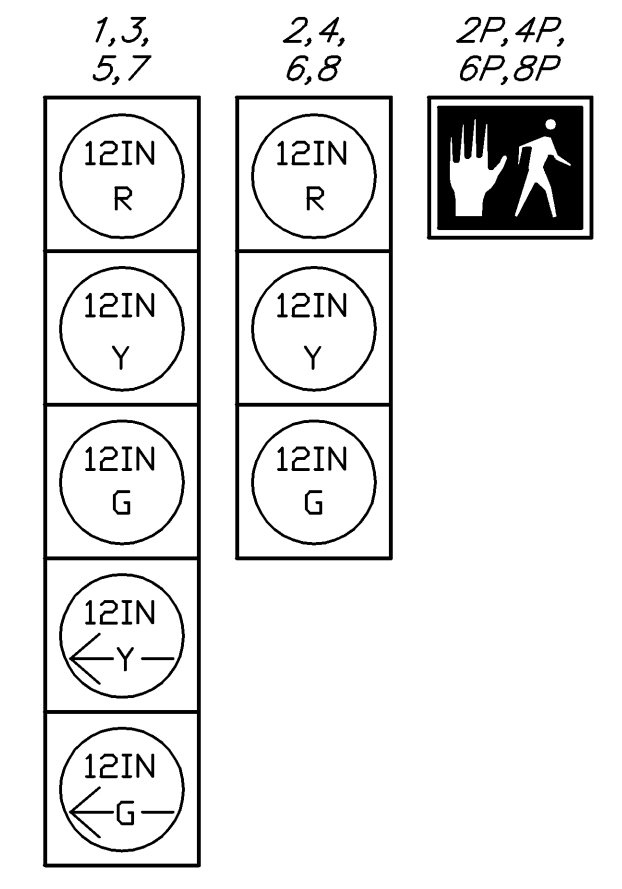

Meter Address:
3792 N. ROCK ROAD
#182969

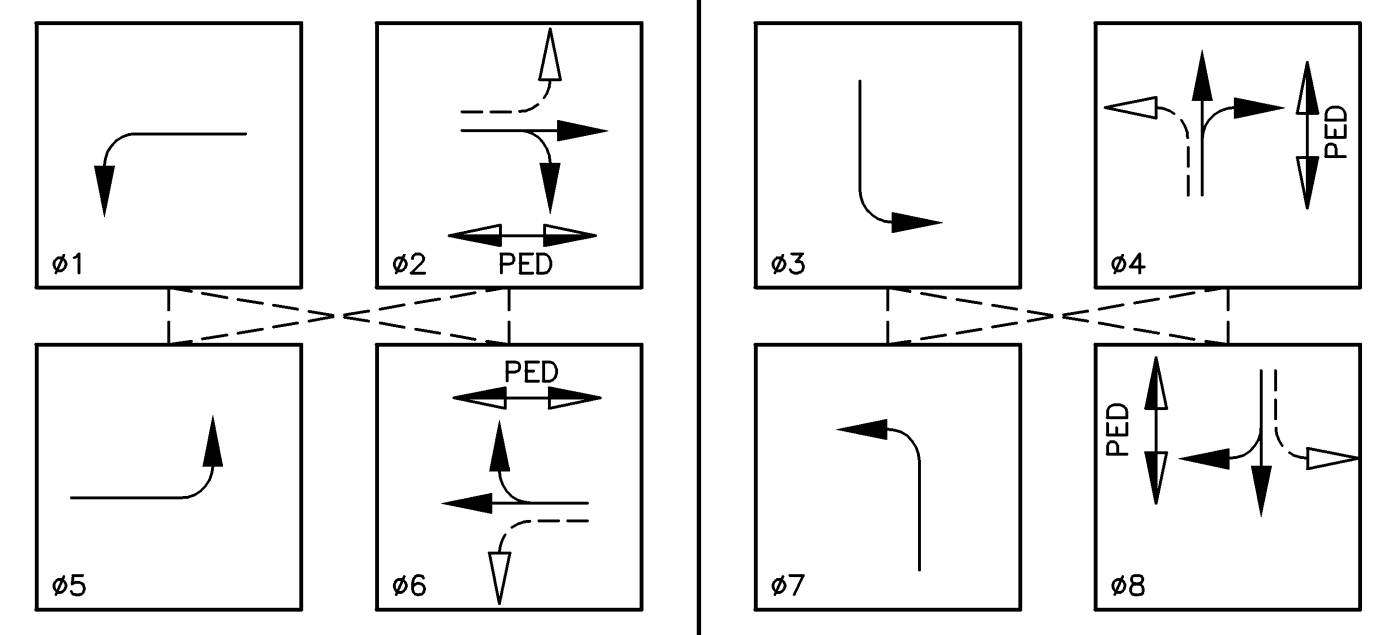

SIGNAL PHASING

----- DENOTES PHASES THAT MAY TIME CONCURRENTLY.
PEDESTRIAN INTERVALS TO OCCUR ONLY AFTER PUSHBUTTON ACTIVATION.

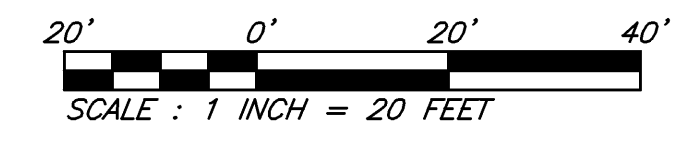
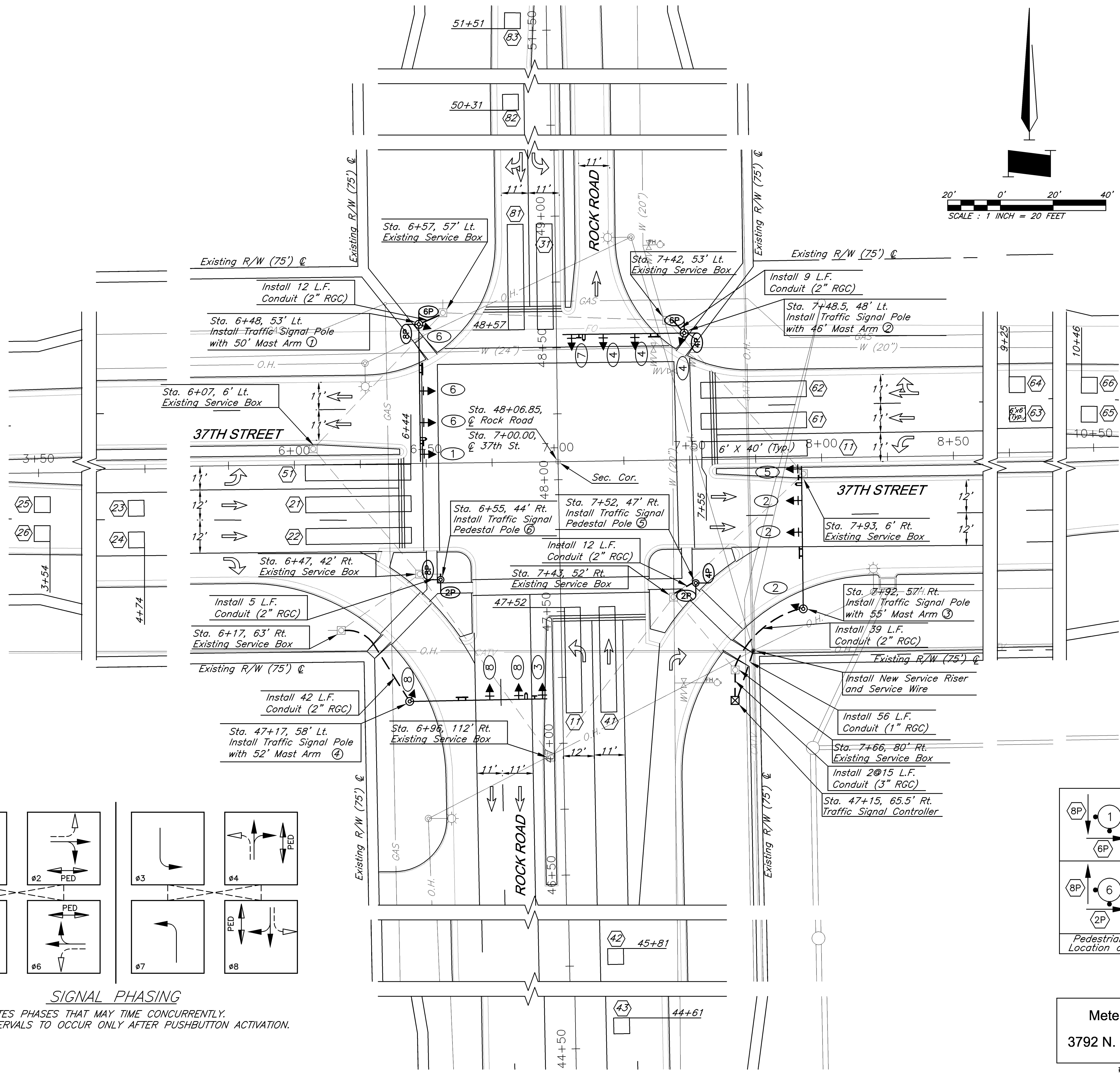

3					
2					
1					
NO.	DATE	REVISIONS	BY	APP'D	
CITY OF WICHITA, KANSAS SEDGWICK COUNTY TRAFFIC SIGNAL PLAN ROCK ROAD & 37TH STREET PROJECT NO. 472-84066					
GBA GEORGE BUTLER ASSOCIATES, INC. Engineers - Architects					
DESIGNED	SAC	CHECKED	SAC	PROJ. NO.	10459.00
DRAWN	JDB			DATE	AUGUST 17, 2004