

| | | |
|------|---------|------|
| PLAN | CHECKED | DATE |
| | CHECKED | |

| | | |
|---------|---------|------|
| PROFILE | CHECKED | DATE |
| | CHECKED | |

Saved: 03-04-2010 4:31:26 PM by: CSL
 Plot Scale: 1:20 03-04-2010 4:57:38 PM by: CSL
 0:\2007\07600\001\Phase 2\07600-01-C-55PP16

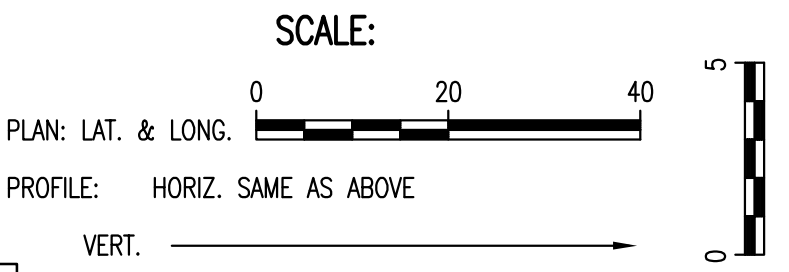
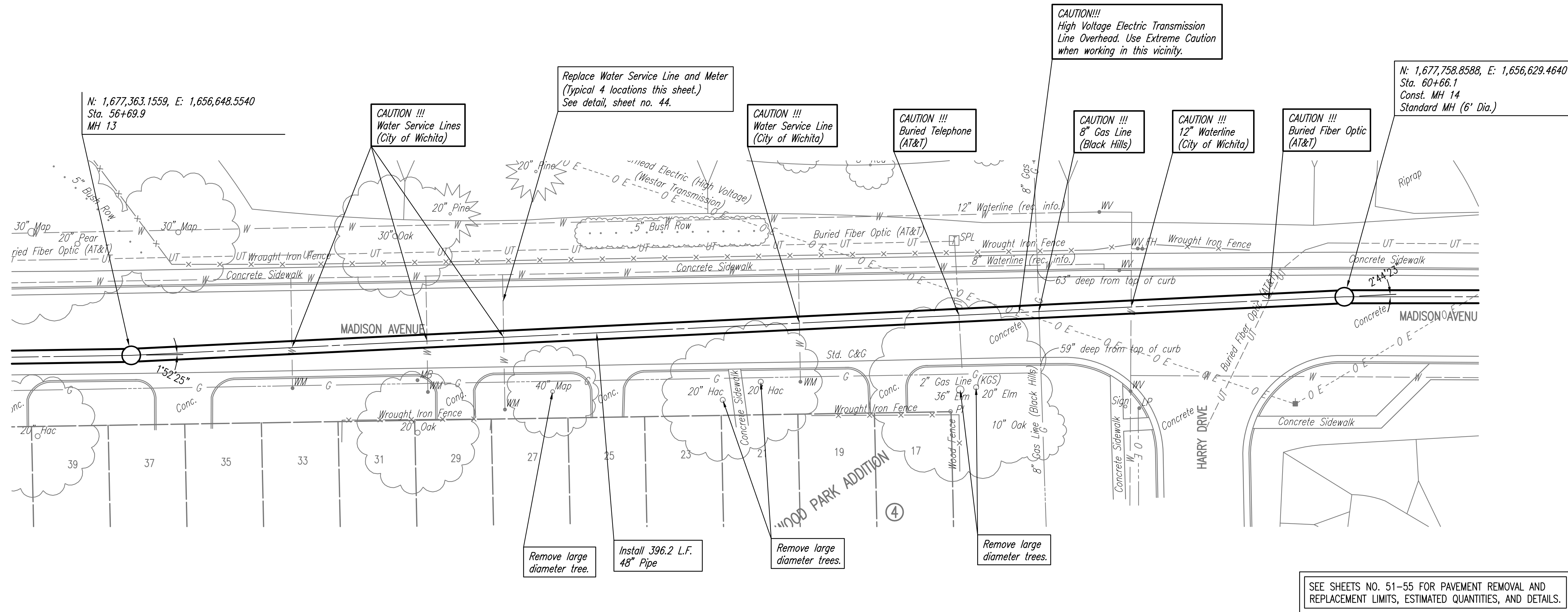

SANITARY SEWER LINE NO. 1



SEE SHEETS NO. 51-55 FOR PAVEMENT REMOVAL AND REPLACEMENT LIMITS, ESTIMATED QUANTITIES, AND DETAILS.

RELOCATION OF SANITARY SEWER NO. 23
 PHASE 2: KELLOGG/GROVE TO PANNEE/1-135
 SANITARY SEWER LINE NO. 1
 JAMES L. ARMOUR, P.E. - CITY ENGINEER
 CITY OF WICHITA PROJECT NO. 468-84375

Professional Engineering Consultants, P.A.
 603 S. TOPICKA AVENUE, WICHITA, KANSAS 67202
 316-262-2691 • FAX 316-262-3003

Job No. 55-07600-001 Date AUGUST 2008
 Designed By MDK, EJB
 Drawn By CSL, JAN

Sheet 20 of 75