

BY	DATE

PHASE I GEOMETRY

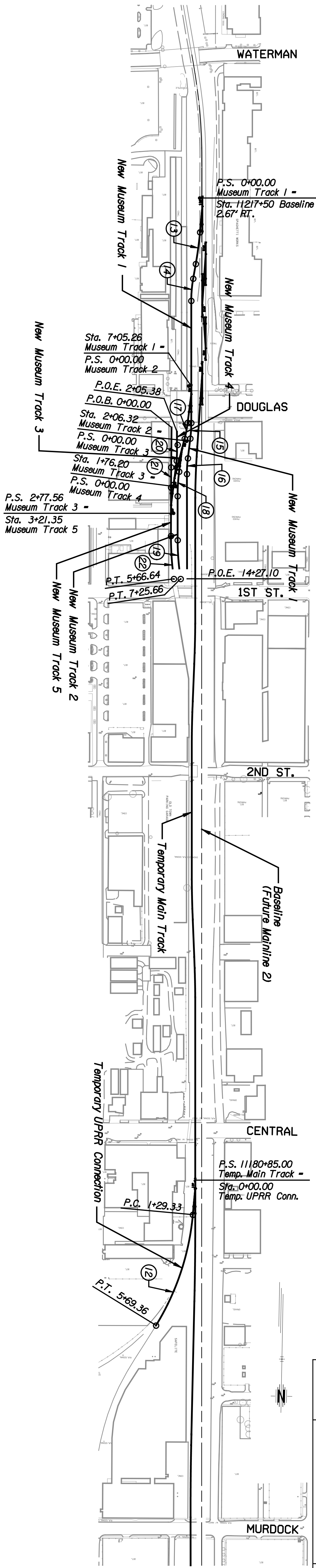

CURVE NUMBER	STATION	NORTHING	EASTING	TANGENT BEARING	DELTA	LENGTH (FT.)	TANGENT (FT.)	RADIUS (FT.)	DEGREE OF CURVE	S.E.	DESIGN SPEED (MPH)
Temporary UPRR Connection											
	P.S. 0+00.00	1,688,713.101	1,650,996.443	N1°04'08.7"W		31.224					
	P.I. 0+31.224	1,688,744.319	1,650,995.861								
	P.I. 0+31.224	1,688,744.319	1,650,995.861	N4°08'07.9"E		98.107					
	P.C. 1+29.331	1,688,842.171	1,651,002.936								
	P.C. 1+29.331	1,688,842.171	1,651,002.936	N4°08'07.9"E		440.028	224.094	955.366	6'00"00.0"		20
	P.T. 3+53.425	1,689,065.681	1,651,019.096								
	P.T. 3+53.425	1,689,065.681	1,651,019.096	N3°32'14.1"E							
	P.T. 5+69.359	1,689,258.693	1,651,132.958								
	P.T. 5+69.359	1,689,258.693	1,651,132.958	N1°03'33.6"W		31.250					
	P.T. 0+00.000	1,685,072.255	1,651,037.718								
	P.I. 0+31.250	1,685,072.255	1,651,037.718								
	P.I. 0+31.250	1,685,072.255	1,651,037.718	N4°08'36.3"E		96.640					
	P.C. 1+27.890	1,685,168.643	1,651,044.700								
	P.C. 1+27.890	1,685,168.643	1,651,044.700	N4°08'36.3"E		119.686	59.890	1,432.685	4'00"00.0"		10
	P.I. 1+47.781	1,685,228.376	1,651,049.028								
	P.I. 1+47.781	1,685,228.376	1,651,049.028	N8°55'51.1"E		55.682					
	P.T. 2+47.577	1,685,287.540	1,651,058.325								
	P.T. 2+47.577	1,685,287.540	1,651,058.325	N8°55'51.1"E		83.333	41.849	478.339	12'00"00.0"		10
	P.C. 3+03.258	1,685,342.547	1,651,066.969								
	P.C. 3+03.258	1,685,342.547	1,651,066.969	N8°55'51.1"E		456.516					
	P.I. 3+45.107	1,685,383.889	1,651,073.466								
	P.I. 3+45.107	1,685,383.889	1,651,073.466	N1°04'08.8"W		83.333	41.849	478.339	12'00"00.0"		10
	P.T. 3+86.591	1,685,425.730	1,651,072.685								
	P.T. 3+86.591	1,685,425.730	1,651,072.685	N1°04'08.8"W		456.516					
	P.C. 8+43.108	1,685,882.167	1,651,064.167								
	P.C. 8+43.108	1,685,882.167	1,651,064.167	N1°04'08.8"W		58.333	29.256	478.339	12'00"00.0"		10
	P.I. 8+72.364	1,685,911.419	1,651,063.621								
	P.I. 8+72.364	1,685,911.419	1,651,063.621	N5°55'51.1"E		74.433					
	P.T. 9+01.441	1,685,940.518	1,651,066.645								
	P.T. 9+01.441	1,685,940.518	1,651,066.645	N5°55'51.1"E		58.333	29.256	478.339	12'00"00.0"		10
	P.C. 9+75.874	1,686,014.553	1,651,074.336								
	P.C. 9+75.874	1,686,014.553	1,651,074.336	N5°55'51.1"E		58.332	29.507	478.339	12'00"00.0"		10
	P.I. 10+05.381	1,686,043.902	1,651,077.384								
	P.I. 10+05.381	1,686,043.902	1,651,077.384	N1°07'44.4"W		353.395					
	P.T. 10+34.706	1,686,073.404	1,651,076.803								
	P.T. 10+34.706	1,686,073.404	1,651,076.803	N1°07'44.4"W							
	P.O.E. 13+88.101	1,686,426.730	1,651,069.840								

BASELINE GEOMETRY

CURVE NUMBER	STATION	NORTHING	EASTING	TANGENT BEARING	DELTA	LENGTH (FT.)	TANGENT (FT.)	RADIUS (FT.)	DEGREE OF CURVE	S.E.	DESIGN SPEED (MPH)
New Museum Track 2											
	P.O.B. 0+00.000	1,685,744.331	1,651,066.740	N1°04'08.4"W		30.762					
	P.I. 0+30.762	1,685,775.088	1,651,066.166								
	P.I. 0+30.762	1,685,775.088	1,651,066.166	N6°05'12.0"E		107.119					
	P.C. 1+37.881	1,685,881.603	1,651,077.524								
	P.C. 1+37.881	1,685,881.603	1,651,077.524	N6°05'12.0"E		60.696	30.444	478.339	12'00"00.0"		10
	P.I. 1+68.325	1,685,911.876	1,651,080.752								
	P.I. 1+68.325	1,685,911.876	1,651,080.752	N1°32'21.2"E		38.503					
	P.T. 1+98.577	1,685,941.495	1,651,087.792								
	P.T. 1+98.577	1,685,941.495	1,651,087.792	N1°32'21.2"E		86.726					
	P.C. 2+37.079	1,685,978.954	1,651,096.695								
	P.C. 2+37.079	1,685,978.954	1,651,096.695	N6°13'01.6"E		91.826	46.014	716.779	8'00"00.0"		10
	P.I. 3+69.819	1,686,110.913	1,651,111.071								
	P.I. 3+69.819	1,686,110.913	1,651,111.071	N1°07'44.4"W		164.598					
	P.T. 4+15.631	1,686,156.918	1,651,110.164								
	P.T. 4+15.631	1,686,156.918	1,651,110.164	N1°07'44.4"W		106.445	53.302	955.366	6'00"00.0"		10
	P.C. 5+80.229	1,686,321.483	1,651,106.921								
	P.C. 5+80.229	1,686,321.483	1,651,106.921	N1°07'44.4"W		145.435					
	P.I. 6+33.531	1,686,374.775	1,651,105.871								
	P.I. 6+33.531	1,686,374.775	1,651,105.871	N7°30'56.6"W		101.363					
	P.T. 6+86.674	1,686,427.619	1,651,098.899								
	P.T. 6+86.674	1,686,427.619	1,651,098.899	N7°30'56.6"W		30.762					
New Museum Track 3											
	P.S. 0+00.000	1,685,949.026	1,651,089.582	N1°32'21.2"E							
	P.I. 1+45.435	1,686,090.519	1,651,123.212								
	P.I. 1+45.435	1,686,090.519	1,651,123.212	N6°13'01.6"E		101.363					
	P.C. 1+45.435	1,686,090.519	1,651,123.212								
	P.C. 1+45.435	1,686,090.519	1,651,123.212	N6°13'01.6"E		30.762					
	P.I. 2+46.798	1,686,191.286	1,651,134.190								
	P.I. 2+46.798	1,686,191.286	1,651,134.190	N0°56'08.4"W							
	P.T. 2+77.560	1,686,222.044	1,651,133.687								

Note: P.S. equals Point of Switch

NOTES:

- For New Museum Tracks 4 and 5 alignment data, see Baseline Geometry Sheet No. R1.4.

This sheet designed by:



ARCHITECTS ENGINEERS PLANNERS

STATE	PROJECT NO.	YEAR	SHEET NO.	TOTAL SHEETS
KANSAS	472-84071	2005	R1.3	

SHEET NO. OF		SCALE		APP'D.	
DESIGNED	REP.	DETAILED	JOB	QUANTITIES	TRACED
CHK.	CHK.	CHK.	CHK.	CHK.	CHK.
DATE	DATE	DATE	DATE	DATE	DATE
CITY OF WICHITA					
WICHITA CENTRAL CORRIDOR					
PHASE I - TRACK WORK					
GEOMETRIC LAYOUT AND BASELINE GEOMETRY					
SHEET 2 OF 3					