

DATE	BY

# PHASE I GEOMETRY

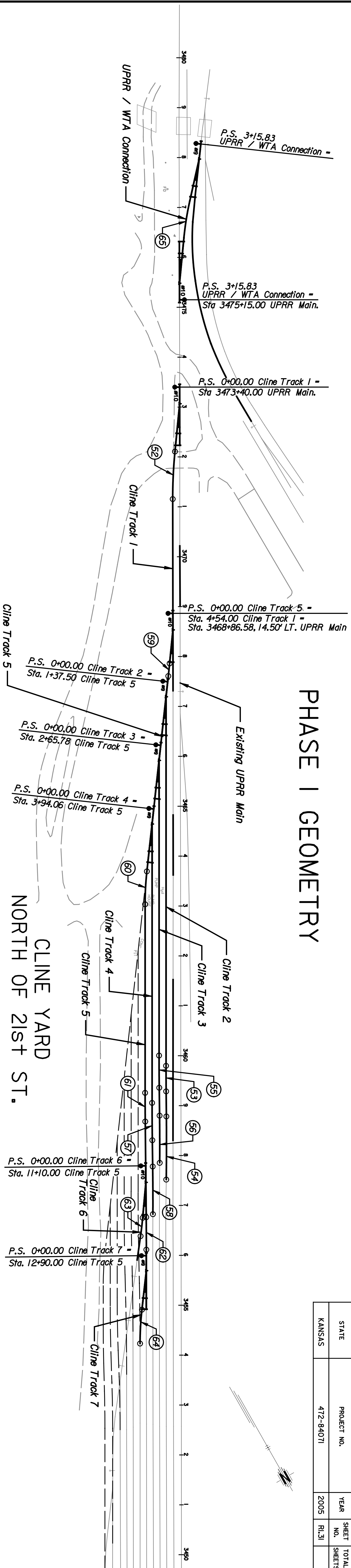

BASELINE GEOMETRY										
CURVE NUMBER	STATION	NORTHING	EASTING	TANGENT BEARING	DELTA	LENGTH (FT.)	TANGENT (FT.)	RADIUS (FT.)	DEGREE OF CURVE	S.E. DESIGN SPEED (MPH)
52	<b>Cline Track 1</b>									
	P.S. 0+00.000	1,700,999.944	1,651,976.317	N293°31'31.0"E		33.180				
	P.L. 0+33.180	1,701,028.815	1,651,992.669							
	P.C. 1+29.145	1,701,028.815	1,651,992.669	N35°50'1.5"E		95.965				
	P.T. 2+24.516	1,701,107.184	1,652,048.055							
53	<b>Cline Track 2</b>									
	P.S. 0+00.000	1,701,501.303	1,652,289.035	N35°53'22.8"E		30.168				
	P.L. 0+30.168	1,701,525.744	1,652,306.720							
	P.C. 7+69.449	1,701,525.744	1,652,306.720	N29°37'23.2"E		739.282				
	P.T. 2+24.516	1,701,187.721	1,652,099.145							
54	<b>Cline Track 3</b>									
	P.S. 0+00.000	1,701,187.721	1,652,099.145	N29°31'41.3"E		384.530				
	P.L. 0+30.168	1,701,525.744	1,652,306.720							
	P.C. 7+69.449	1,702,168.398	1,652,672.142	N29°37'23.2"E		51.239				
	P.T. 8+20.688	1,702,213.052	1,652,697.269							
55	<b>Cline Track 4</b>									
	P.S. 0+00.000	1,702,213.052	1,652,697.269	N29°06'38.6"E		50.236				
	P.L. 0+30.168	1,702,256.943	1,652,721.709							
	P.C. 8+70.925	1,702,312.221	1,652,752.490	N29°06'38.6"E		126.533				
	P.T. 9+97.457	1,702,366.805	1,652,784.484							
56	<b>Cline Track 5</b>									
	P.S. 0+00.000	1,702,366.805	1,652,784.484	N30°22'33.8"E		10				
	P.L. 0+30.168	1,702,709.155	1,652,439.432							
	P.C. 7+41.767	1,702,248.746	1,652,732.792	N28°58'40.6"E		94.586				
	P.T. 8+36.352	1,702,331.109	1,652,779.297							
57	<b>Cline Track 6</b>									
	P.S. 0+00.000	1,701,709.155	1,652,439.432	N35°53'22.8"E		30.168				
	P.L. 0+30.168	1,701,733.595	1,652,457.117							
	P.C. 5+88.768	1,702,219.184	1,652,733.229	N29°37'23.2"E		558.600				
	P.T. 6+26.164	1,702,251.692	1,652,751.714							
58	<b>Cline Track 7</b>									
	P.S. 0+00.000	1,702,251.692	1,652,751.714	N28°52'30.8"E		74.790				
	P.L. 0+30.168	1,702,284.439	1,652,769.772							
	P.C. 7+46.253	1,702,330.582	1,652,795.219	N28°52'30.8"E		52.695				
	P.T. 7+64.014	1,702,372.405	1,652,818.283							
59	<b>Cline Track 8</b>									
	P.S. 0+00.000	1,702,413.837	1,652,842.040	N29°49'49.4"E		95.518				
	P.L. 0+30.168	1,702,756.199	1,652,457.117							
	P.C. 7+41.767	1,702,248.746	1,652,732.792	N28°58'40.6"E		47.294				
	P.T. 8+36.352	1,702,331.109	1,652,779.297							

BASELINE GEOMETRY										
CURVE NUMBER	STATION	NORTHING	EASTING	TANGENT BEARING	DELTA	LENGTH (FT.)	TANGENT (FT.)	RADIUS (FT.)	DEGREE OF CURVE	S.E. DESIGN SPEED (MPH)
52	<b>Cline Track 3</b>									
	P.S. 0+00.000	1,701,605.229	1,652,364.233	N35°53'22.8"E		30.180				
	P.L. 0+30.168	1,701,629.669	1,652,381.919							
	P.C. 6+21.349	1,702,143.580	1,652,674.135	N29°37'23.2"E		591.181				
	P.T. 6+53.610	1,702,171.625	1,652,690.081							
53	<b>Cline Track 4</b>									
	P.S. 0+00.000	1,702,171.625	1,652,690.081	N28°58'40.5"E		64.521				
	P.L. 0+30.168	1,702,199.847	1,652,705.711							
	P.C. 6+85.869	1,702,199.847	1,652,705.711	N28°58'40.5"E		55.897				
	P.T. 7+41.767	1,702,248.746	1,652,732.792							
54	<b>Cline Track 5</b>									
	P.S. 0+00.000	1,702,248.746	1,652,732.792	N28°58'40.6"E		94.586				
	P.L. 0+30.168	1,702,280.120	1,652,755.705							
	P.C. 7+49.061	1,702,290.120	1,652,755.705	N29°55'25.6"E		558.600				
	P.T. 8+36.352	1,702,331.109	1,652,779.297							
55	<b>Cline Track 6</b>									
	P.S. 0+00.000	1,701,709.155	1,652,439.432	N35°53'22.8"E		30.168				
	P.L. 0+30.168	1,701,733.595	1,652,457.117							
	P.C. 5+88.768	1,702,219.184	1,652,733.229	N29°37'23.2"E		558.600				
	P.T. 6+26.164	1,702,251.692	1,652,751.714							
56	<b>Cline Track 7</b>									
	P.S. 0+00.000	1,702,251.692	1,652,751.714	N28°52'30.8"E		74.790				
	P.L. 0+30.168	1,702,284.439	1,652,769.772							
	P.C. 7+46.253	1,702,330.582	1,652,795.219	N28°52'30.8"E		52.695				
	P.T. 7+64.014	1,702,372.405	1,652,818.283							
57	<b>Cline Track 8</b>									
	P.S. 0+00.000	1,702,413.837	1,652,842.040	N29°49'49.4"E		95.518				
	P.L. 0+30.168	1,702,756.199	1,652,457.117							
	P.C. 7+41.767	1,702,248.746	1,652,732.792	N28°58'40.6"E		47.294				
	P.T. 8+36.352	1,702,331.109	1,652,779.297							

Note: P.S. equals Point of Switch

### NOTES:

- For Cline Tracks 5, 6 & 7, and UPRR / WTA Connection alignment data, see Baseline Geometry Sheet No. R1.32.

This sheet designed by:



ARCHITECTS ENGINEERS PLANNERS

STATE	PROJECT NO.	YEAR	SHEET NO.	TOTAL SHEETS
KANSAS	472-84071	2005	R1.31	

SHEET NO.		OF	SCALE	APPD.	TRACED
DESIGNED	REP	DATE	DETAILS	QUANTITIES	TRACE
CHKD	CHKD	DATE	DATE	DATE	DATE
DESIGN	REP	DATE	DETAILS	QUANTITIES	TRACE
CHKD	CHKD	DATE	DATE	DATE	DATE

CITY OF WICHITA	
WICHITA CENTRAL CORRIDOR	
PHASE I - TRACK WORK	
GEOMETRIC LAYOUT AND BASELINE GEOMETRY	
SHEET 1 OF 2	