

STATE	PROJECT NO.	YEAR	SHEET NO.	TOTAL SHEETS
KANSAS	472-84071	2005	S3.5	

** For Information Only - Bid Item "Street Signage & Marking" is Paid as Lump Sum. **

Summary of Pavement Marking Quantities for 2nd Street		
Items	Total	Units
Pavement Marking (Thermoplastic White) (6")	120.50	L.F.

Note: All existing marking which conflict with the proposed plan shall be removed by grinding or other mechanical means (painting over existing marking will not be allowed). This work shall be considered subsidiary to the bid item "Street Signage & Marking". Unless otherwise noted dimensions are from ℓ Stripe to ℓ Stripe.

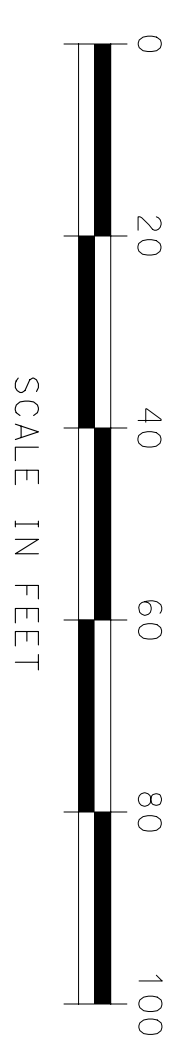
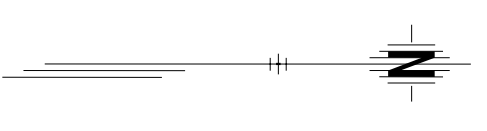
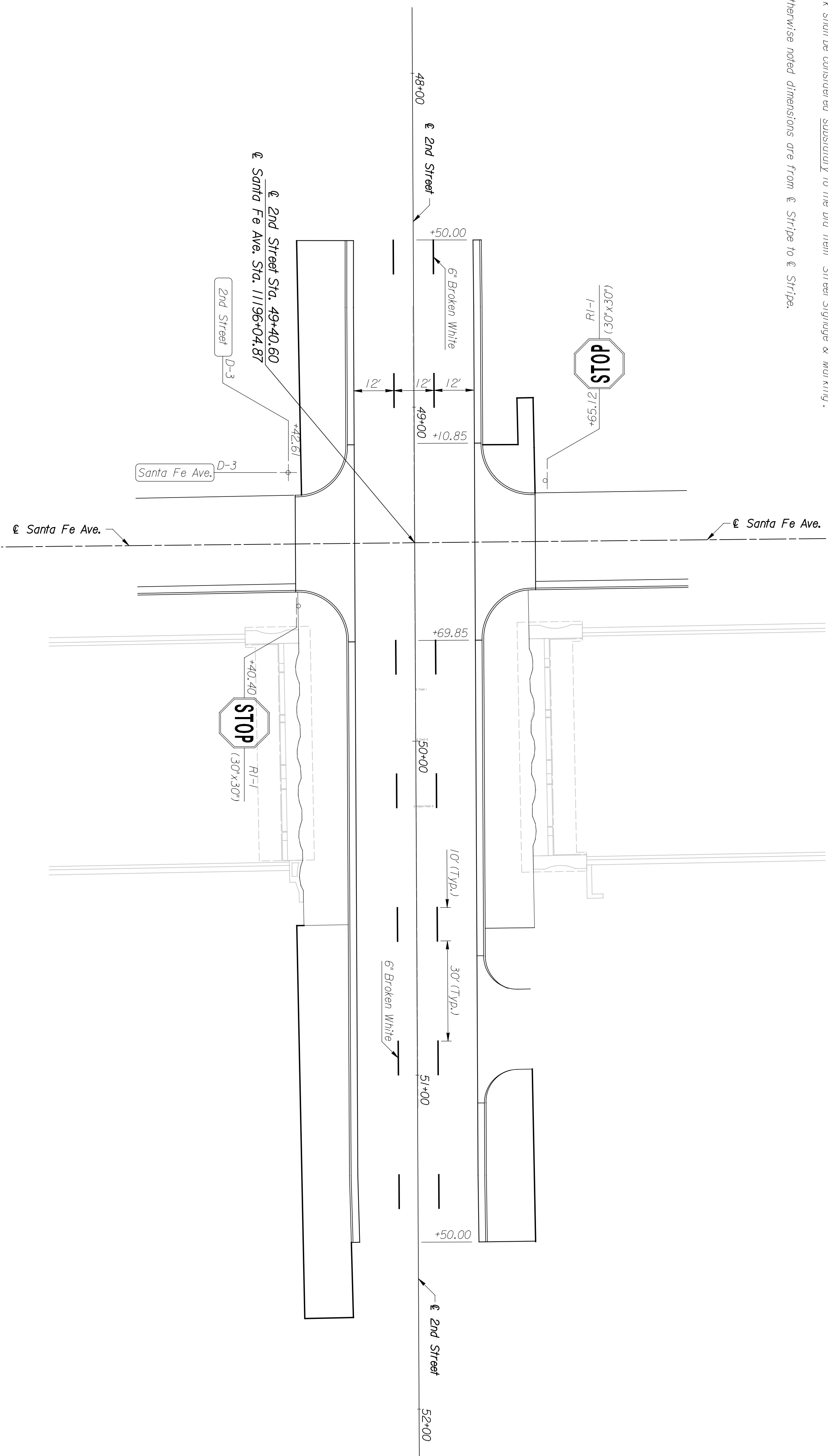

SHEET NO.	OF	SCALE	APP'D.	QUANTITIES	TRACED
DESIGNED	AWD	DETAILED	AWD	QUANTITIES	TRACED
DRAWN	DKS	DETAILED	DKS	QUANTITIES	TRACED

CITY OF WICHITA
WICHITA CENTRAL CORRIDOR
SIGNING & MARKING PLAN
2ND STREET

	BY	DATE

This sheet designed by:
PNTB
 ARCHITECTS ENGINEERS PLANNERS