

DATE	
BY	

Sta. 0+00.00 SWS Line No. 600 =
Sta. 52+45.28 @ 13th St., 3.57' Lt.
Construct Manhole, Reinforced Concrete
L=4'-0" W=6'-0" H=6'-0" H₁=1'-0"
Top Elev.=1304.04 Floor Elev.=1297.54
Connect to Existing 48" Brick Arch (E)
Connect to Existing 15" RCP (N)
Install 71.2 L.F. x SWS Pipe RCP 48" (W)
Remove Existing Manhole &
119.0 L.F. of Brick Arch (W) See Note 1
See Sh. No. S10.3 for Water Line Const.
in Brick Arch
15" RCP [In=1300.64 (N) (Match Existing)
48" RCP [In=1298.24 (E) (Match Existing)
48" RCP [Out=1298.24 (W)
See Sh. No. S6.7, S6.8

Sta. 0+71.23 SWS Line No. 600 =
Sta. 51+75.00 @ 13th St., 8.00' Rt.
Construct Manhole, Reinforced Concrete
L=4'-0" W=6'-0" H=6'-0" H₁=1'-0"
Top Elev.=1304.05 Floor Elev.=1297.55
Install 229.0 L.F. x SWS Pipe RCP 48" (W)
Install 72.0 L.F. Steel Casing Bore & Jack (W)
(Min. I.D. 66") (See Note 2)
Sta. 51+05 @ 13th St. to 50+33 @ 13th St.
48" RCP [In=1298.28 (E)
48" RCP [Out=1298.28 (W)
See Sh. No. S6.7, S6.8

Sta. 3+00.23 SWS Line No. 600 =
Sta. 0+00.00 SWS Line No. 650 =
Sta. 49+06.00 @ 13th St., 8.00' Rt.
Construct Manhole, Reinforced Concrete
L=4'-0" W=6'-0" H=6'-0" H₁=1'-0"
Top Elev.=1304.05 Floor Elev.=1297.55
Install 41.0 L.F. x SWS Pipe RCP 48" (W)
Install 83.0 L.F. x SWS Pipe RCP 24" (N)
Remove 83 L.F. of Existing 18" VCP (N)
24" RCP [In=1298.46 (S)
48" RCP [In=1298.41 (E)
48" RCP [Out=1298.41 (W)
See Sh. No. S6.6, S6.8, S8.3

Sta. 0+07.60 SWS Line No. 630 =
Sta. 49+06.00 @ 13th St., 25.00' Rt.
Construct Standard Type I Curb Inlet
L=5'-0" W=3'-0" H=4'-0"
Top Elev.=1304.03 Floor Elev.=1300.63
15" RCP [Out=1300.90 (N)
See Sh. No. S6.6, S8.3

Install 8.1 L.F. Excavatable
Flowable Fill to Elev. 1302.86

Sta. 0+00.00 SWS Line No. 630 =
Sta. 49+06.00 @ 13th St., 17.40' Rt.
Construct Manhole, Reinforced Concrete
Over Existing 54" RCP
L=4'-0" W=7'-0" H=7'-0" H₁=1'-0"
Top Elev.=1303.71 Floor Elev.=1296.21
Install 8.1 L.F. x SWS Pipe RCP 15" (S)
Remove 3.0 L.F. of Existing 54" RCP
15" RCP [In=1300.43 (S)
54" RCP [In=1297.17 (E) (Match Existing)
54" RCP [Out=1296.80 (W) (Match Existing)
See Sh. No. S6.7, S6.8, S8.3

FHWA REGION NO.	STATE	PROJECT NO.	YEAR	SHEET NO.	TOTAL SHEETS
7	KANSAS	472-84071	2005	S8.2	

Sta. 3+41.23 SWS Line No. 600 =
Sta. 0+00.00 SWS Line No. 640 =
Sta. 49+05.00 @ 13th St., 8.00' Rt.
Construct Manhole, Reinforced Concrete
L=4'-0" W=6'-0" H=6'-0" H₁=1'-0"
Top Elev.=1303.87 Floor Elev.=1297.37
Install 124.0 L.F. x SWS Pipe RCP 48" (W)
Install 33.5 L.F. x SWS Pipe RCP 15" (N)
15" RCP [In=1299.80 (N)
48" RCP [In=1298.43 (E)
48" RCP [Out=1298.43 (W)
See Sh. No. S6.7, S6.8, S8.3

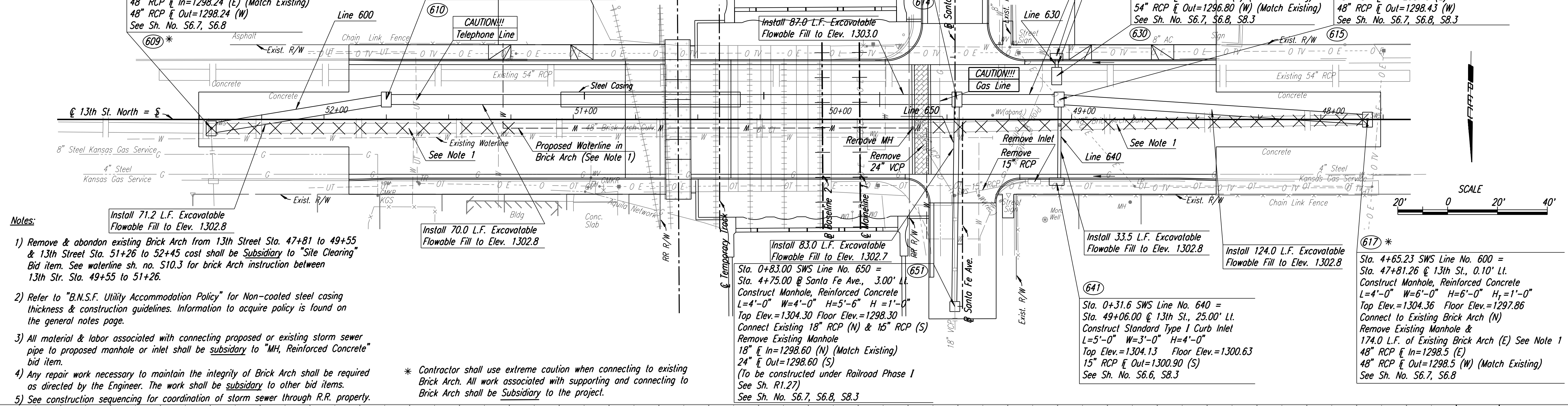

- Notes:
- 1) Remove & abandon existing Brick Arch from 13th Street Sta. 47+81 to 49+55 & 13th Street Sta. 51+26 to 52+45 cost shall be Subsidiary to "Site Clearing" Bid item. See waterline sh. no. S10.3 for brick Arch instruction between 13th Str. Sta. 49+55 to 51+26.
 - 2) Refer to "B.N.S.F. Utility Accommodation Policy" for Non-coated steel casing thickness & construction guidelines. Information to acquire policy is found on the general notes page.
 - 3) All material & labor associated with connecting proposed or existing storm sewer pipe to proposed manhole or inlet shall be subsidiary to "MH, Reinforced Concrete" bid item.
 - 4) Any repair work necessary to maintain the integrity of Brick Arch shall be required as directed by the Engineer. The work shall be subsidiary to other bid items.
 - 5) See construction sequencing for coordination of storm sewer through R.R. property.

* Contractor shall use extreme caution when connecting to existing Brick Arch. All work associated with supporting and connecting to Brick Arch shall be Subsidiary to the project.

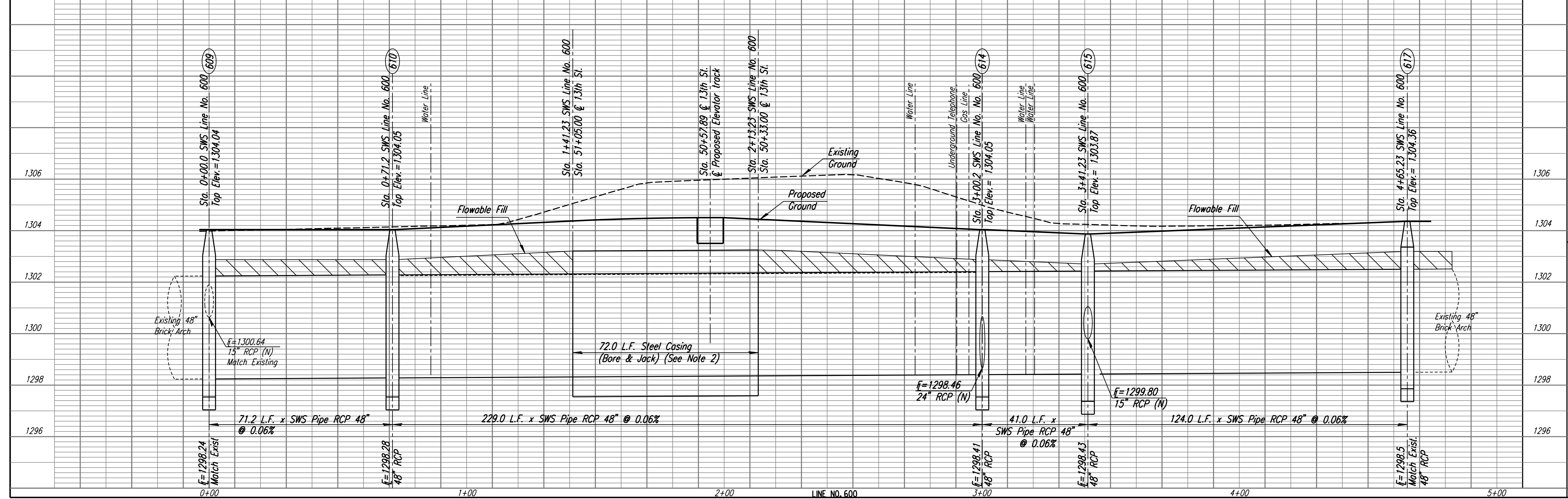

STORM SEWER PLAN
CENTRAL RAIL CORRIDOR
13TH STREET
LINE NO. 600

Professional Engineering Consultants, P.A.
303 S. TORREKA • WICHITA, KANSAS 67202
316-262-2661 • FAX 316-262-3003

Job No. 99188
Date Oct., 2002

Designed by RWM
Drawn by SDM

DSNR: RWM OPER: SDM SCALE: 1/1999/99189/bid set 3/SHEETS/S8.2_SWS_13TH.DGN LAST REV: 12-10-2004

BY: gdr