

	BY	DATE

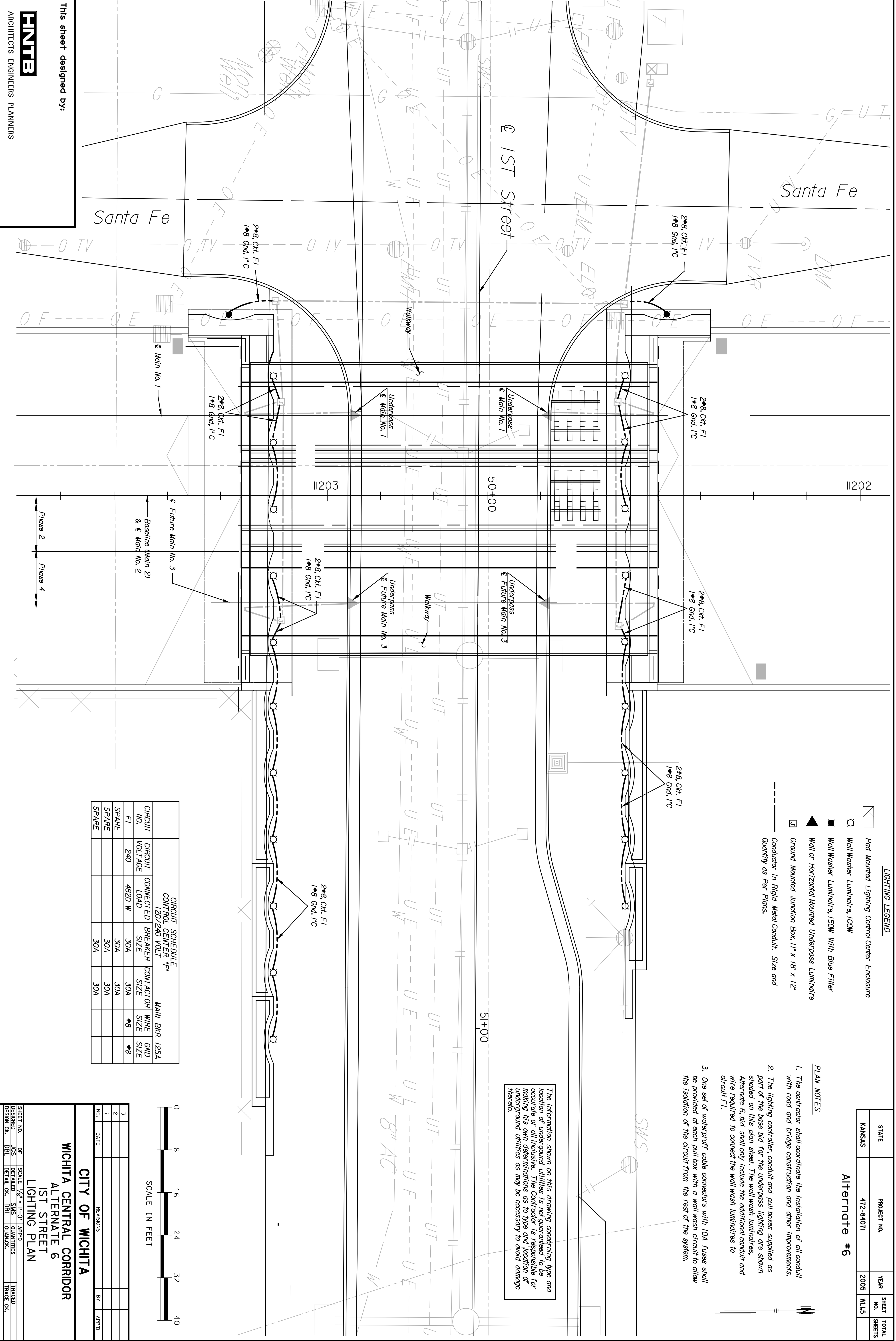

LIGHTING LEGEND

- ☒ Pad Mounted Lighting Control Center Enclosure
- Wall Washer Luminaire, 100W
- Wall Washer Luminaire, 150W with Blue Filter
- ▲ Wall or Horizontal Mounted Underpass Luminaire
- ☑ Ground Mounted Junction Box, 1' x 18" x 12" Quantity as Per Plans.
- Conductor in Rigid Metal Conduit. Size and Quantity as Per Plans.

- PLAN NOTES**
- The contractor shall coordinate the installation of all conduit with road and bridge construction and other improvements.
 - The lighting controller, conduit and pull boxes supplied as part of the base bid for the underpass lighting are shown shaded on this plan sheet. The wall wash luminaires, Alternate 6, did shall only include the additional conduit and wire required to connect the wall wash luminaires to circuit FI.
 - One set of waterproof cable connectors with 10A fuses shall be provided at each pull box with a wall wash circuit to allow the isolation of the circuit from the rest of the system.

The information shown on this drawing concerning type and location of underground utilities is not guaranteed to be accurate or all inclusive. The Contractor is responsible for making his own determinations as to type and location of underground utilities as may be necessary to avoid damage thereto.

CIRCUIT SCHEDULE
 CONTROL CENTER 120/240 VOLT
 MAIN BKR 125A

CIRCUIT NO.	CIRCUIT VOLTAGE	CONNECTED LOAD	BREAKER SIZE	CONDUCTOR SIZE	WIRE SIZE	WIRE GND SIZE
F.I.	240	4820 W	30A	30A	#8	#8
SPARE			30A	30A		
SPARE			30A	30A		
SPARE			30A	30A		

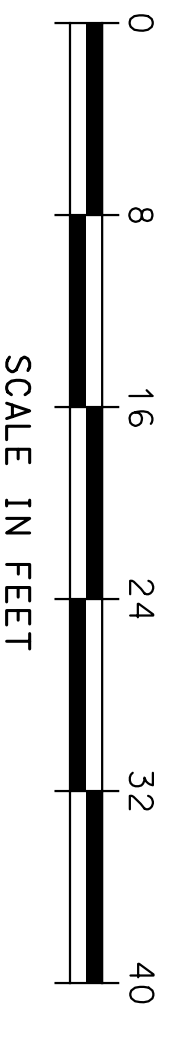

REVISIONS

NO.	DATE	BY	APP'D.
1			
2			
3			

CITY OF WICHITA
WICHITA CENTRAL CORRIDOR
ALTERNATE 6
1ST STREET
LIGHTING PLAN

SHEET NO.	OF	SCALE	DATE	APP'D.	TRACED
DESIGNED	UGS	DETAILS	DATE	QUANTITIES	TRACED
DESIGN CR.	DBL	DETAIL CR.	DBL	QUANTITIES	TRACED CR.

PHNTB
 ARCHITECTS ENGINEERS PLANNERS

This sheet designed by: