

SE 1/4 SEC. 19, T27S, R02E

**NOTE:**  
MH 3-1C Shall Be Lined With Duraplate, Raven, Or Approved Equal.

EXISTING MH 3-1  
N: 513222.17436  
E: 510263.26096  
STA. 50+371.709 LINE 3 =  
STA. 3+335.994 @ NORTH FRONTAGE RD., 13.050 m RT.//  
EXISTING MH, TYPE P (STANDARD), 1.5 m Ø OVER EXISTING SANITARY SEWER. 3+300

STATE	PROJECT NO.	YEAR	SHEET NO.	TOTAL SHEETS
KANSAS	54-87 K-8258-01	2007	136	556

DATE	
BY	
REFERENCE NOTED	
REFERENCE CHECKED	

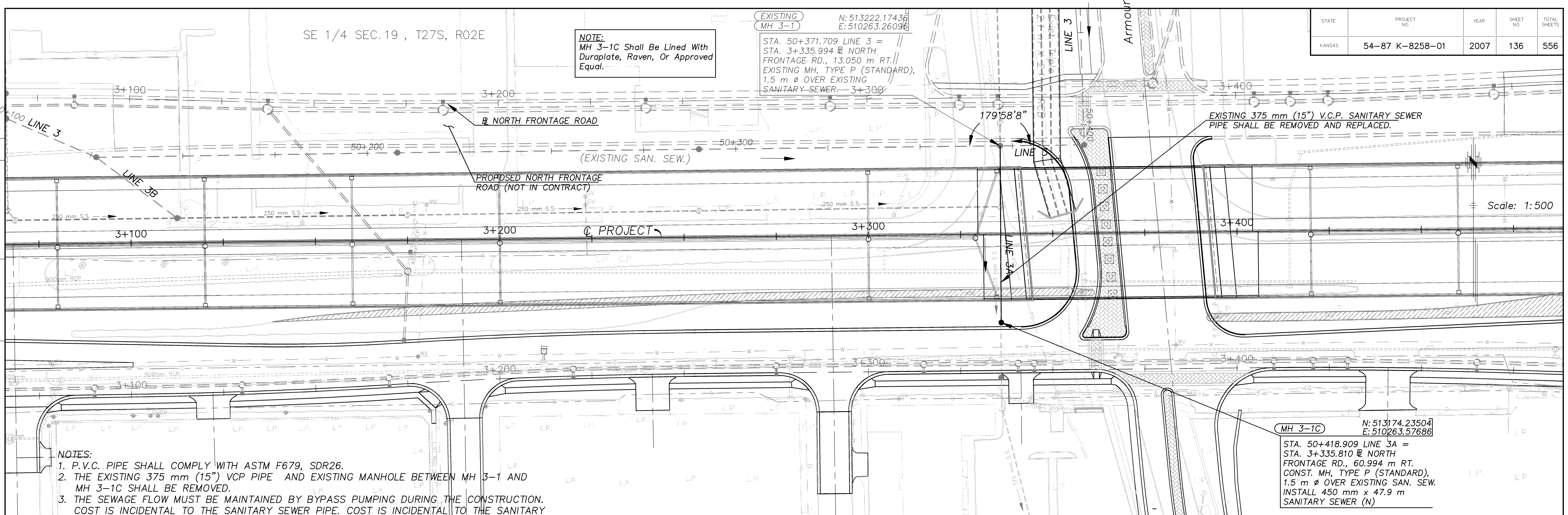

- NOTES:**
- P.V.C. PIPE SHALL COMPLY WITH ASTM F679, SDR26.
  - THE EXISTING 375 mm (15") VCP PIPE AND EXISTING MANHOLE BETWEEN MH 3-1 AND MH 3-1C SHALL BE REMOVED.
  - THE SEWAGE FLOW MUST BE MAINTAINED BY BYPASS PUMPING DURING THE CONSTRUCTION. COST IS INCIDENTAL TO THE SANITARY SEWER PIPE. COST IS INCIDENTAL TO THE SANITARY SEWER PIPE BID ITEM.
  - TRENCH SHALL BE BACKFILLED TO WITHIN 600 mm (2') OF EXISTING GRADE WITH FLOWABLE FILL. REFER TO SECTION 306 OF THE CITY OF WICHITA STANDARD SPECIFICATIONS. COST IS INCIDENTAL TO 450 mm SANITARY SEWER.

EXISTING MH 3-1C  
N: 513174.23504  
E: 510263.57686  
STA. 50+418.909 LINE 3A =  
STA. 3+335.810 @ NORTH FRONTAGE RD., 60.994 m RT.  
CONST. MH, TYPE P (STANDARD), 1.5 m Ø OVER EXISTING SAN. SEW.  
INSTALL 450 mm x 47.9 m SANITARY SEWER (N)

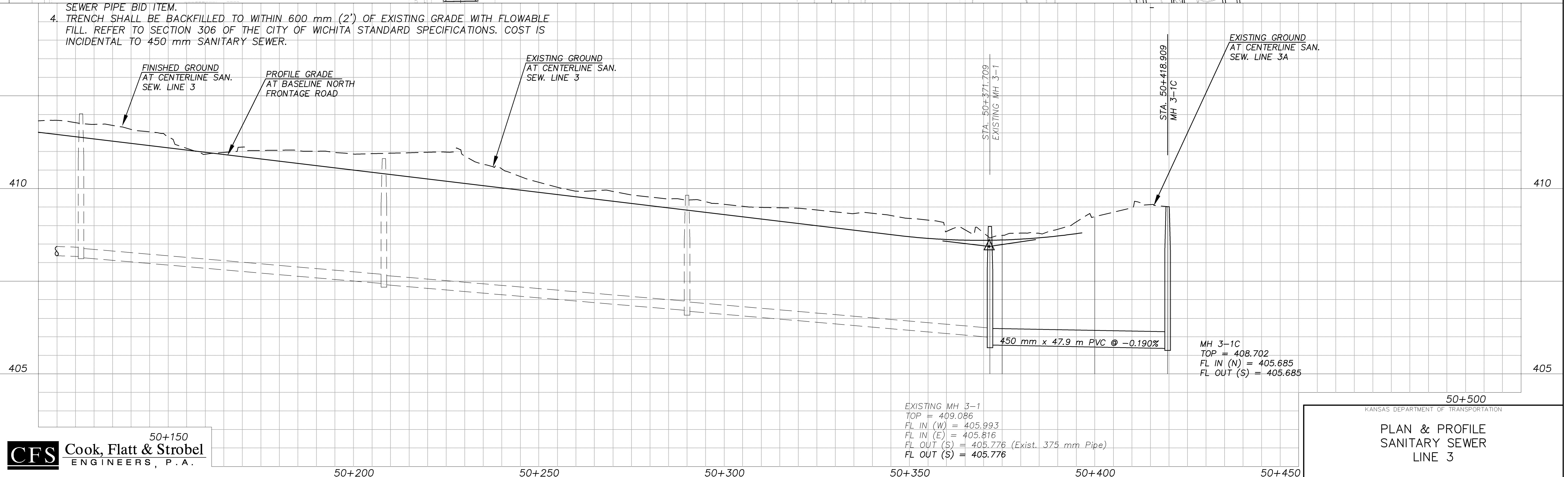

EXISTING MH 3-1  
TOP = 409.086  
FL IN (W) = 405.993  
FL IN (E) = 405.816  
FL OUT (S) = 405.776 (Exist. 375 mm Pipe)  
FL OUT (S) = 405.776

MH 3-1C  
TOP = 408.702  
FL IN (N) = 405.685  
FL OUT (S) = 405.685

50+500  
KANSAS DEPARTMENT OF TRANSPORTATION  
**PLAN & PROFILE  
SANITARY SEWER  
LINE 3**

50+150  
**CFS** Cook, Flatt & Strobel  
ENGINEERS, P.A.