

STATE	PROJECT NO.	YEAR	SHEET NO.	TOTAL SHEETS
KANSAS	54-87 K-8258-01	2007	183	556

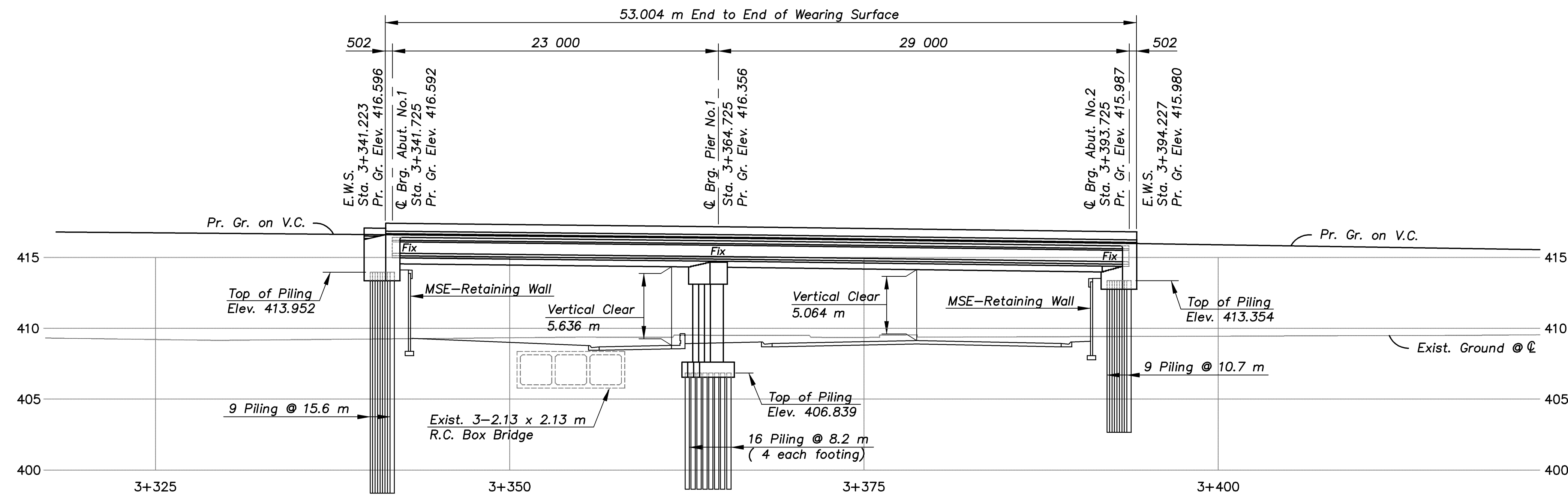

BM # 15~ "□" Cut S.W. cor of Bridge 26.3 m W. & 12.6 m S. of the intersection of Armour Road & Kellogg Avenue 27.6 m Rt. $\text{C.L. Sta. } 49+925.087$ (Armour) Elev. 409.006

ELEVATION
 23-29 m Continuous Concrete Prestressed Beam Spans (K4+75 mm) Pile Bent Abutments and Column Bent Piers 17.1 m Roadway, 4'45"17" Skew Left

BM # 16~ "□" Cut Top of Curb on the E. Curb Line of the Men's Warehouse, 35.0 m N. of C.L. of North Frontage Road 42.9 m Lt. $\text{Sta. } 3+504.400$ (Kellogg) Elev. 410.195

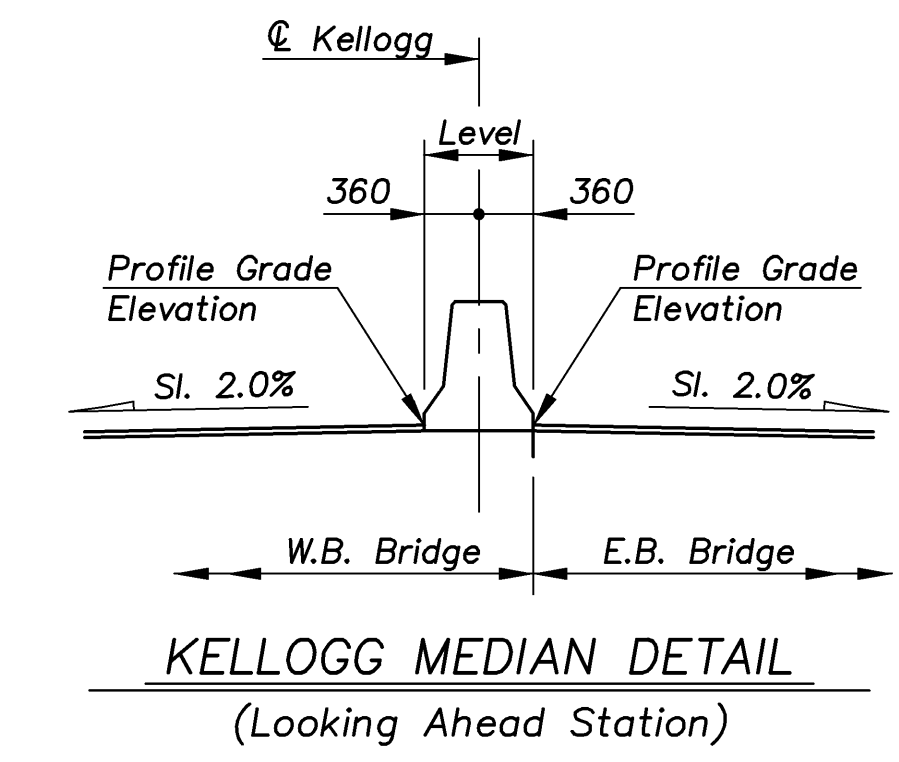
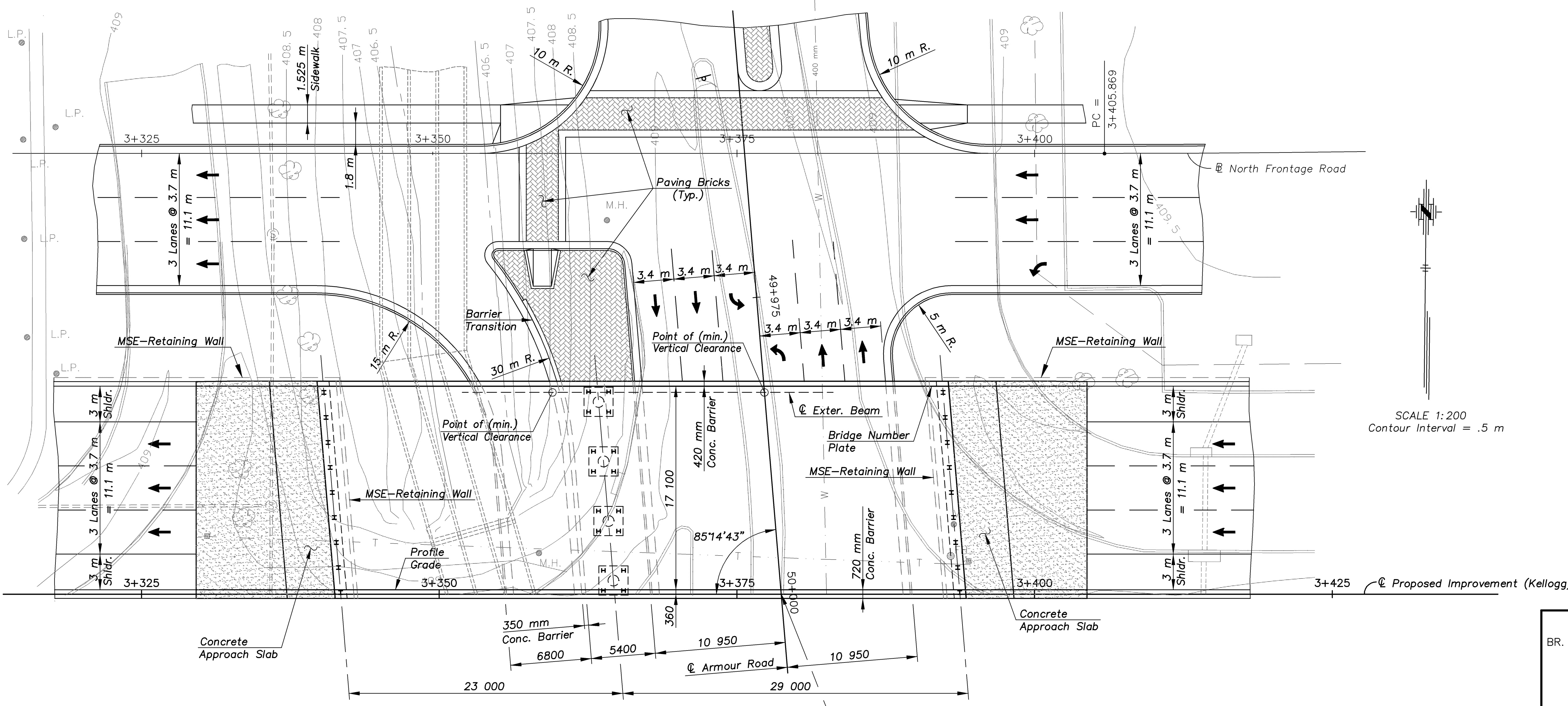
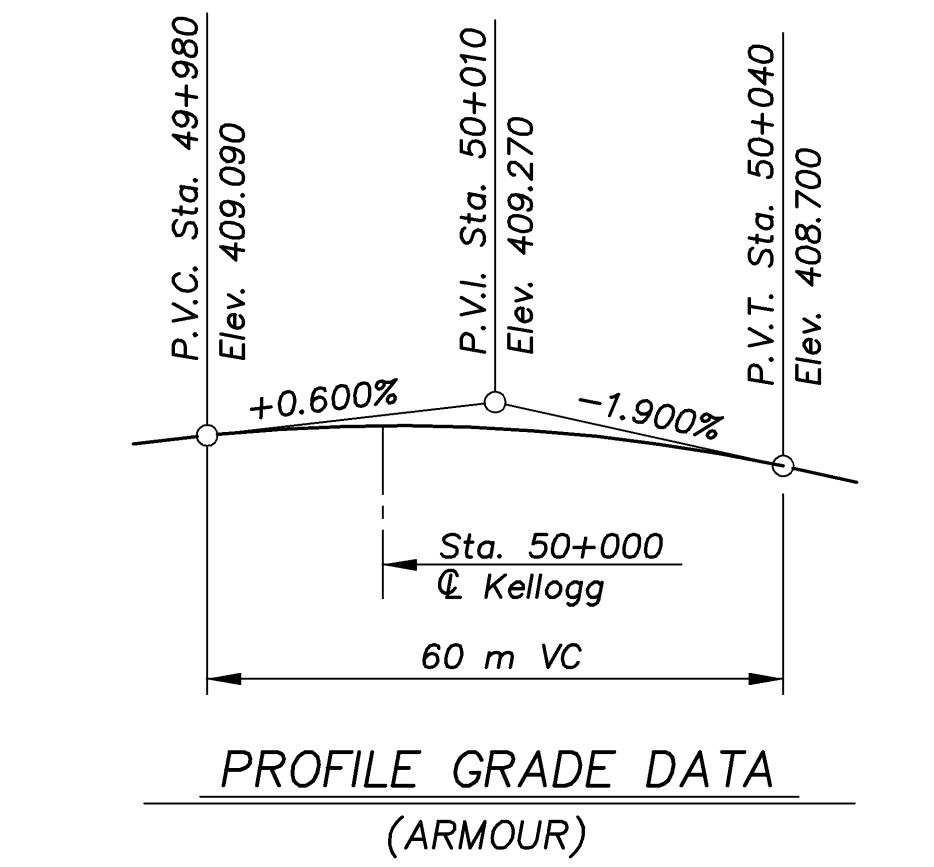
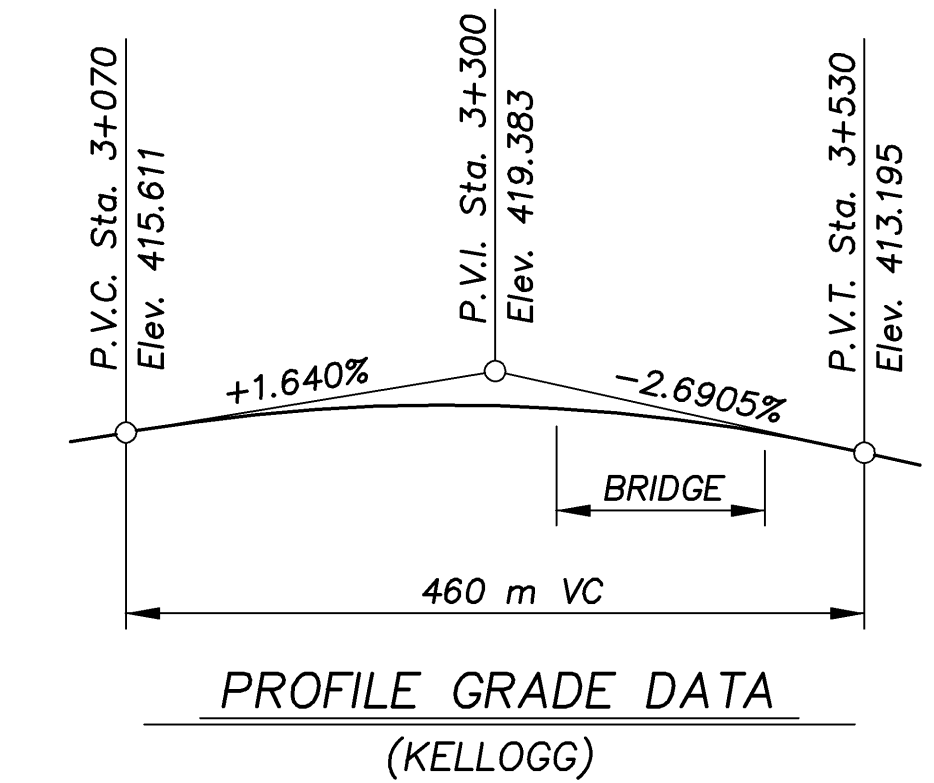

ARMOUR/LAYOUT 1:200

KANSAS DEPARTMENT OF TRANSPORTATION		CFS Cook, Flatt & Strobel ENGINEERS, P. A.
BR. NO. 54-87-30.81(700) W.B. STA. 3+378.725		
CONSTRUCTION LAYOUT		
KELLOGG AVENUE OVER ARMOUR		
DESIGNED R.S.C.	SCALE 1:200	QUANTITIES T.R.G. SHEET 3 OF 39
DETAILED T.R.G.	DATE	
Proj. No. 54-87 K-8258-01 SEDGWICK COUNTY		