

STATE	PROJECT NO.	YEAR	SHEET NO.	TOTAL SHEETS
KANSAS	54-87 K-8258-01	2007	187	556

E.F. INDICATES EACH FACE.
N.F. INDICATES NEAR FACE.
F.F. INDICATES FAR FACE.

** 1680 mm lap (min.) 25 AB1 & AB2 Bars
1200 mm lap (min.) 25 AB3 & AB4 Bars
600 mm lap (min.) 16 AB6 Bars

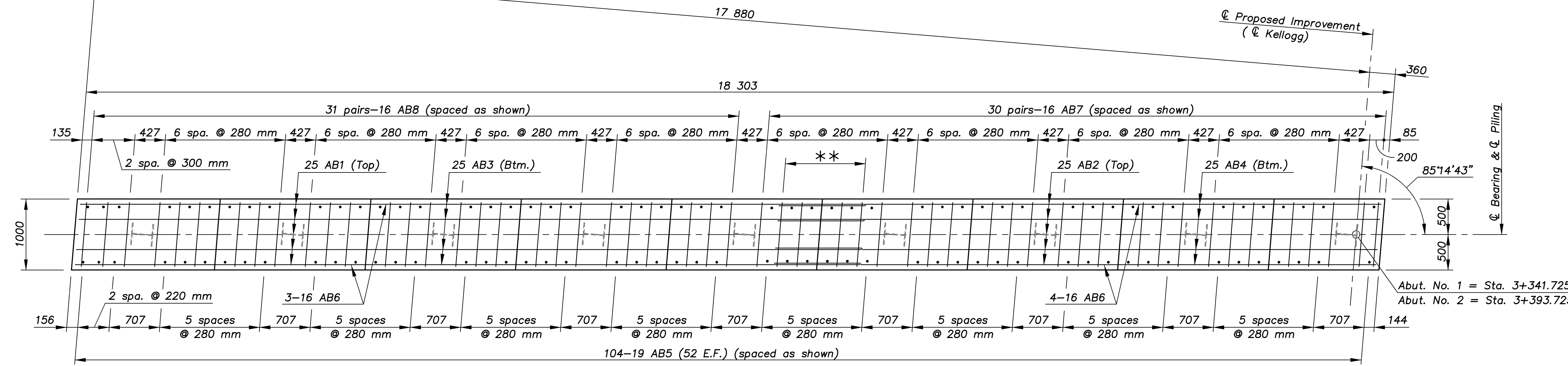

PLAN OF ABUTMENT BEAM

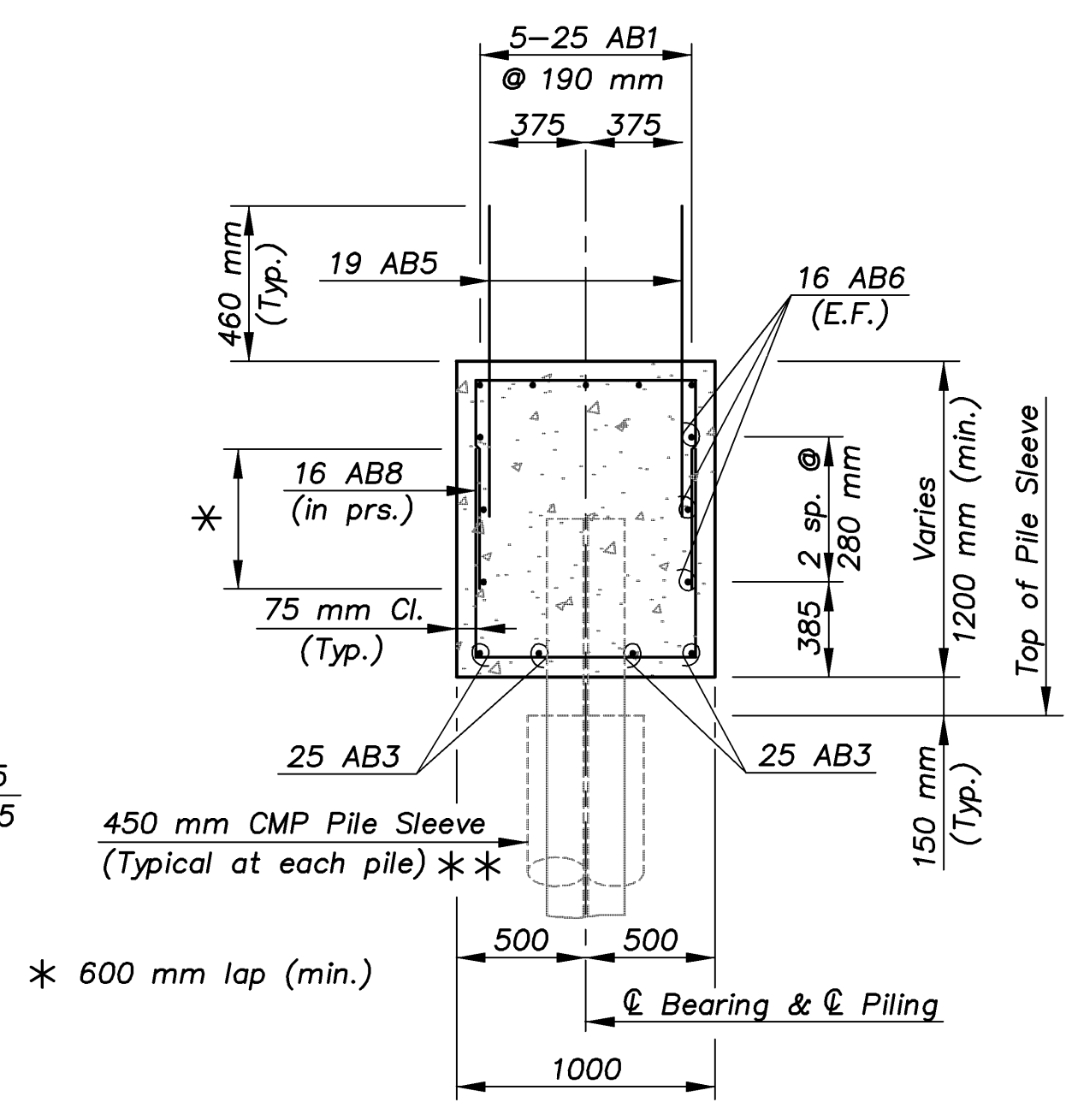

SECTION A-A

TOP OF MASONRY ELEVATIONS									
Location	Elev. "A"	Elev. "B"	Elev. "C"	Elev. "D"	Elev. "E"	Elev. "F"	Elev. "G"	Elev. "H"	Elev. "I"
Abutment No. 1	414.562	414.603	414.643	414.683	414.724	414.764	414.805	414.845	414.881
Abutment No. 2	413.964	414.004	414.043	414.083	414.123	414.162	414.202	414.241	414.276

** Abutment Pile Sleeve shall extend from the bottom of the Mechanically Stabilized Earth Retaining Wall to within 150 mm of the bottom of abutment beam at each pile location. Sleeves to be set prior to placement of Select Granular Backfill. Lateral bracing of the pile sleeves is required during the wall construction. Method of bracing shall be approved by the Engineer. Bracing shall remain in service until the Engineer authorizes its removal. The Abutment Pile Sleeves shall be filled with sand. All material and labor necessary to install and maintain the Abutment Pile Sleeves shall be considered Subsidiary to the bid item "Steel Pile HP310x79".

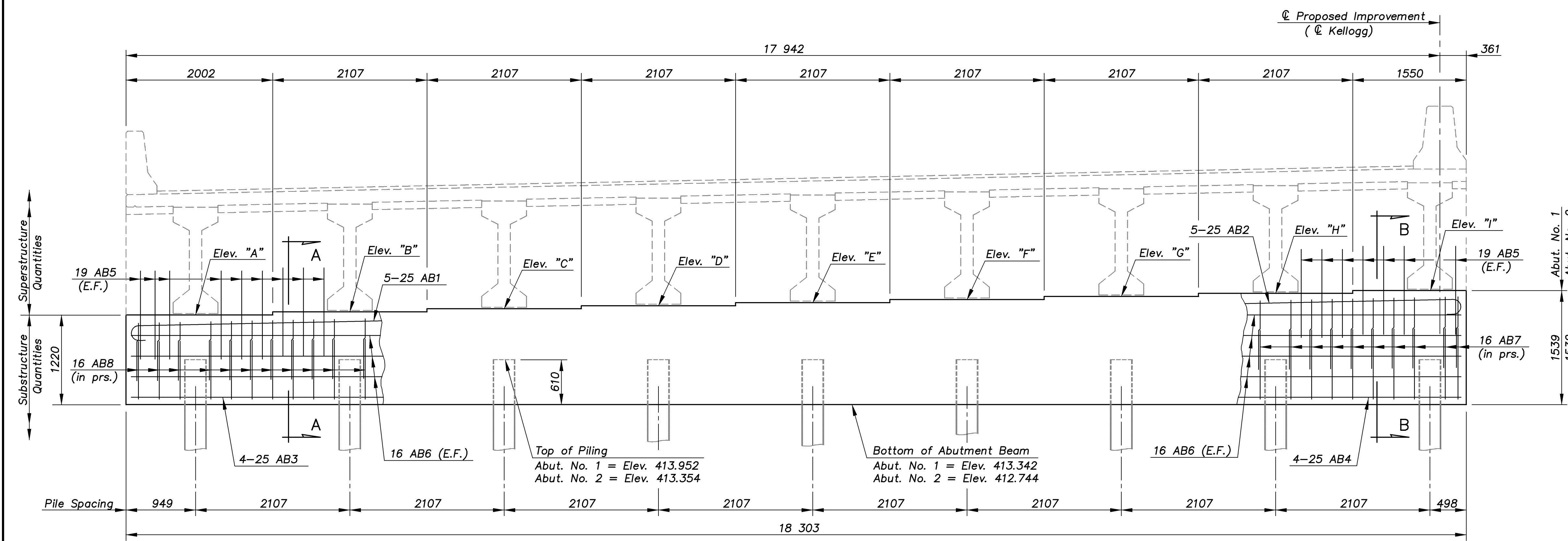

ELEVATION OF ABUTMENT BEAM

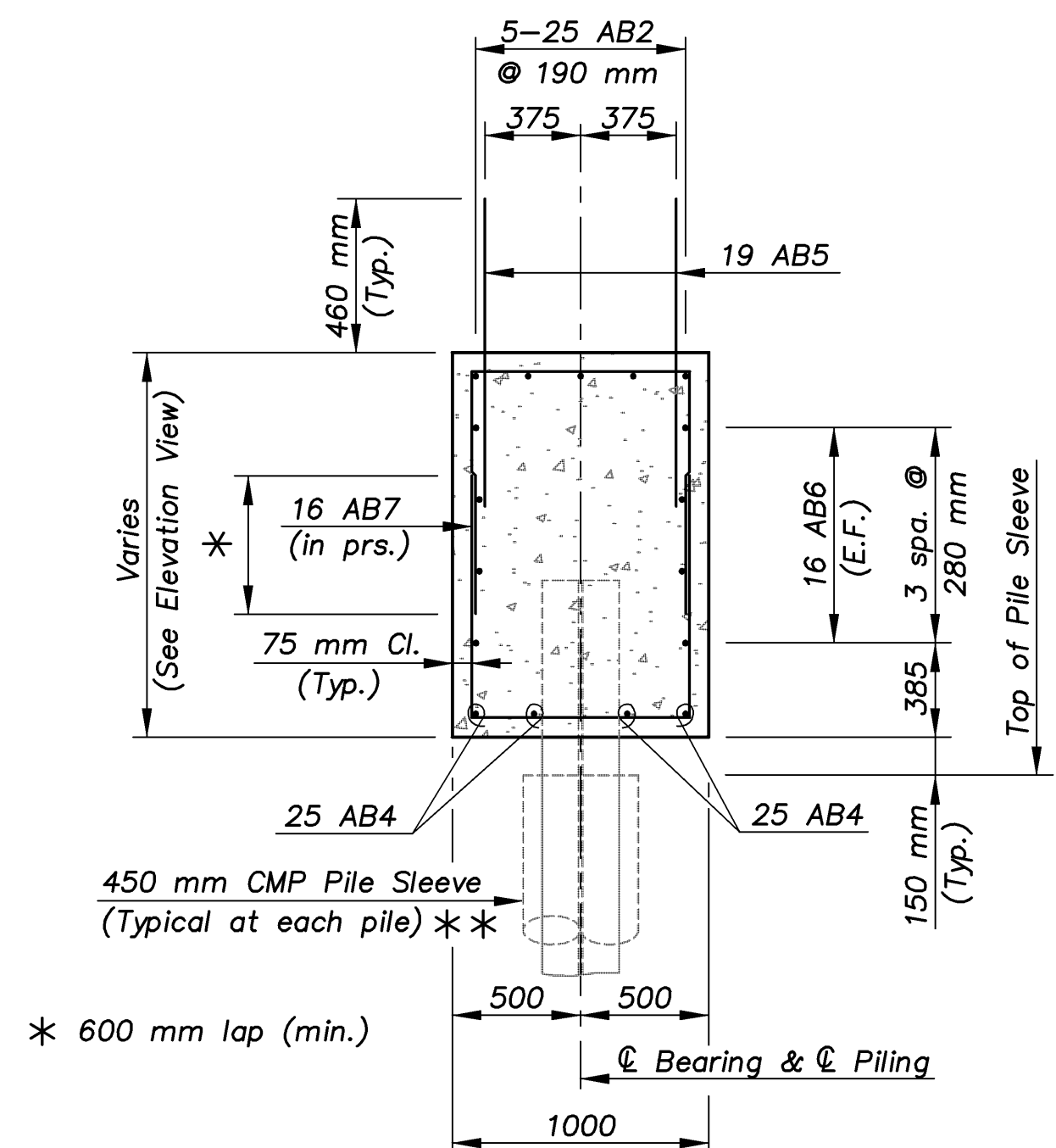

SECTION B-B

DESIGN PILE PRESSURE: 553 kN per Pile Group I Loading
ALLOWABLE LOAD: 620 kN per Pile

KANSAS DEPARTMENT OF TRANSPORTATION
BR. NO. 54-87-30.81(700) W.B. STA. 3+378.725

ABUTMENT BEAM DETAILS
KELLOGG AVENUE OVER ARMOUR ROAD

Proj. No. 54-87 K-8258-01 SEDGWICK COUNTY

CFS
Cook, Flatt & Strobel
ENGINEERS, P. A.
DESIGNED R.S.C. SCALE Varies
DATED T.R.G. DATE
QUANTITIES T.R.G. SHEET 7 OF 39

ARMOUR/ABUTMENT
1:100