

STATE	PROJECT NO.	YEAR	SHEET NO.	TOTAL SHEETS
KANSAS	54-87 K-8258-01	2007	189	556

E.F. INDICATES EACH FACE.
N.F. INDICATES NEAR FACE.
F.F. INDICATES FAR FACE.

** 1680 mm lap (min.) 25 AB1 & AB2 Bars
1200 mm lap (min.) 25 AB3 & AB4 Bars
600 mm lap (min.) 16 AB6 Bars

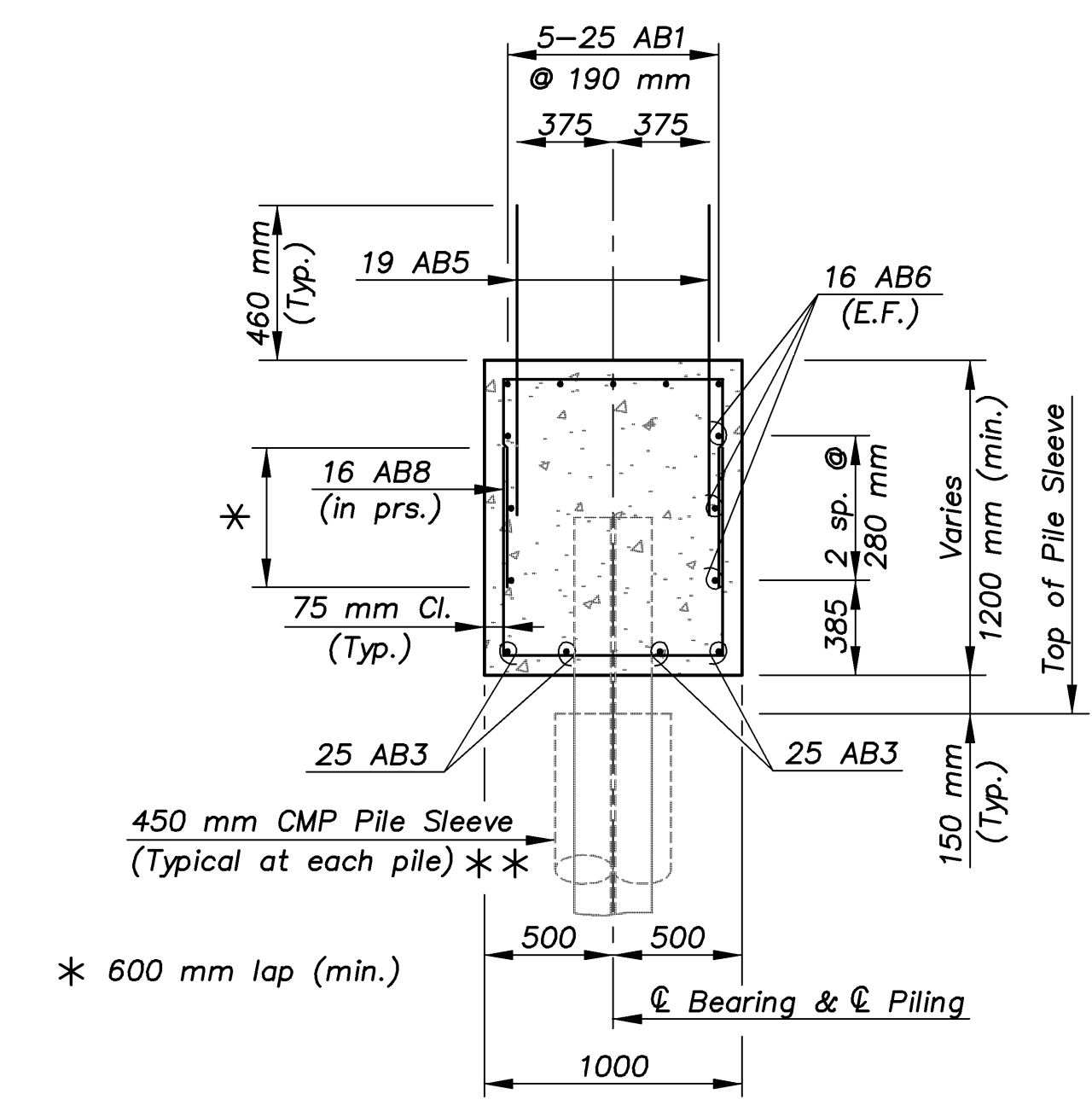
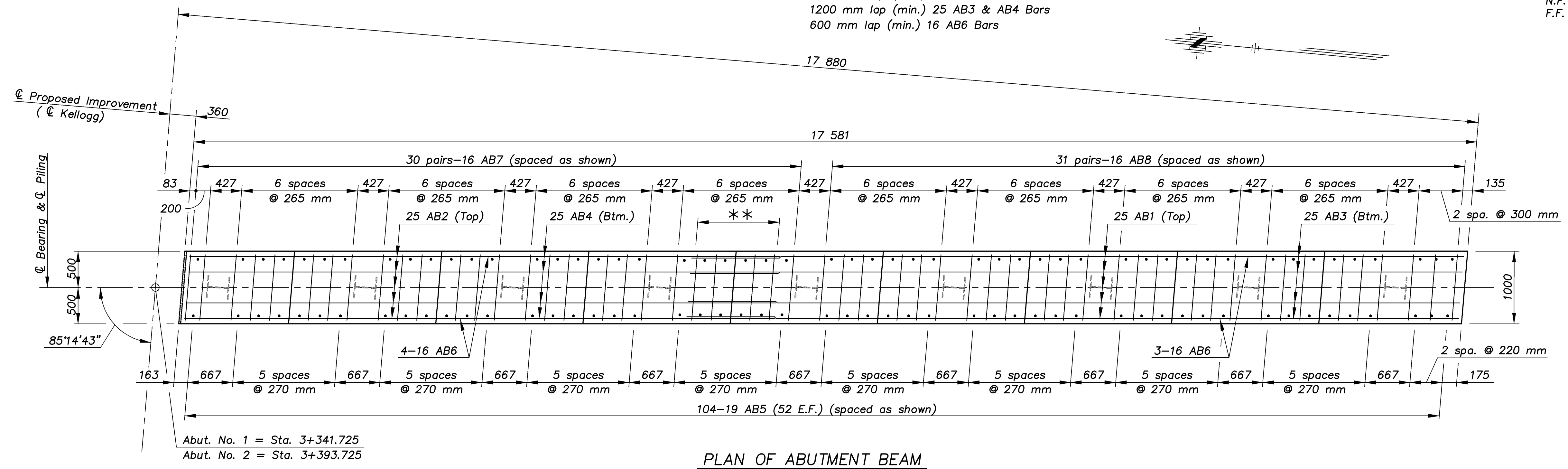

TOP OF MASONRY ELEVATIONS									
Location	Elev. "J"	Elev. "K"	Elev. "L"	Elev. "M"	Elev. "N"	Elev. "O"	Elev. "P"	Elev. "Q"	Elev. "R"
Abutment No. 1	414.870	414.838	414.787	414.745	414.703	414.662	414.620	414.578	414.536
Abutment No. 2	414.265	414.232	414.180	414.138	414.095	414.052	414.010	413.967	413.925

** Abutment Pile Sleeve shall extend from the bottom of the Mechanically Stabilized Earth Retaining Wall to within 150 mm of the bottom of abutment beam at each pile location. Sleeves to be set prior to placement of Select Granular Backfill. Lateral bracing of the pile sleeves is required during the wall construction. Method of bracing shall be approved by the Engineer. Bracing shall remain in service until the Engineer authorizes its removal. The Abutment Pile Sleeves shall be filled with sand. All material and labor necessary to install and maintain the Abutment Pile Sleeves shall be considered Subsidiary to the bid item "Steel Pile HP310x79".

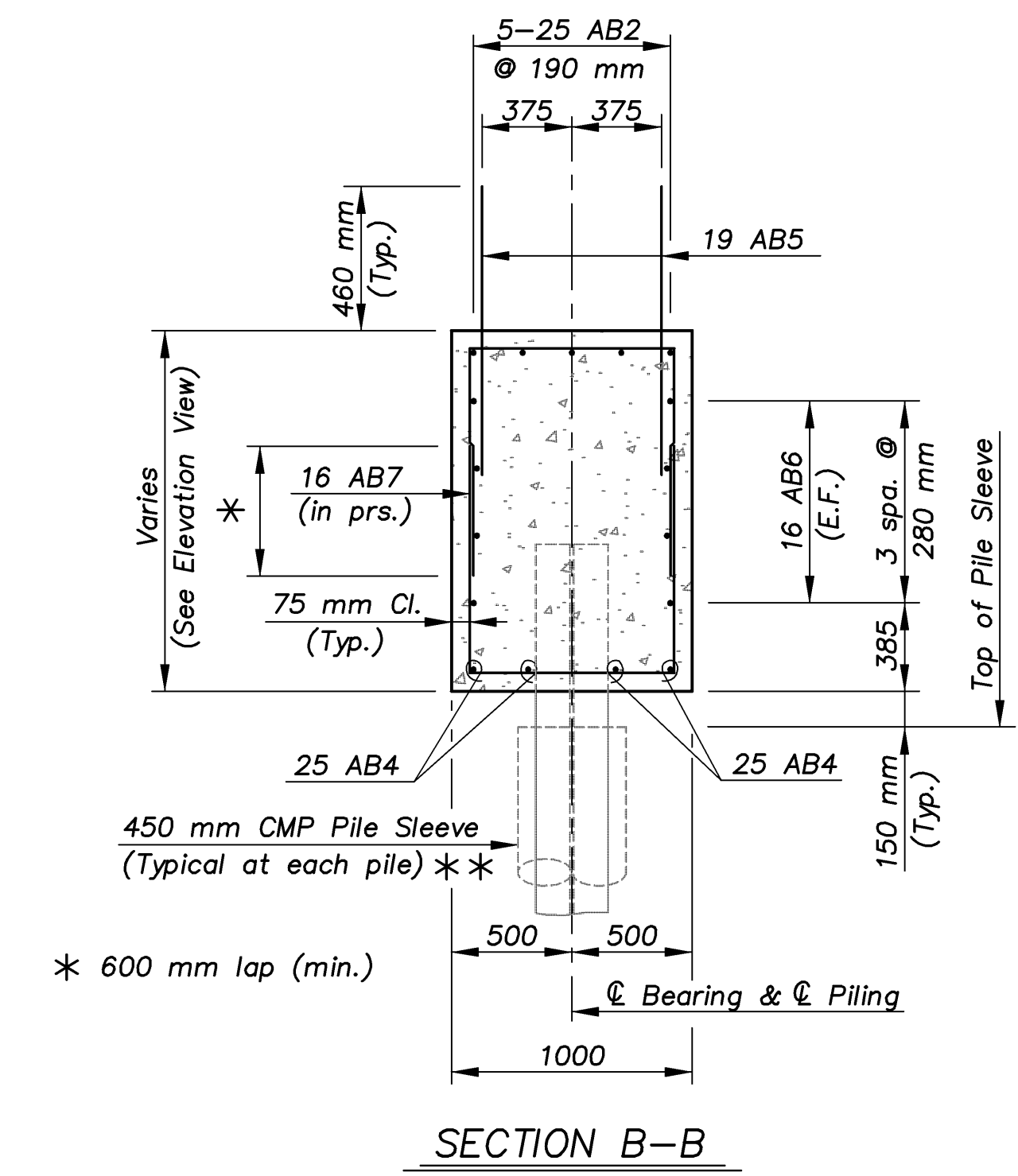
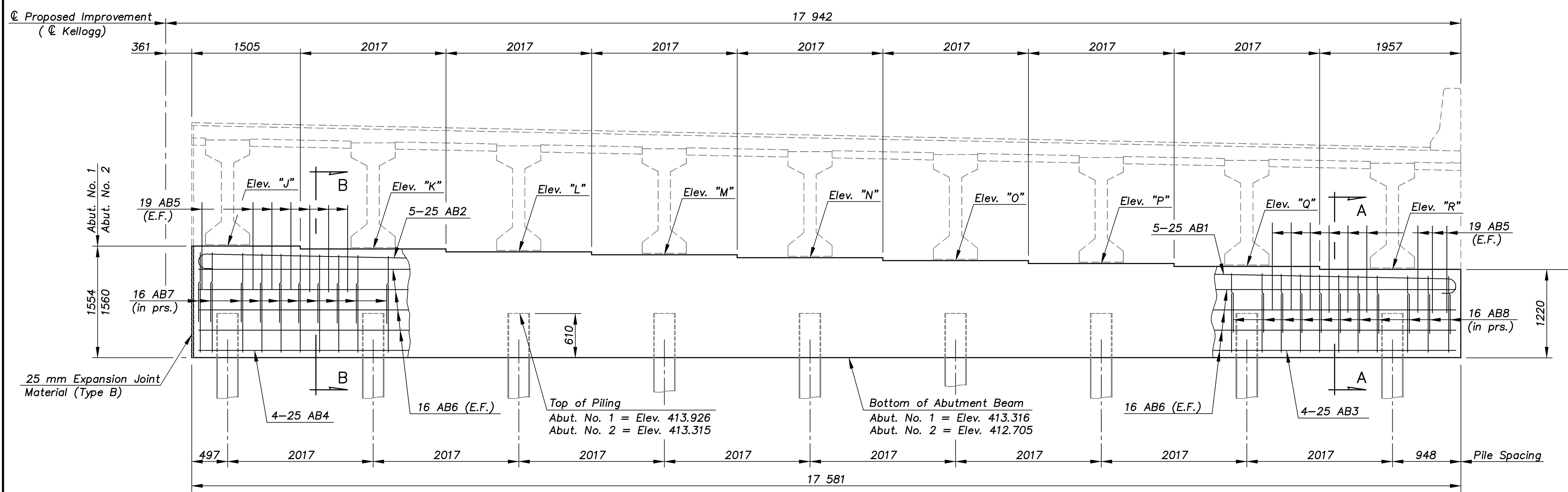

DESIGN PILE PRESSURE: 553 kN per Pile Group I Loading
ALLOWABLE LOAD: 620 kN per Pile

KANSAS DEPARTMENT OF TRANSPORTATION
BR. NO. 54-87-30.82(701) E.B. STA. 3+378.725

ABUTMENT BEAM DETAILS
KELLOGG AVENUE OVER ARMOUR ROAD

Proj. No. 54-87 K-8258-01 SEDGWICK COUNTY

CFS
Cook, Flatt & Strobel
ENGINEERS, P. A.

DESIGNED	R.S.C.	SCALE	Varies
DETAILED	T.R.G.	DATE	
QUANTITIES	T.R.G.	SHEET	9 of 39

ARMOUR/ABUTMENT 1:100