

E.F. INDICATES EACH FACE.
N.F. INDICATES NEAR FACE.
F.F. INDICATES FAR FACE.

STATE	PROJECT NO.	YEAR	SHEET NO.	TOTAL SHEETS
KANSAS	54-87 K-8258-01	2007	270	556

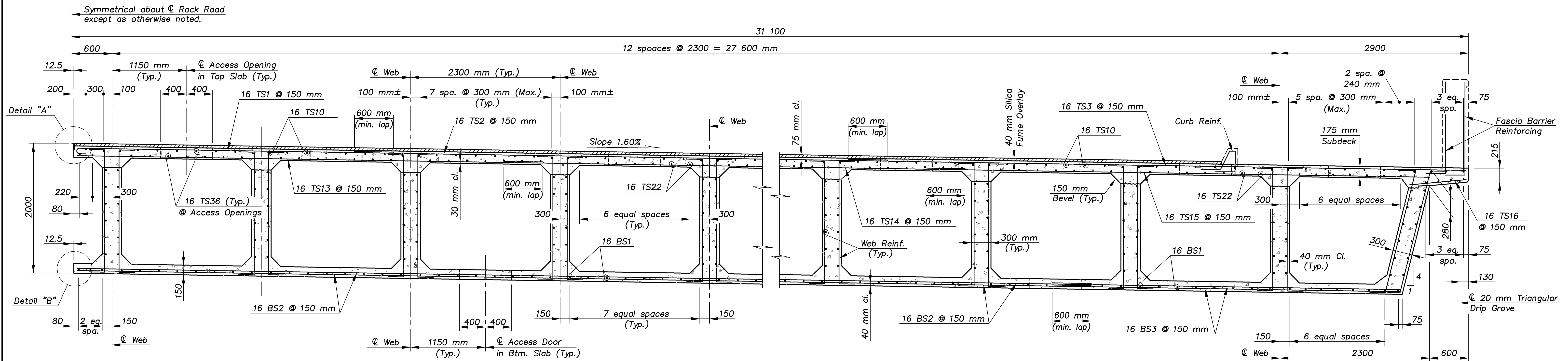

TYPICAL SECTION THRU BOX GIRDER NEAR MID-SPAN

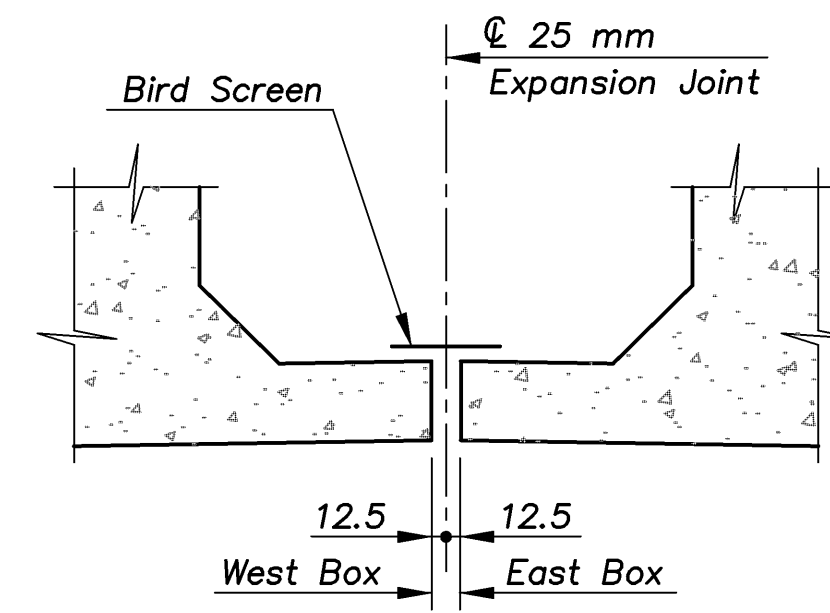

DETAIL "B"

NOTE: THE CONTRACTOR SHALL PROVIDE BIRD SCREEN FOR THE ENTIRE LENGTH OF BRIDGE WITH 13 mm MESH AND GALVANIZED CONNECTION FRAME. THE SCREEN SHALL BE SUBJECT TO APPROVAL BY THE ENGINEER.

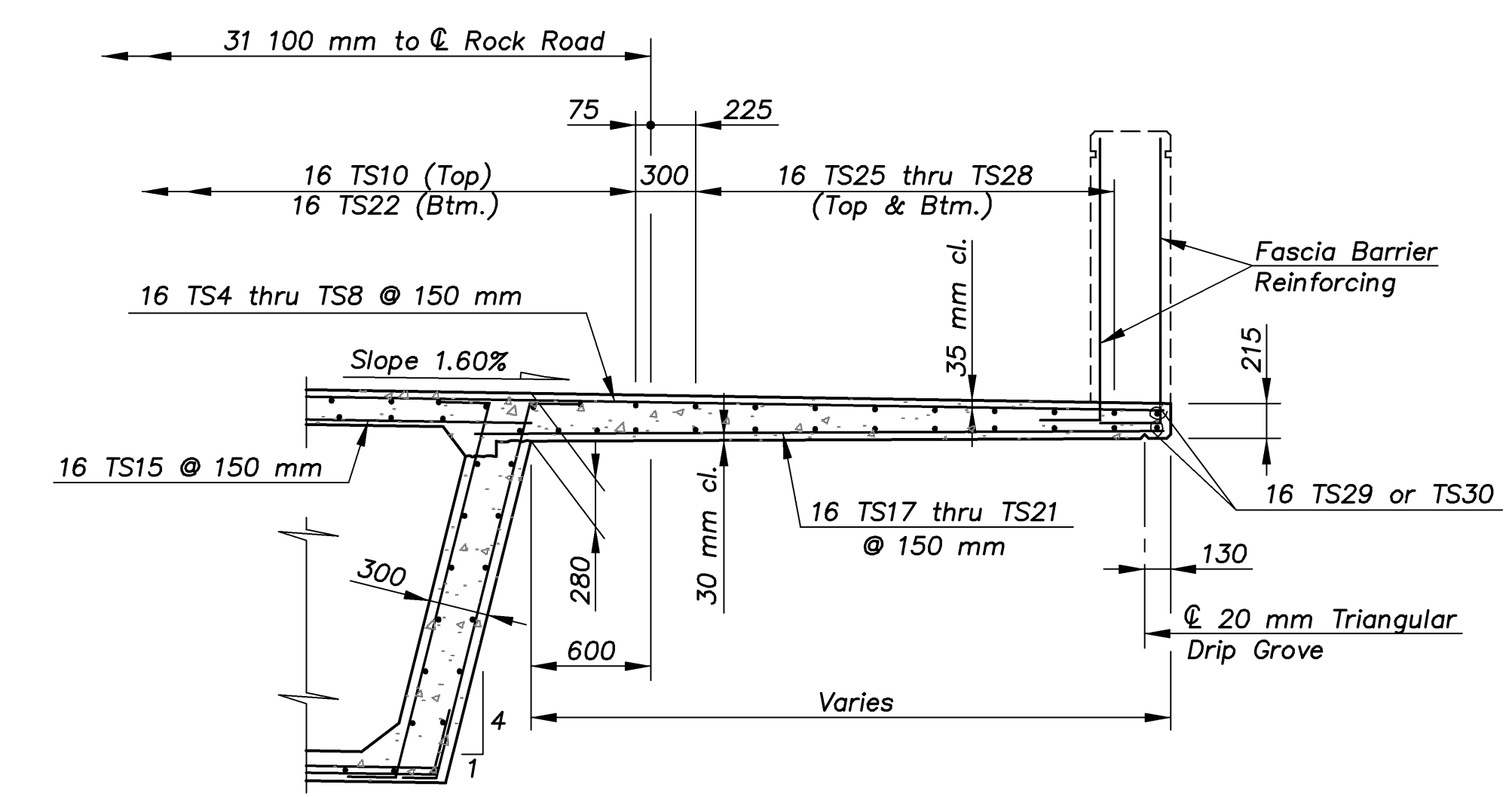

SECTION THRU CANTILEVER SLAB NEAR ABUTMENTS

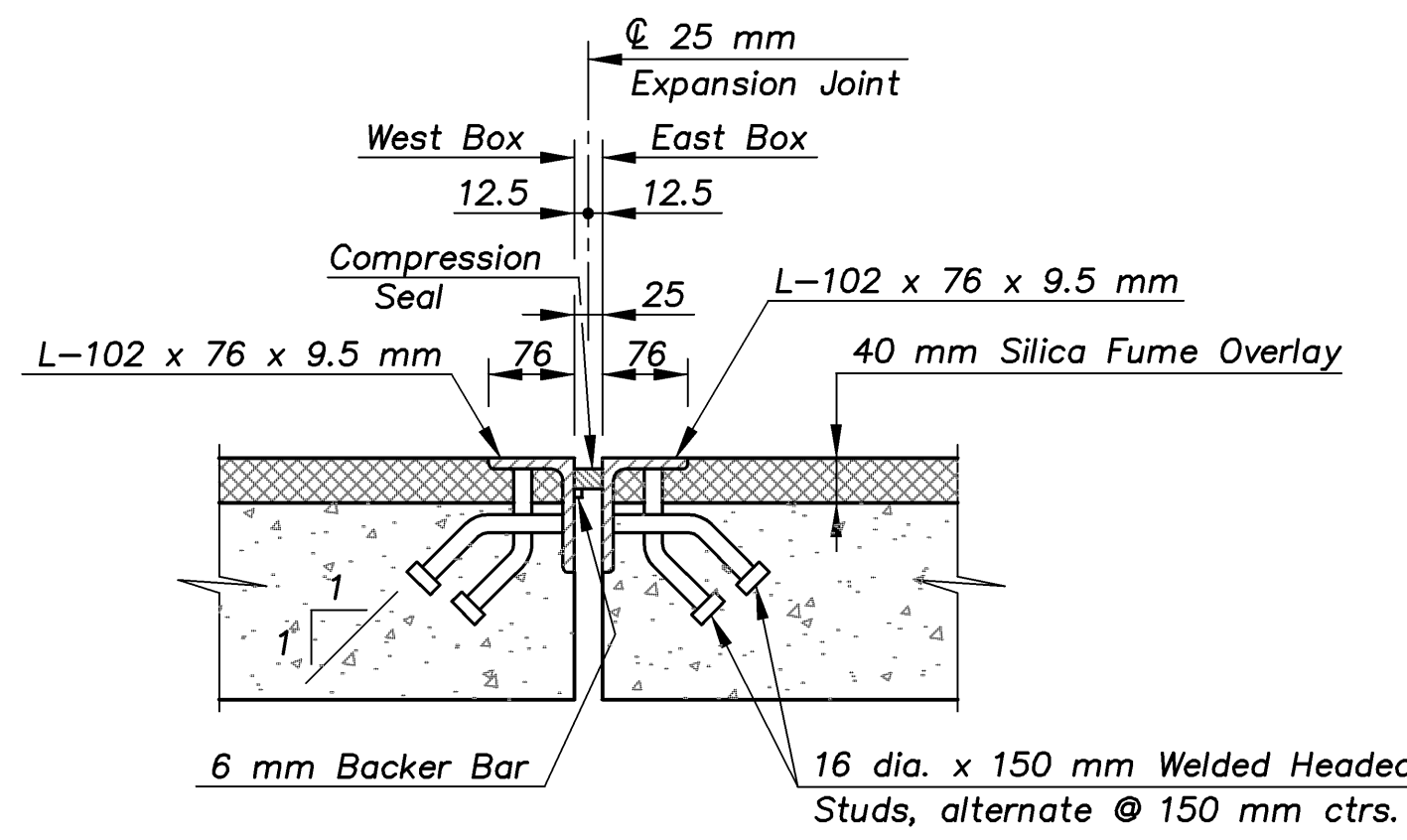

DETAIL "A"

STRUCTURAL STEEL FOR THE DECK JOINT SHALL CONFORM TO THE REQUIREMENTS FOR ASTM A709M GRADE 250 STEEL AND SHALL BE GALVANIZED AFTER FABRICATION. THE STEEL ANGLES, BACKER BAR AND HEADED STUDS WILL NOT BE PAID FOR DIRECTLY BUT SHALL BE SUBSIDIARY TO THE UNIT PRICE BID FOR "ELASTOMERIC COMPRESSION SEAL". THE ELASTOMERIC COMPRESSION SEAL SHALL EXTEND CONTINUOUSLY FROM END TO END OF WEARING SURFACE. THE SEAL SHALL BE BONDED TO THE WEST BOX STEEL ANGLE ONLY AND RECESSED 3 mm FROM THE TOP OF THE WEST BOX ANGLE. THE ELASTOMERIC COMPRESSION SEAL WIDTH SHALL BE DETERMINED PER MANUFACTURER'S RECOMMENDATION FOR A 25 mm JOINT OPENING. SEE KDOT SPECIFICATIONS.

KANSAS DEPARTMENT OF TRANSPORTATION		BR. NO. 54-87-31.12(702)		STA. 3+877.518	
TYPICAL BOX GIRDER SECTIONS					
ROCK ROAD OVER KELLOGG AVENUE					
Proj. No. 54-87 K-8258-01 SEDGWICK COUNTY					
CFS		Cook, Flatt & Strobel ENGINEERS, P. A.			
DESIGNED	R.S.C.	SCALE	Varies		
DETAILED	T.R.G.	DATE			
QUANTITIES	T.R.G.	SHEET	24 OF 41		

1:100
ROCK/SLAB