

STATE	PROJECT NO.	YEAR	SHEET NO.	TOTAL SHEETS
KANSAS	54-87 K-8258-01	2007	404	556

NOTE:  
 Signs shown as "Signing Removals" were in place when the multi-phased Rock Road Interchange Project was started. Significant changes have occurred. Coordinate removals with the Resident Project Representative. Cost is incidental to "Signing".

REFERENCE NOTED	DATE
REFERENCE CHECKED	

Scale: 1:500

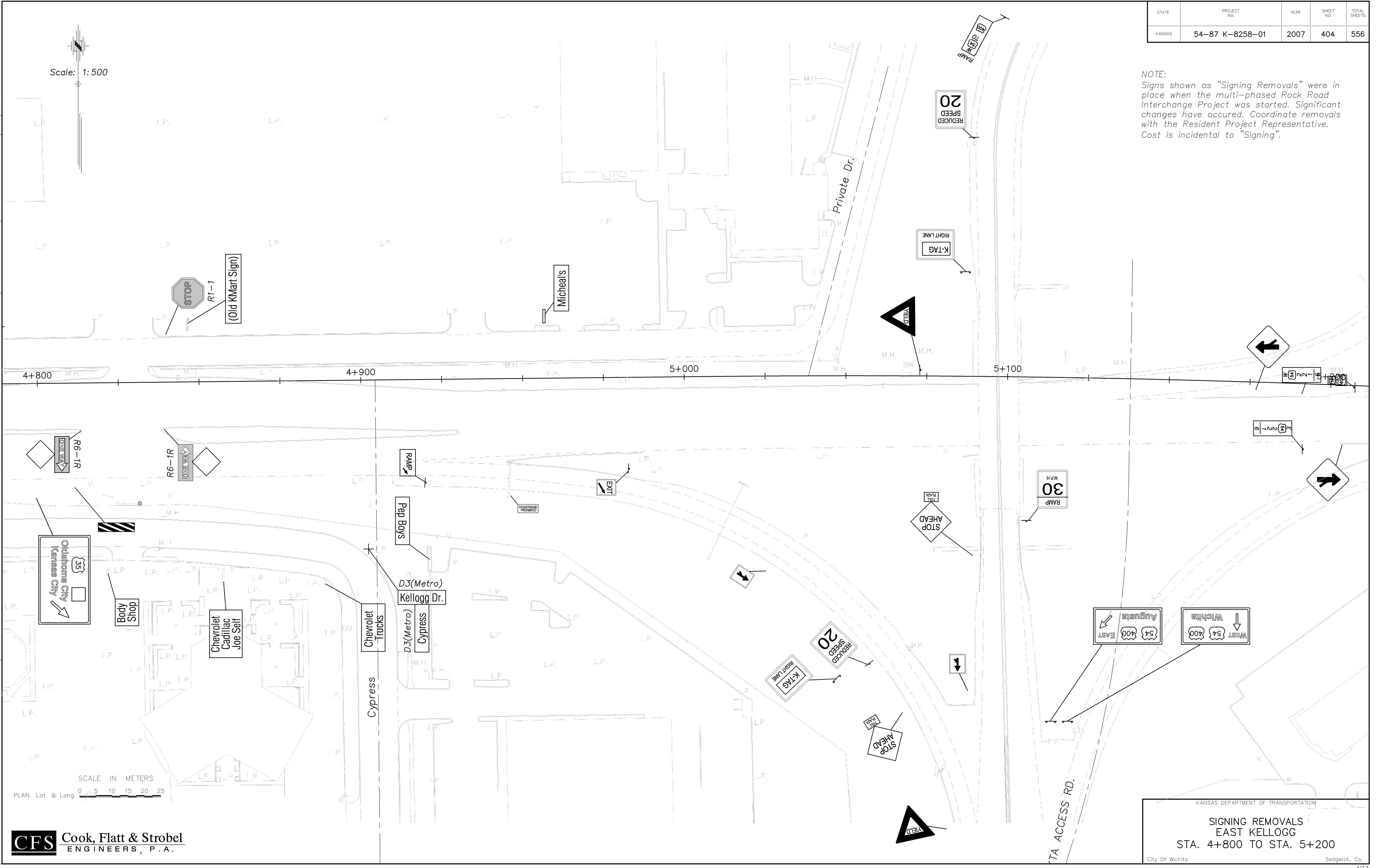

Drawn by: [Name]  
 File: [Name]  
 SCALE 1:500

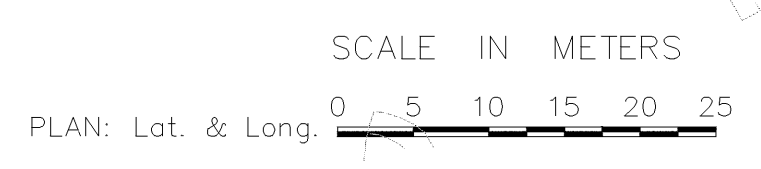

**CFS** Cook, Flatt & Strobel  
 ENGINEERS, P.A.

KANSAS DEPARTMENT OF TRANSPORTATION  
**SIGNING REMOVALS**  
 EAST KELLOGG  
 STA. 4+800 TO STA. 5+200  
 City Of Wichita Sedgwick, Co.