

| STEEL DETAILS | | |
|---------------|---|------|
| TRUSS | Member 1 Wall Thickness | 4.78 |
| | Member 2 Wall Thickness | 3.05 |
| | N = 10 X = 235 S = 1728 Camber = 22 | |
| END SUPPORTS | Member 1 Wall Thickness | 4.78 |
| | Member 2 Wall Thickness | 3.18 |
| | Left N = 2 S = 1950 L = 6265 | |
| | Right N = 2 S = 2050 L = 6465 | |
| FOOTINGS | Left Type | D |
| | Right Type | D |

ELEVATION

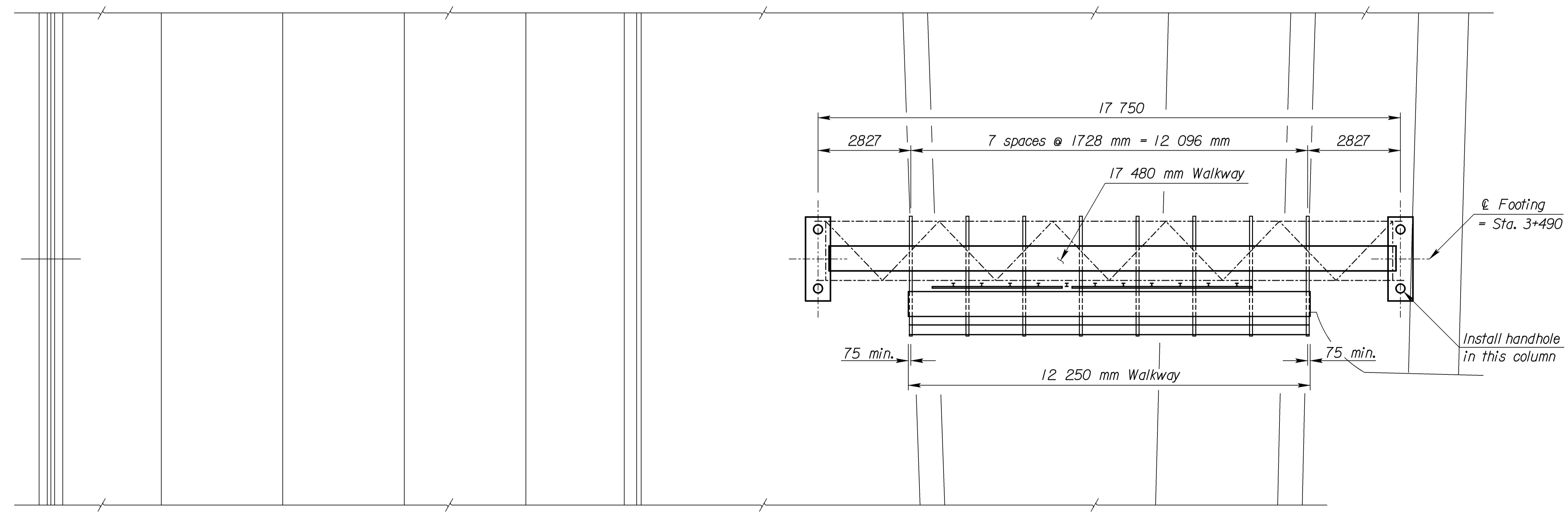

PLAN

- †NOTES:
- 1.) "Left Type" footing shall be drilled shafts.
 - 2.) Install the "Left Type" footing before beginning wall construction in this area.

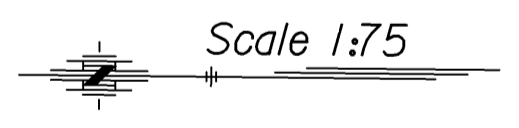

Plotted By: \$\$\$USERNAME\$\$\$ Plot Location: \$UNIT\$
 File: \$\$\$CONSPE\$\$\$
 Plot Date: \$\$\$STTIME\$\$\$

| 3 | | | | |
|--|------------|-----------|----------|------------|
| 2 | | | | |
| 1 | | | | |
| NO. | DATE | REVISIONS | BY | APP'D |
| KANSAS DEPARTMENT OF TRANSPORTATION E.B. Frontage Road STATION 3+450 SPAN TYPE OVERHEAD SIGN STRUCTURE CONSTRUCTION LAYOUT STEEL ALTERNATE PROJ. NO. 54-87 K-8258-01 SEDGWICK CO. | | | | |
| SHEET NO. | OF | SCALE | APP'D | |
| DESIGNED | CEM | DETAILED | CEM | QUANTITIES |
| DESIGN CK. | DETAIL CK. | QUAN. CK. | CADD CK. | CEM |