

PLAN	CHECKED	DATE
	CHECKED	

PROFILE	CHECKED	DATE
	CHECKED	

Saved: 02-02-2009 9:33:12 AM by CSI
 Plot Scale: 1:20 02-03-2009 2:39:29 PM by JMN
 02/02/2007 07:00:00 Phase 1 07600-01-55PP02

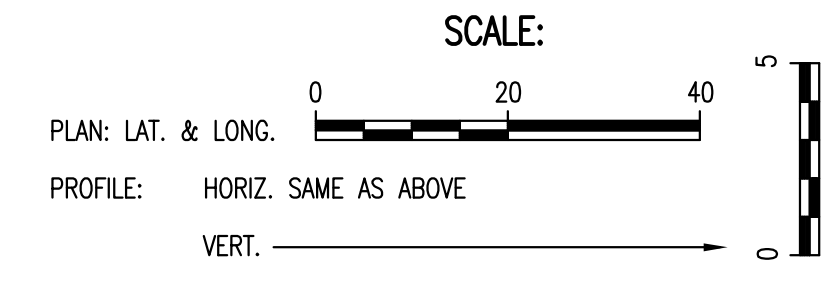
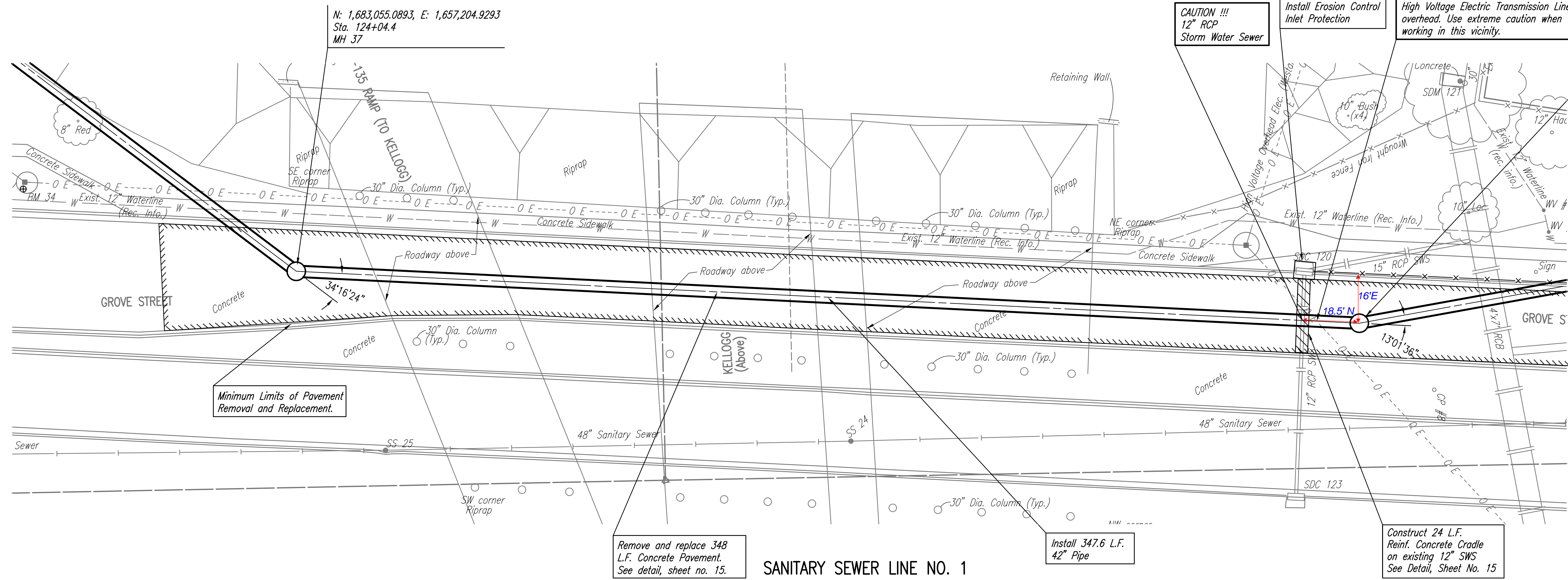

N: 1,683,055.0893, E: 1,657,204.9293
 Sta. 124+04.4
 MH 37

N: 1,683,402.3273, E: 1,657,221.8781
 Sta. 127+52.0
 Const. MH 38
 Standard MH (6' dia.)

Sta. 127+52.0, N of Kellogg overpass
 18.5' N centerline SWS curb inlet
 16' E b/c, W of edge of Grove

Minimum Limits of Pavement
 Removal and Replacement.

Remove and replace 348
 L.F. Concrete Pavement.
 See detail, sheet no. 15.

Install 347.6 L.F.
 42\"/>

Construct 24 L.F.
 Reinf. Concrete Cradle
 on existing 12\"/>

SANITARY SEWER LINE NO. 1

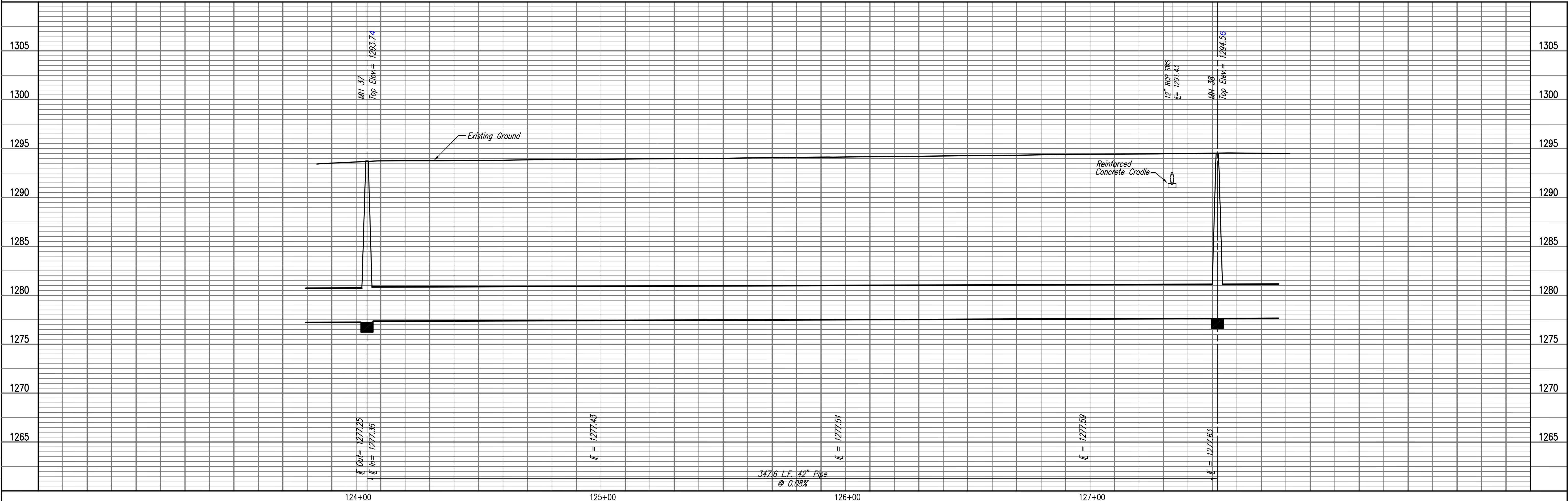

RELOCATION OF SANITARY SEWER NO. 23 INTERCEPTOR
 PHASE 1: ENGLISH/1-15 TO KELLOGG/GROVE
 SANITARY SEWER LINE NO. 1
 JAMES L. ARMOUR, P.E. - CITY ENGINEER
 CITY OF WICHITA PROJECT NO. 468-84375

Professional Engineering Consultants, P.A.
 803 S. TOPICKA AVENUE, WICHITA, KANSAS 67202
 316-262-2691 • FAX 316-262-3003

Designed By: MDK, EJB
 Drawn By: CSL, RWL

Job No.: 55-07600-001
 Date: AUGUST 2008

Sheet 5 of 19