



LEGEND

-  Construction Phase 1
-  Construction Phase 2

0 40 80 120  
SCALE  
1" = 40'  
FEET

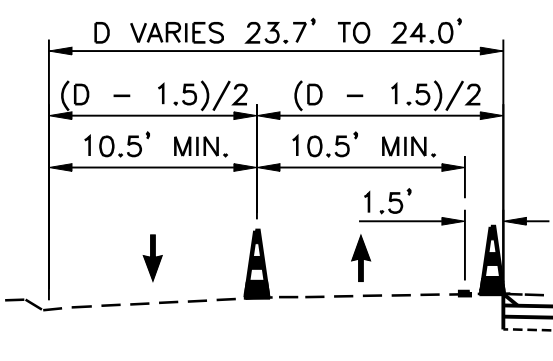
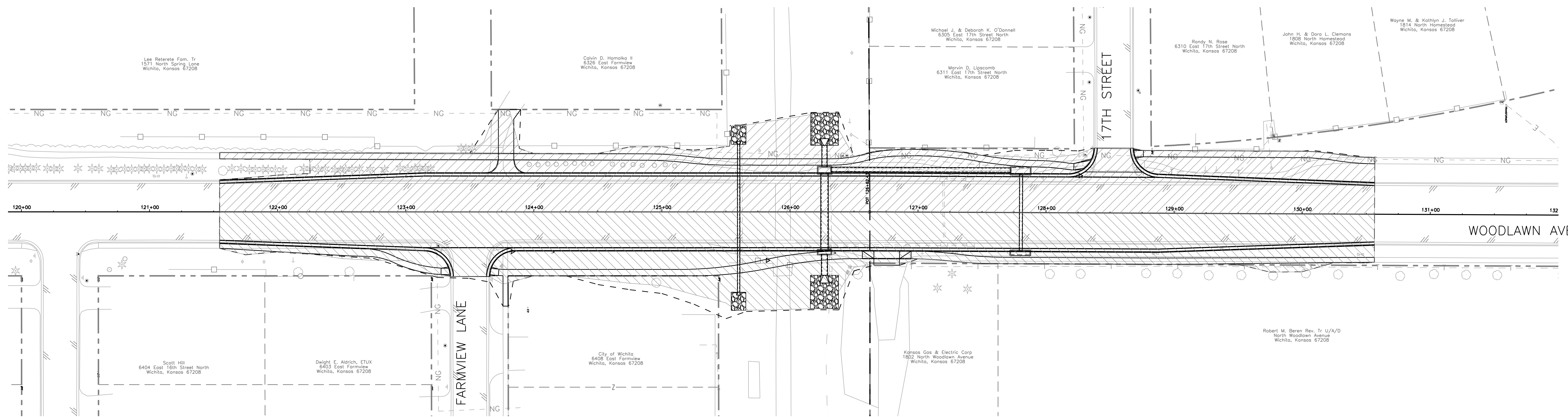
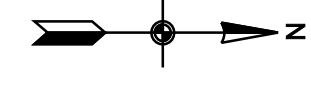

PHASE 1 TYPICAL SECTION  
N.T.S.

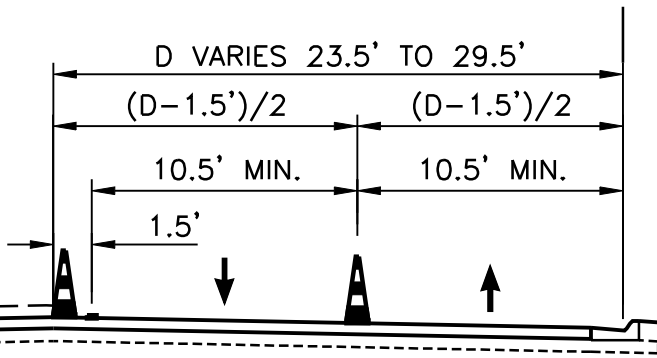

PHASE 2 TYPICAL SECTION  
N.T.S.

CONSTRUCTION PHASING

PHASE 1 - THE CONTRACTOR SHALL CLOSE THE EAST HALF OF WOODLAWN, DIVERTING NORTHBOUND TRAFFIC INTO INTERIOR SOUTHBOUND LANE AND DIVERTING THE INTERIOR SOUTHBOUND LANE TRAFFIC INTO THE EXTERIOR SOUTHBOUND LANE. SEE TRAFFIC STANDARD TE 748 AND TYPICAL SECTIONS ON THIS PAGE FOR MORE DETAILS. FARMVIEW LANE SHALL BE BUILT HALF AT A TIME DURING PHASE 1. THE FIRESTATION SHALL HAVE ACCESS TO WOODLAWN AT ALL TIMES. 17TH STREET SHALL REMAIN OPEN. THE CONTRACTOR SHALL THEN CONSTRUCT IMPROVEMENTS LOCATED IN THE PHASE 1 AREA. TEMPORARY STORM SEWER TIE-INS AND/OR DEWATERING SHALL BE SUBSIDIARY TO THE TRAFFIC CONTROL ITEM.

PHASE 2 - THE CONTRACTOR SHALL CLOSE THE WEST HALF OF WOODLAWN, DIVERTING SOUTHBOUND TRAFFIC INTO THE INTERIOR NORTHBOUND LANE, AND DIVERTING THE INTERIOR NORTHBOUND LANE INTO THE EXTERIOR NORTHBOUND LANE. SEE TRAFFIC STANDARD TE 748 AND TYPICAL SECTIONS ON THIS PAGE FOR MORE DETAILS. FARMVIEW LANE SHALL REMAIN OPEN DURING PHASE 2 BUT 17TH STREET SHALL BE BUILT HALF AT A TIME. THE CONTRACTOR SHALL THEN CONSTRUCT IMPROVEMENTS LOCATED IN THE PHASE 2 AREA. TEMPORARY STORM SEWER TIE-INS AND/OR DEWATERING SHALL BE SUBSIDIARY TO THE TRAFFIC CONTROL ITEM.

GENERAL TRAFFIC CONTROL NOTES

1. ALL TRAFFIC CONTROL SHALL CONFORM TO THE LATEST EDITION OF THE MANUAL ON UNIFORM TRAFFIC CONTROL DEVICES (MUTCD).
2. TRAFFIC SHALL BE CARRIED THROUGH ON WOODLAWN AVENUE DURING CONSTRUCTION.
3. THE CONTRACTOR WILL BE REQUIRED TO PROVIDE ACCESS TO PROPERTY OWNERS OR OCCUPANTS DURING CONSTRUCTION. THE CONTRACTOR SHALL PROVIDE 7 DAYS NOTICE TO PROPERTY OWNERS AND OCCUPANTS BEFORE BEGINNING IMPROVEMENTS IN THE VICINITY OF THE PROJECT.
4. EXISTING PAVEMENT MARKING AND SIGNING CONFLICTING WITH THE TRAFFIC CONTROL SHALL BE COVERED OR REMOVED DURING CONSTRUCTION. PAVEMENT MARKINGS CONFLICTING WITH THE TRAFFIC CONTROL WHICH ARE OUTSIDE THE PROJECT LIMITS SHALL BE COVERED WITH AN APPROVED REMOVABLE TAPE DURING CONSTRUCTION.

**Tran Systems**  
245 NORTH WACO  
SUITE 222  
WICHITA, KANSAS 67202  
PHONE: 316-303-3000  
FAX: 316-303-0156

CONSULTANTS:

WOODLAWN AVENUE &  
17TH STREET/FARMVIEW LANE  
INTERSECTION IMPROVEMENTS  
WICHITA, KANSAS

REVISIONS:	MARK	DATE	DESCRIPTION

PROJ NO: 472 84907  
SCALE: 1" = 40'  
DATE: 8/10/2010  
DESIGNED BY: SGE  
DRAWN BY: SGE  
CHECKED BY: JRL

SHEET TITLE:  
**CONSTRUCTION SEQUENCE**

SHEET NO.  
**29**  
SHEET 29 OF 50