

PROPOSED ALLEY IMPROVEMENTS FROM 1ST AND 2ND BETWEEN WACO & WICHITA

PROJECT NO. 472-84913

O.C.A. No. : 132723

CITY OF WICHITA, KANSAS

SANITARY SEWER IMPROVEMENTS

PROJECT NO. 468-84691

UTILITY CONTRACTOR LIST

- | | |
|--|--|
| <p><i>Westar</i>
1900 East Central
P.O. Box 208
Wichita, KS 67202
316-261-6251
Contact: Randy Truitt</p> <p><i>Kansas Gas Service</i>
1021 East 26th Street North
P.O. Box 47008
Wichita, KS 67201
316-832-3126
Contact: Jim Coe</p> <p><i>Black Hills Energy</i>
1611 S. Hoover
Wichita, KS 67209
316-941-1608
Contact: Calvin Briggs</p> <p><i>Cox Communications</i>
701 East Douglas
Wichita, KS 67202
316-262-4270
Contact: Bryan Ring</p> <p><i>AT&T</i>
154 North Broadway
Wichita, KS 67202
316-268-2259
Contact: Jim Taben</p> <p><i>Rural Water District #3</i>
1120 East 111th South
Wichita, KS 67110
620-777-0877
Contact: Steve Parker</p> | <p><i>Stormwater Utility</i>
City of Wichita
City Hall - 8th Floor
455 North Main
Wichita, KS 67202
316-268-4545
Contact: Scott Lindebak</p> <p><i>Dept. of Water & Sewer</i>
City of Wichita
City Hall - 8th Floor
455 North Main
Wichita, KS 67202
316-268-4555
Contacts: LaDonna Lawrenz (Sewer)
Kerry Gibson (Water)</p> <p><i>Traffic Engineering</i>
City of Wichita
City Hall - 7th Floor
455 North Main
Wichita, KS 67202
316-268-4446
Contact: Paul Gunzelman</p> <p><i>Sedgwick County Emergency Management Agency</i>
535 N. Main, Suite B10
Wichita, KS 67203-3702
316-383-7546
Contact: Jack Kegley</p> |
|--|--|

INDEX OF SHEETS

- | | |
|-----|---------------------|
| 1 | TITLE SHEET |
| 2 | GENERAL NOTES |
| 3 | PAVING DETAILS |
| 4-5 | ALLEY PLANS |
| 6 | DRIVE DETAIL |
| 7-8 | REMOVAL PLANS |
| 9 | SANITARY SEWER PLAN |
| 10 | TYPE P MH DETAIL |
| 11 | SEWER RISER DETAIL |
| 12 | STORM SEWER PLAN |
| 13 | DROP INLET DETAIL |

BENCHMARK

"□" on Sidewalk 2' East and 1' South of SW Property Line of Cargill Lot.

ELEV (NAVD88) = 1302.00

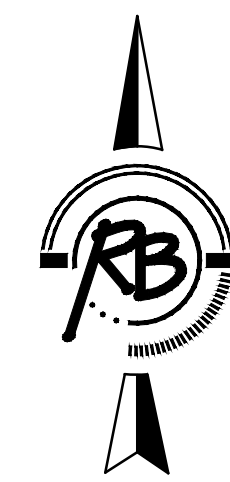

NO SCALE

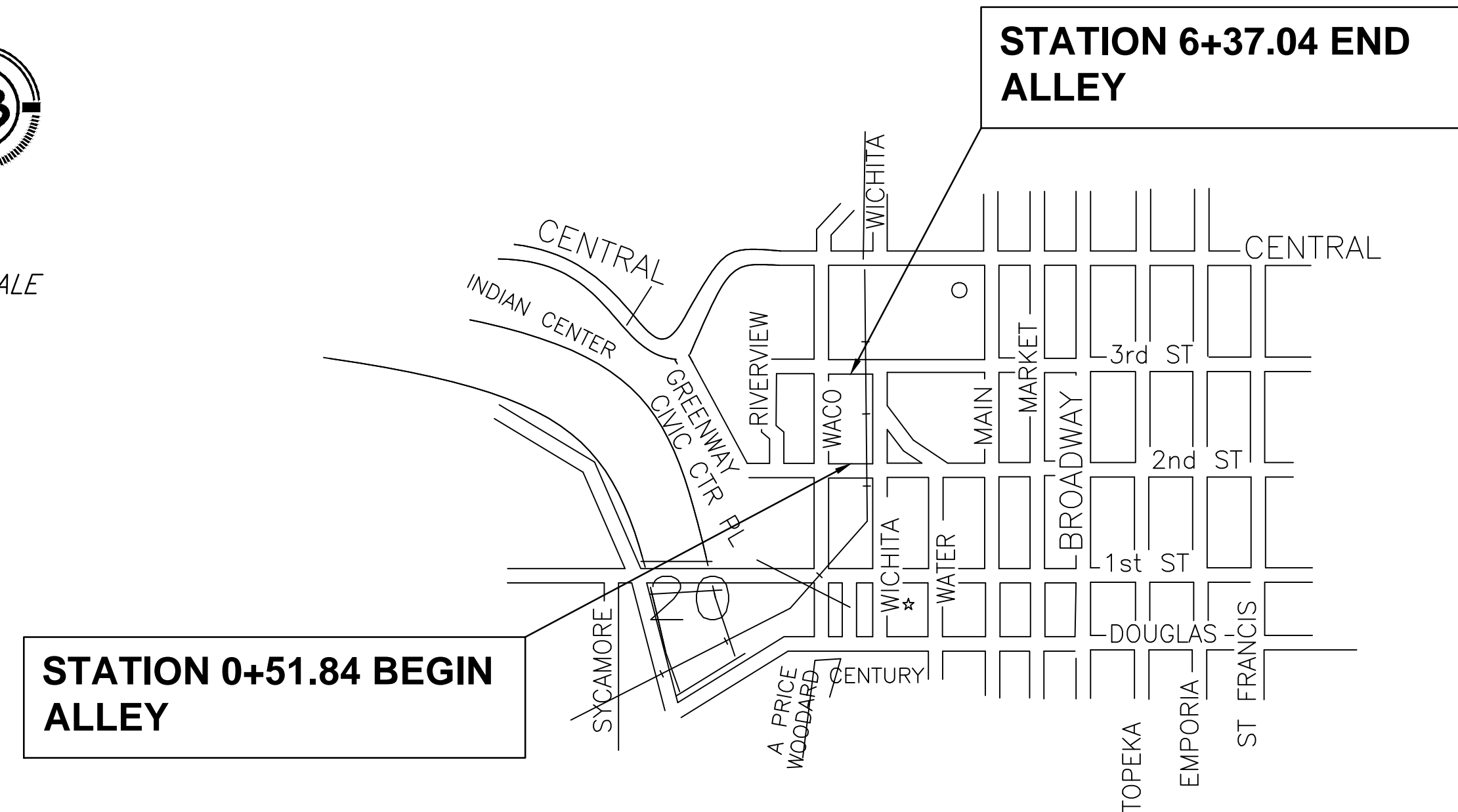

Gross Length of Project	640
Exceptions	_____
Additions	_____
Net Length of Project	640
Net Length of Bridges	_____
Net Length of Roads	640



JAMES L. ARMOUR, P.E., CITY ENGINEER

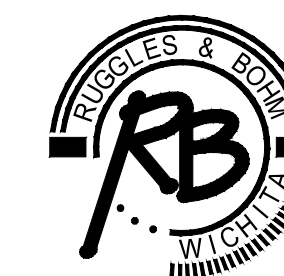

Ruggles & Bohm, P.A.
Engineering, Surveying, Land Planning
924 North Main (316) 264-8008
Wichita, Kansas 67203 (316) 264-4621 fax
www.rbkansas.com E-mail: info@rbkansas.com