

STATE	PROJECT NO.	YEAR	SHEET NO.	TOTAL SHEETS
KANSAS	435379	2010	14	19

LEGEND

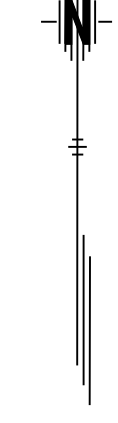

REFERENCES NOTED	BY	DATE
REFERENCES CHECKED		

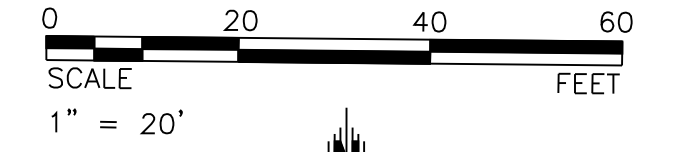
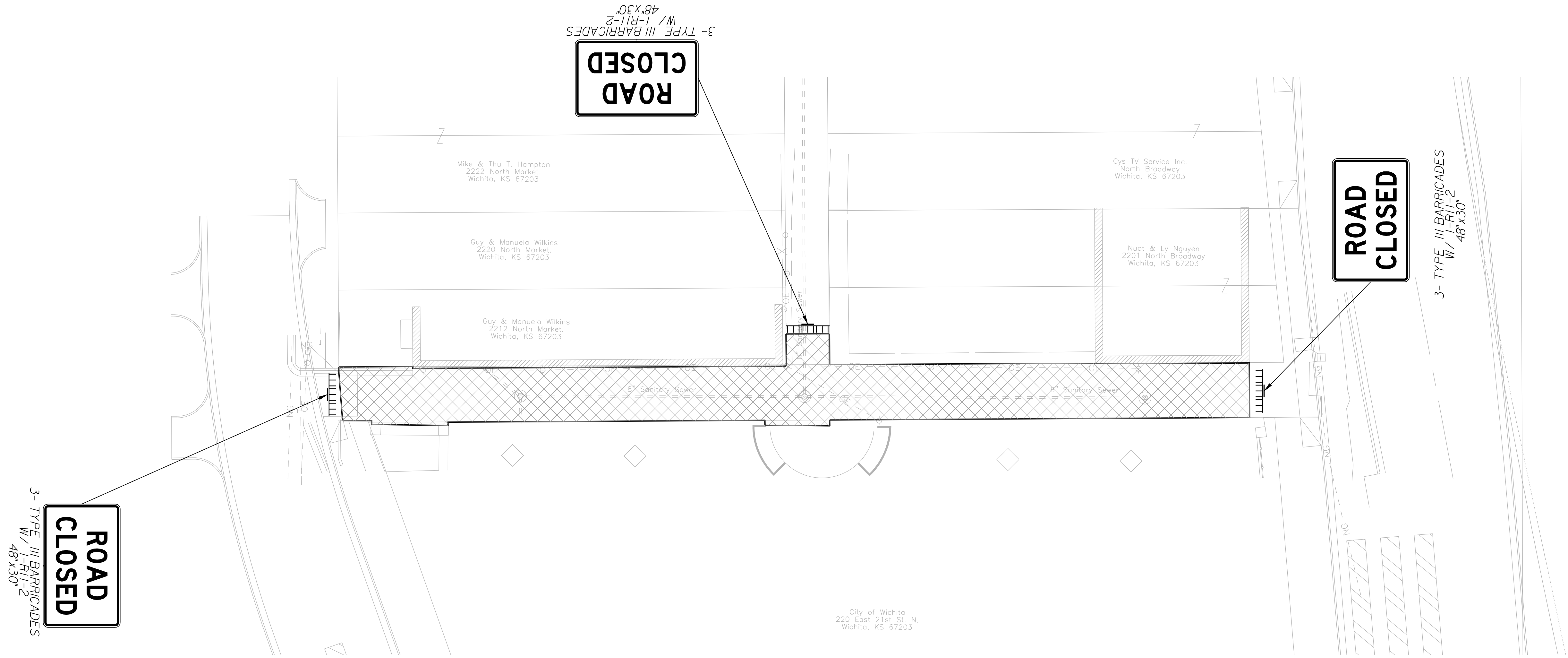

GENERAL NOTES

1. Remove or cover all existing traffic control devices which conflict with construction signing
2. Contractor shall work with adjacent businesses and residents to maintain access as long as possible in advance of the work area and restore access as soon as possible after work is completed within the work area.
3. Site shall be closed to thru traffic during construction. No signed detour will be provided.

Plotted By: ccbanaka
 File: g:\w1100017\Road\0017top1a.sht
 Plotted: 8/27/2010

CITY OF WICHITA NOMAR ALLEY RECONSTRUCTION	
TRAFFIC CONTROL	
WICHITA, KANSAS	
DESIGNED: C.C.B.	DRAWN: C.C.B.
CHECKED: S.G.E.	DATE: 8/27/2010