

P.I. @ Sta. 112+86.57-
W 1/4 Cor. Sec. 30, T27S, R1W
I. See Reference below

Scale: 1"=20'

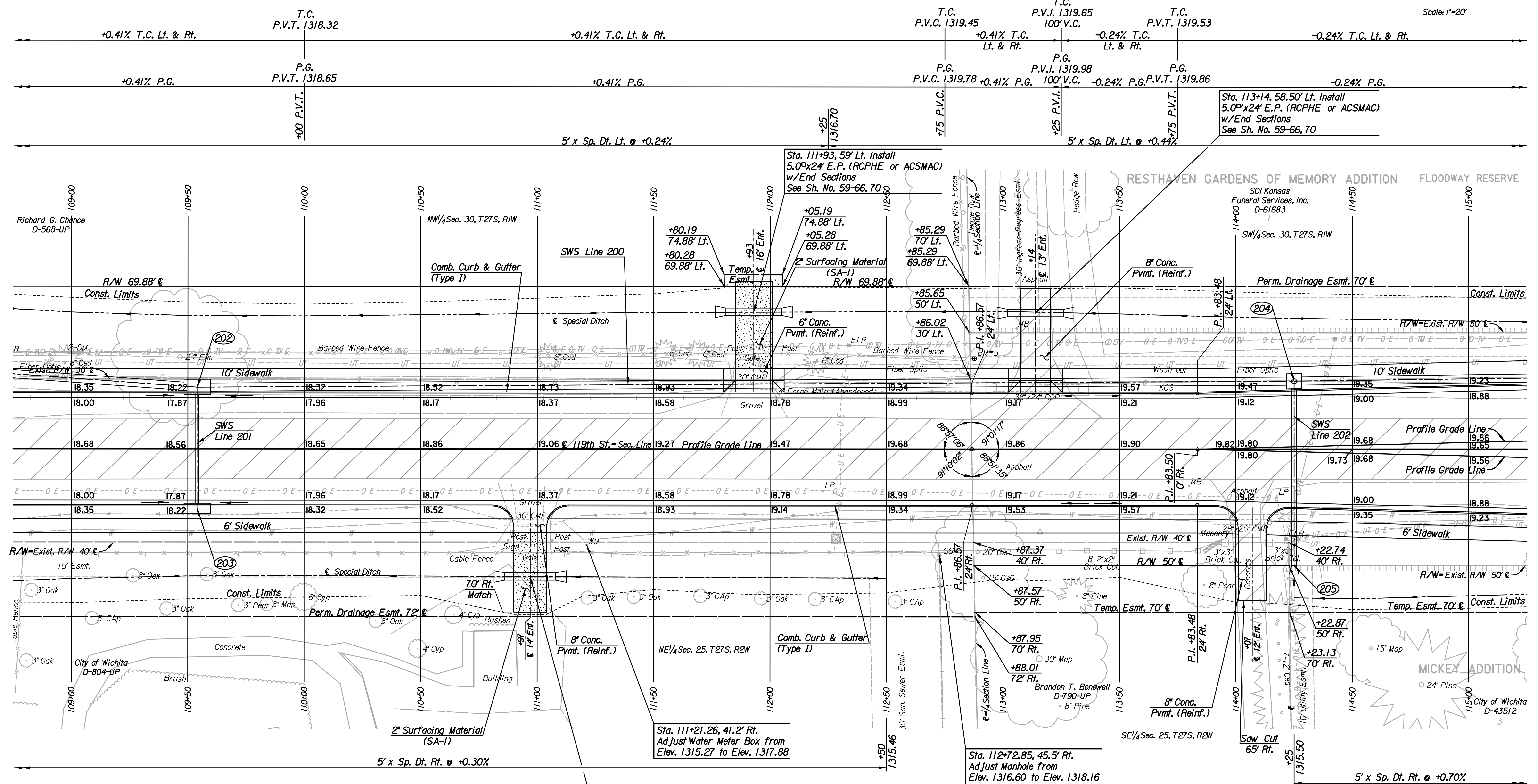

REMOVAL OF EXISTING STRUCTURES *		
STATION	SIDE	ITEM
110+97	Rt.	30" CMP
111+92	Lt.	30" CMP
113+15	Lt.	38"x24" CMP w/End Sections
114+03	Rt.	28"x20" CMP

* For Information Only

- W 1/4 Cor. Sec. 30, T27S, R1W
 1. Found 3/4" IP in Round Monument Box
 2. N 1,682,750,7958 E 1,607,507,9148
 3. @ Sta. 112+86.57
 4. Nail and Washer in top fence line post
 5. 3 Nails in S face fence corner post
 6. 3 Nails in E face old fence brace post
 7. Center drive at 1200 S 119th St. W.
 8. Hedge Row line
 9. Center traveled way 199th St. W.

66.39' NE
 41.08' E
 40.35' WSW
 ± 35' S
 E to W

Sta. 110+97, 54.75' Rt. Install
 5.0"x22" E.P. (RCPHE or ACSMAC)
 w/End Sections
 See Sh. No. 59-66, 70

Sta. 111+21.26, 41.2' Rt.
 Adjust Water Meter Box from
 Elev. 1315.27 to Elev. 1317.88

Sta. 112+72.85, 45.5' Rt.
 Adjust Manhole from
 Elev. 1316.60 to Elev. 1318.16
 See Sh. No. 55, 70

- Utilities**
 Kansas Gas Service
 Westar Energy
 Wichita Water and Sanitary Sewer
 AT&T
 Cox Communication
 Wichita Water and Sanitary Sewer

BM*5 Found C.O.W. Disc 39' E of W/4 Cor. Sec. 30, T27S, R1W
 at drive to 1200 S 119th St.
 39.0' Lt. @ Sta. 112+87.67
 Elev. = 1317.90

BM*4 Found C.O.W. Disc in top E hubguard on S
 end of bridge over Calfskin Creek
 26.75' Lt. @ Sta. 106+04.46
 Elev. = 1325.63

Plot Date: 8/26/2010 2:05:56 PM
 FILE: I:\2005\05789\Plan\05189-pl03.dgn

Revision		By	Date
119TH STREET			
PLAN			
STA. 109+00 TO STA. 115+00			
JAMES L. ARMOUR, P.E. - CITY ENGINEER CITY OF WICHITA PROJECT NO. 472-34850			
Professional Engineering Consultants, P.A. 303 S. TOPEKA - WICHITA, KANSAS 67202 316-262-2691 • FAX 316-262-3003			
Designed by	CKC	Job No.	05789
Drawn by	DRP	Date	August 2010
			Sh. 8 of 152