

COORDINATE TABLE					
POINT NO.	NORTH COORDINATE	EAST COORDINATE	STATION	OFFSET	DESCRIPTION
7039	1,680,107.8640	1,607,566.0629	112+86.57	22.00' Lt.	Edge of Pavement P.I.
7040	1,680,107.2520	1,607,522.0671	112+86.57	22.00' Rt.	Edge of Pavement P.I.
7041	1,680,010.9516	1,607,567.4339	113+83.50	22.00' Lt.	Edge of Pavement P.I.
7042	1,680,010.3292	1,607,523.4383	113+83.50	22.00' Rt.	Edge of Pavement P.I.
7043	1,679,771.0605	1,607,576.8281	116+23.50	28.00' Lt.	Edge of Pavement P.I.
7044	1,679,770.2683	1,607,520.8337	116+23.50	28.00' Rt.	Edge of Pavement P.I.
7045	1,679,782.9080	1,607,473.4873	29+25.00	13.00' Lt.	Edge of Pavement
7046	1,679,756.9176	1,607,474.1935	29+25.00	13.00' Rt.	Edge of Pavement

See Sh. No. 18 for Sidewalk Coordinate Table (Point Nos. 5000-6157)

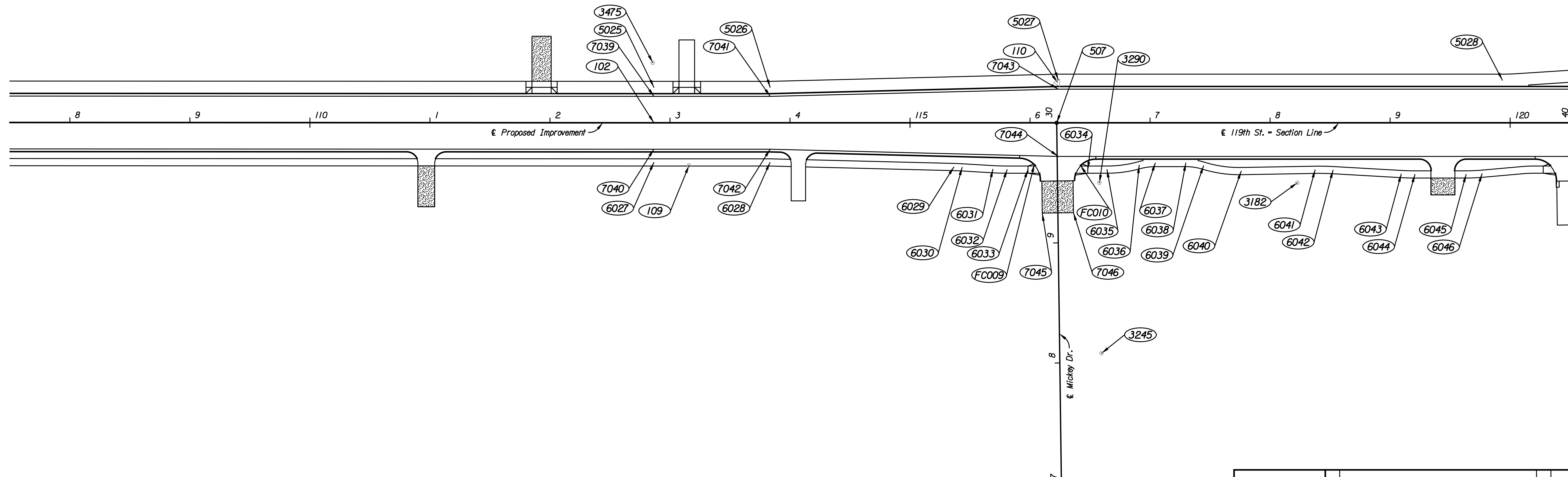

CONTROL POINTS					
POINT NO.	NORTH COORDINATE	EAST COORDINATE	STATION	OFFSET	DESCRIPTION
102	1,680,107.5580	1,607,544.0650	112+86.57	0.00' Rt.	W Corner, Sec. 30, T27S, R1W
109	1,680,077.7408	1,607,508.9692	113+15.89	35.51' Rt.	#4 Bar
110	1,679,771.7089	1,607,582.3002	116+22.93	33.48' Lt.	#4 Bar
507	1,679,771.9497	1,607,548.8127	30+00.00	0.00' Rt.	Mickey Dr.
3182	1,679,570.7561	1,607,501.6860	118+22.72	49.97' Rt.	3/4" Iron Pipe
3245	1,679,731.9196	1,607,357.4777	116+59.53	191.88' Rt.	1/2" Iron Pipe
3290	1,679,735.6889	1,607,499.4377	116+57.77	49.88' Rt.	#4 Bar
3475	1,680,109.1629	1,607,594.0160	112+85.65	49.97' Lt.	#5 Bar



CURVE DATA													
NO.	Δ	R	T	L	E	P.C. COORDINATES		P.I. COORDINATES		P.T. COORDINATES		C.C. COORDINATES	
						NORTH	EAST	NORTH	EAST	NORTH	EAST	NORTH	EAST
FC009	87°49'19" Rt.	18.00'	17.33'	27.59'	6.99'	1,679,802.4722	1,607,519.1830	1,679,785.1448	1,607,518.9950	1,679,784.6741	1,607,501.6729	1,679,802.6675	1,607,501.1841
FC010	90°44'45" Rt.	18.00'	18.24'	28.51'	7.62'	1,679,756.6398	1,607,500.7902	1,679,757.1351	1,607,519.0193	1,679,738.9011	1,607,519.2773	1,679,738.6465	1,607,501.2791

Plotted By: dib Date: 9/7/2010 6:29:11 AM
 FILE: I:\2005\05789\Geometry\05789-Cogol08+00.dgn

No.		Revision		By		Date	
119TH STREET							
COORDINATE GEOMETRY PLAN							
STA. 108+00 TO STA. 120+00							
JAMES L. ARMOUR, P.E. - CITY ENGINEER CITY OF WICHITA PROJECT NO. 472-84850							
Professional Engineering Consultants, P.A. 303 S. TOPEKA - WICHITA, KANSAS 67202 316-262-2691 • FAX 316-262-3003							
Designed by	CKC	Job No.	05789	Sht.		15 of 152	
Drawn by	CP	Date	August 2010				