

RESTHAVEN GARDENS OF MEMORY ADDITION

FLOODWAY RESERVE

Scale: 1"=20'

Sta. 208+40.7 SWS Line No. 200-
Sta. 5+00 SWS Line No. 202-
Sta. 114+25, 29.29' Lt. & 119th St.
Construct R.C. Manhole
L=6'-6" W=6'-6" H=6'-6" H_T=1'-0"
Install 42"x144.0' SWS (RCP) (S)
Install 24"x79.3' SWS (RCP, ACSP or PEP) (W)
w/End Sections (205)
See Sh. No. 54, 57, 58, 60

SCI Kansas
Funeral Services, Inc.
D-61683

Sta. 209+84.7 SWS Line No. 200-
Sta. 5+00 SWS Line No. 203-
Sta. 115+69, 31.14' Lt. & 119th St.
Construct Std. Type I Curb Inlet
L=10'-0" W=5'-0"
Install 42"x96.0' SWS (RCP, ACSP or PEP) (S)
Install 15"x61.3' SWS (RCP) (W)
See Sh. No. 51, 57, 58

Sta. 210+80.7 SWS Line No. 200-
Sta. 5+00 SWS Line No. 204-
Sta. 116+65, 32.50' Lt. & 119th St.
Construct Std. Type I Curb Inlet
L=10'-0" W=5'-0"
Install 7.0 sq. ft. x435.0' SWS (RCPHE) (S)
Install 24"x64.0' SWS (RCP) (W)
See Sh. No. 51, 57, 58

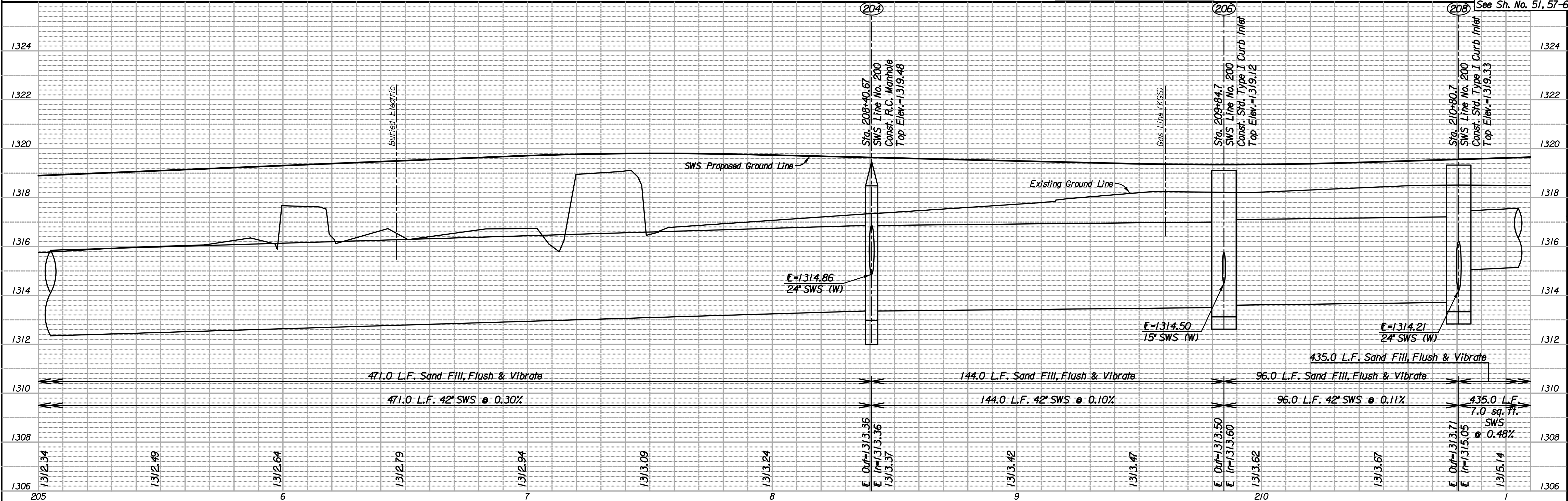
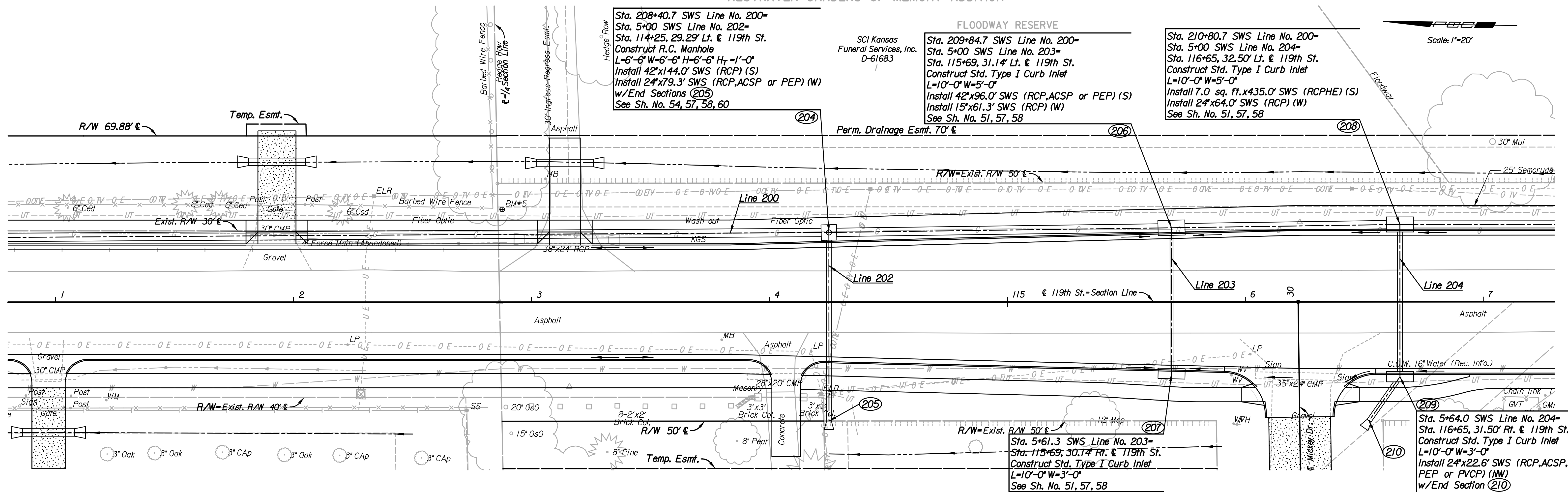

Plotted By: djb Date: 8/26/2010 2:43:46 PM
File: I:\2005\05189\SWS Profile\05189-pr-205.dgn

STORM SEWER PLAN
LINE NO. 200
STA. 205+00 TO 211+00
C.O.W. PROJ. NO. 472-84850

Professional Engineering Consultants, P.A.
303 S. TOPICKA AVENUE, KANSAS CITY, MO 64108
316-266-2891 FAX 316-266-0600
Job No. 05789 Date August 2010
Designed by CKC Drawn by DRP
Sheet 26 of 152