

RESTHAVEN GARDENS OF MEMORY ADDITION  
 SCI Kansas Funeral Services, Inc.  
 D-61683

Scale: 1"=20'

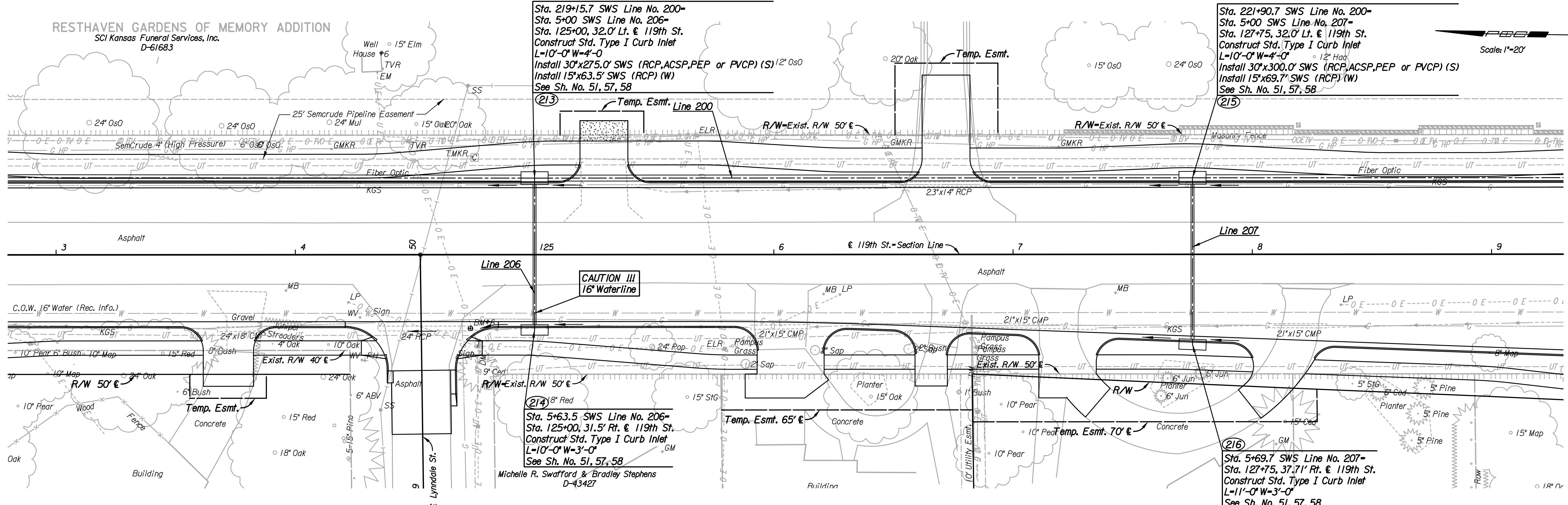

Sta. 219+15.7 SWS Line No. 200-  
 Sta. 5+00 SWS Line No. 206-  
 Sta. 125+00, 32.0' Lt. & 119th St.  
 Construct Std. Type I Curb Inlet  
 L=10'-0" W=4'-0"  
 Install 30"x275.0' SWS (RCP, ACSP, PEP or PVC) (S) 1/2" Os0  
 Install 15"x63.5' SWS (RCP) (W)  
 See Sh. No. 51, 57, 58

Sta. 221+90.7 SWS Line No. 200-  
 Sta. 5+00 SWS Line No. 207-  
 Sta. 127+75, 32.0' Lt. & 119th St.  
 Construct Std. Type I Curb Inlet  
 L=10'-0" W=4'-0"  
 Install 30"x300.0' SWS (RCP, ACSP, PEP or PVC) (S)  
 Install 15"x69.7' SWS (RCP) (W)  
 See Sh. No. 51, 57, 58

Sta. 5+63.5 SWS Line No. 206-  
 Sta. 125+00, 31.5' Rt. & 119th St.  
 Construct Std. Type I Curb Inlet  
 L=10'-0" W=3'-0"  
 See Sh. No. 51, 57, 58

Sta. 5+69.7 SWS Line No. 207-  
 Sta. 127+75, 37.71' Rt. & 119th St.  
 Construct Std. Type I Curb Inlet  
 L=11'-0" W=3'-0"  
 See Sh. No. 51, 57, 58

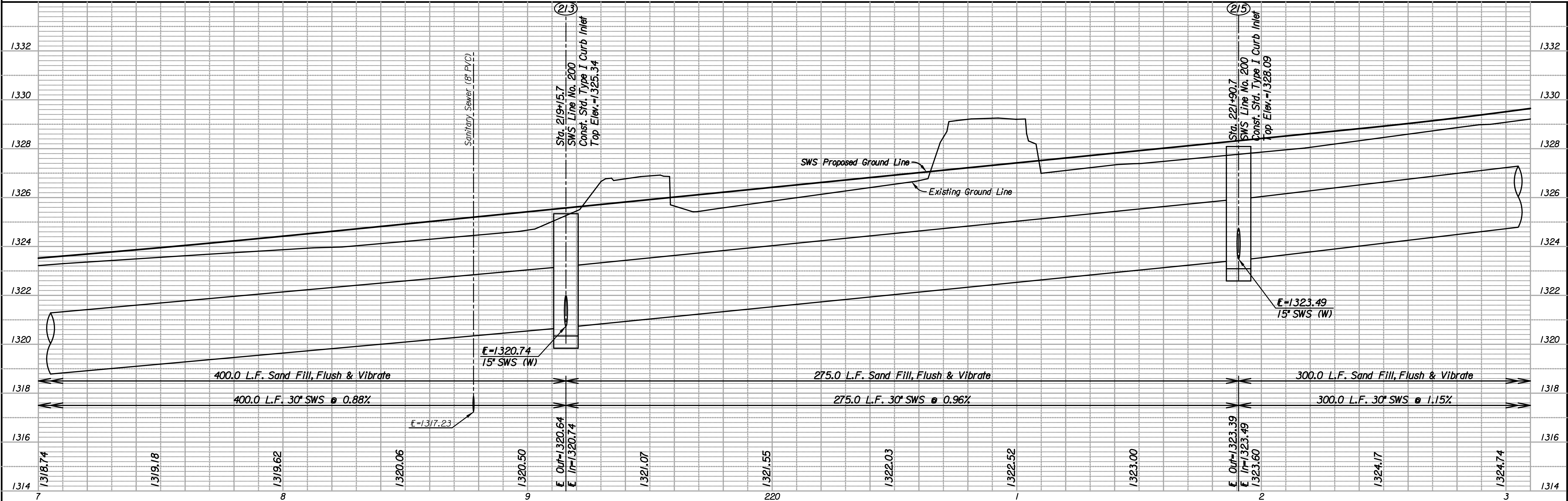

Plotted By: djb Date: 8/26/2010 2:47:09 PM  
 FILE: I:\2005\05789\SWS Profile\05789-pr-217.dgn

STORM SEWER PLAN  
 LINE NO. 200  
 STA. 217+00 TO STA. 223+00

Professional Engineering Consultants, P.A.  
 303 S. TOPEKA AVENUE, SUITE 202  
 TOPEKA, KANSAS 66602  
 316-282-2891 FAX 316-282-0600

Job No. 05789 Date August 2010  
 Designed by CKC  
 Drawn by DRP