

RESTHAVEN GARDENS OF MEMORY ADDITION

SCI Kansas Funeral Services, Inc.
D-61683

Sta. 224+90.7 SWS Line No. 200-
Sta. 5+00 SWS Line No. 208-
Sta. 130+75, 32.0' Lt. of 119th St.
Construct Std. Type I Curb Inlet
L=10'-0" W=4'-0"
Install 30"x260.0' SWS (RCP, ACSP, PEP or PVCP) (S)
Install 15"x81.0' SWS (RCP) (W)
See Sh. No. 51, 57, 58

Sta. 227+50.7 SWS Line No. 200-
Sta. 133+35, 33.40' Lt. of 119th St.
Construct R.C. Manhole
L=5'-6" W=5'-6" H=5'-6" H_T=4'-0"
Install 30"x288.0' SWS (RCP, ACSP, PEP or PVCP) (S)
See Sh. No. 54, 57, 58

Scale: 1"=20'

RESTHAVEN ADDITION

Resthaven Gardens of Memory, Inc.
D-43254

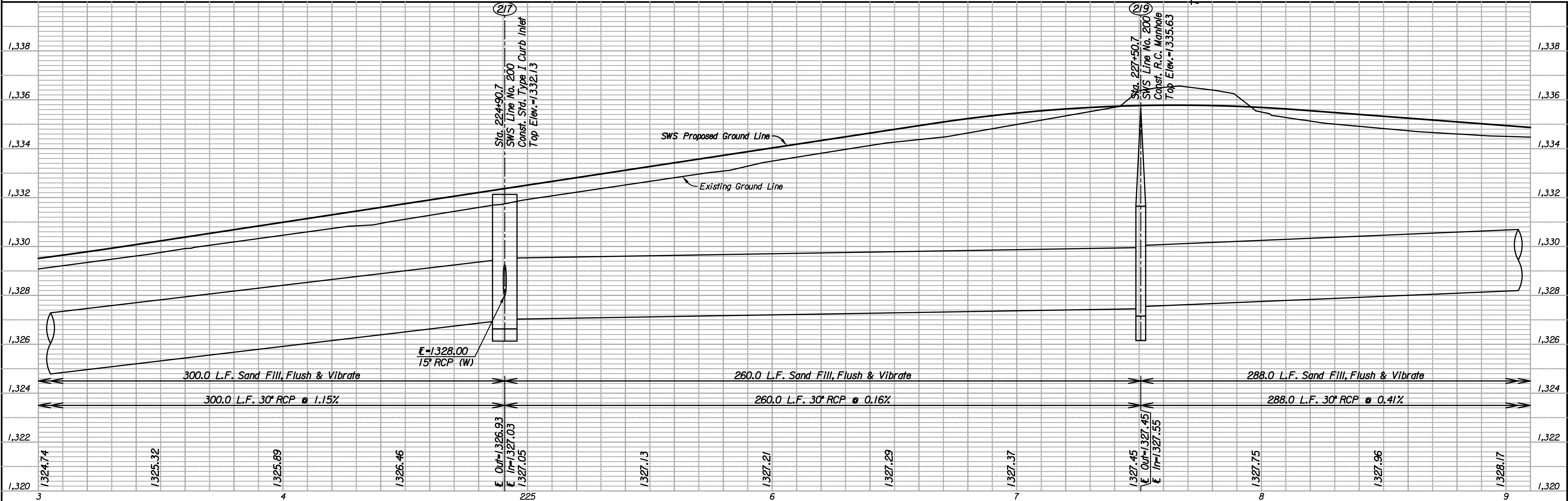
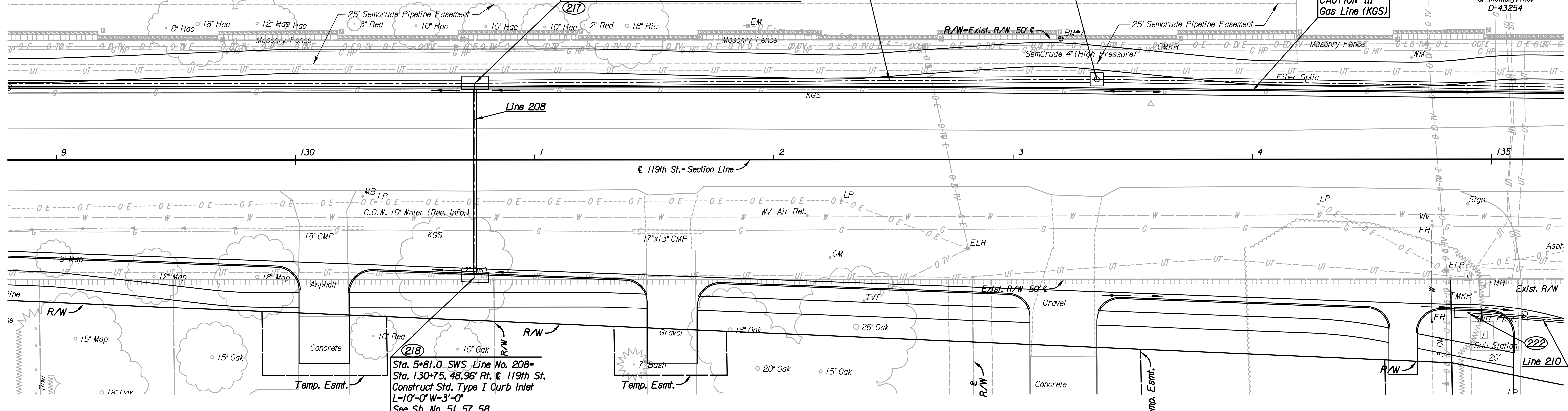

Plotted By: djb Date: 8/26/2010 2:48:25 PM
File: I:\2005\05789\SWS Profile\05789-pr-223.dgn

STORM SEWER PLAN
LINE NO. 200
STA. 223+00 TO STA. 229+00

Professional Engineering Consultants, P.A.
303 S. TORRECA WICHITA, KANSAS 67202
316-268-2891 FAX 316-268-0600

Job No. 05789 Date August 2010
Designed by CKC
Drawn by DRP