

Richard G. Chance
D-568-UP

RESTHAVEN GARDENS OF MEMORY ADDITION
SCI Kansas
Funeral Services, Inc.
D-61683

FLOODWAY RESERVE

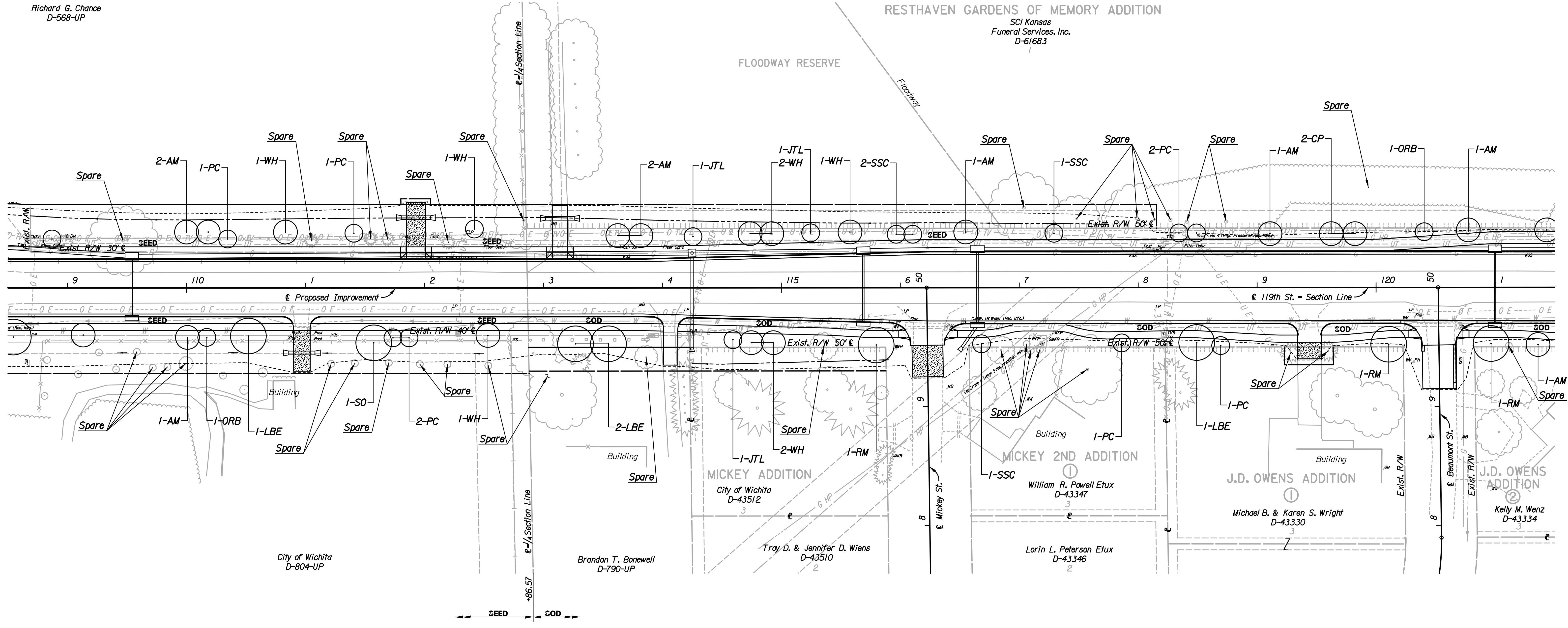

Plotted By: dib Date: 9/7/2010 7:03:19 AM
FILE: I:\2005\05789\landscape\05789-landscape 109.dgn

City of Wichita
D-804-UP

Brandon T. Bonewell
D-790-UP

MICKEY ADDITION
City of Wichita
D-43512

Troy D. & Jennifer D. Wiens
D-43510

William R. Powell Etux
D-43347

Lorin L. Peterson Etux
D-43346

J.D. OWENS ADDITION
Michael B. & Karen S. Wright
D-43330

J.D. OWENS ADDITION
Kelly M. Wenz
D-43334

No.	Revision	By	Date
119TH STREET			
LANDSCAPE PLAN STA. 109+00 TO STA. 121+00			
JAMES L. ARMOUR, P.E. - CITY ENGINEER CITY OF WICHITA PROJECT NO. 472-84850			
Professional Engineering Consultants, P.A. 303 S. TOPEKA - WICHITA, KANSAS 67202 316-262-2691 • FAX 316-262-3003			
Designed by	RMH	Job No.	05789
Drawn by	DRP	Date	August 2010
			Sht. 80 of 152