

DETECTOR SUMMARY							
CAMERA NO.	DETECTION ZONE	MODE	SIZE (LxW)	PHASE CALLED	PHASE EXTENDED	DELAY/STRETCH TIMER	INITIAL SETTING (SEC)
1	D3-2	Pulse	6x6	3	3	S	-
1	D3-3	Presence	70x6	3	3	-	-
1	D8-4	Pulse	6x6	8	8	S	-
1	D8-5	Presence	70x6	8	8	-	-
1	D8-9	Pulse	6x6	8	8	S	-
1	D8-10	Presence	70x6	8	8	-	-
1	D8-11	Presence	70x6	8	8	D	8
2	D1-2	Pulse	6x6	1	1	S	-
2	D1-3	Presence	100x6	1	1	-	-
2	D6-4	Pulse	6x6	6	6	S	-
2	D6-5	Presence	100x6	6	6	-	-
2	D6-9	Pulse	6x6	6	6	S	-
2	D6-10	Presence	100x6	6	6	-	-
3	D7-2	Pulse	6x6	7	7	S	-
3	D7-3	Presence	70x6	7	7	-	-
3	D7-5	Pulse	6x6	7	7	S	-
3	D7-6	Presence	70x6	7	7	-	-
3	D4-4	Pulse	6x6	4	4	S	-
3	D4-5	Presence	70x6	4	4	-	-
3	D4-9	Pulse	6x6	4	4	S	-
3	D4-10	Presence	70x6	4	4	-	-
3	D4-11	Presence	70x6	4	4	D	8
3	D4-12	Presence	24x6	4	4	D	8
4	D5-2	Pulse	6x6	5	5	S	-
4	D5-3	Presence	100x6	5	5	-	-
4	D2-4	Pulse	6x6	2	2	S	-
4	D2-5	Presence	100x6	2	2	-	-
4	D2-9	Pulse	6x6	2	2	S	-
4	D2-10	Presence	100x6	2	2	-	-
4	D2-11	Presence	100x6	2	2	D	8
4	D2-12	Presence	24x6	2	2	D	8
5	D3-1	Pulse	6x6	3	3	S	-
5	D8-1	Pulse	6x6	8	8	S	-
5	D8-2	Pulse	6x6	8	8	S	-
5	D8-3	Pulse	6x6	8	8	S	-
5	D8-6	Pulse	6x6	8	8	S	-
5	D8-7	Pulse	6x6	8	8	S	-
5	D8-8	Pulse	6x6	8	8	S	-
6	D1-1	Pulse	6x6	1	1	S	-
6	D6-1	Pulse	6x6	6	6	S	-
6	D6-2	Pulse	6x6	6	6	S	-
6	D6-3	Pulse	6x6	6	6	S	-
6	D6-6	Pulse	6x6	6	6	S	-
6	D6-7	Pulse	6x6	6	6	S	-
6	D6-8	Pulse	6x6	6	6	S	-
7	D7-1	Pulse	6x6	7	7	S	-
7	D7-4	Pulse	6x6	7	7	S	-
7	D4-1	Pulse	6x6	4	4	S	-
7	D4-2	Pulse	6x6	4	4	S	-
7	D4-3	Pulse	6x6	4	4	S	-
7	D4-6	Pulse	6x6	4	4	S	-
7	D4-7	Pulse	6x6	4	4	S	-
7	D4-8	Pulse	6x6	4	4	S	-
8	D5-1	Pulse	6x6	5	5	S	-
8	D2-1	Pulse	6x6	2	2	S	-
8	D2-2	Pulse	6x6	2	2	S	-
8	D2-3	Pulse	6x6	2	2	S	-
8	D2-6	Pulse	6x6	2	2	S	-
8	D2-7	Pulse	6x6	2	2	S	-
8	D2-8	Pulse	6x6	2	2	S	-

Detector Summary reflects initial operation.

FUNCTION	PHASE TIMING							
	1	2	3	4	5	6	7	8
MINIMUM GREEN	7.0	12.0	7.0	10.0	7.0	12.0	10.0	7.0
MAXIMUM GREEN	34.0	42.0	28.0	32.0	34.0	42.0	32.0	28.0
YELLOW CHANGE	5.0	5.0	4.3	4.3	5.0	5.0	4.3	4.3
RED CLEAR	1.4	1.0	1.5	1.5	1.4	1.0	1.5	1.5
ADDED INITIAL	1.0	1.0	1.0	1.0	1.0	1.0	1.0	1.0
MAXIMUM INITIAL	10.0	15.0	10.0	15.0	10.0	15.0	10.0	15.0

Phase Timing reflects initial operation. Phases 2 & 6 to Dwell on Green.

GENERAL NOTES

All Signal Heads shall have 12" LED lenses.

Placement of Signal Poles, Service/Junction Boxes, Conduit runs and Controller are typical and may be adjusted as directed by the Engineer to facilitate installation.

Utility locations are approximate. The Contractor shall be responsible for locating all underground utilities prior to construction.

*The Contractor shall coordinate with Westar Energy for the exact location of the meter and disconnect box and for the connection of power for the traffic signal installation.

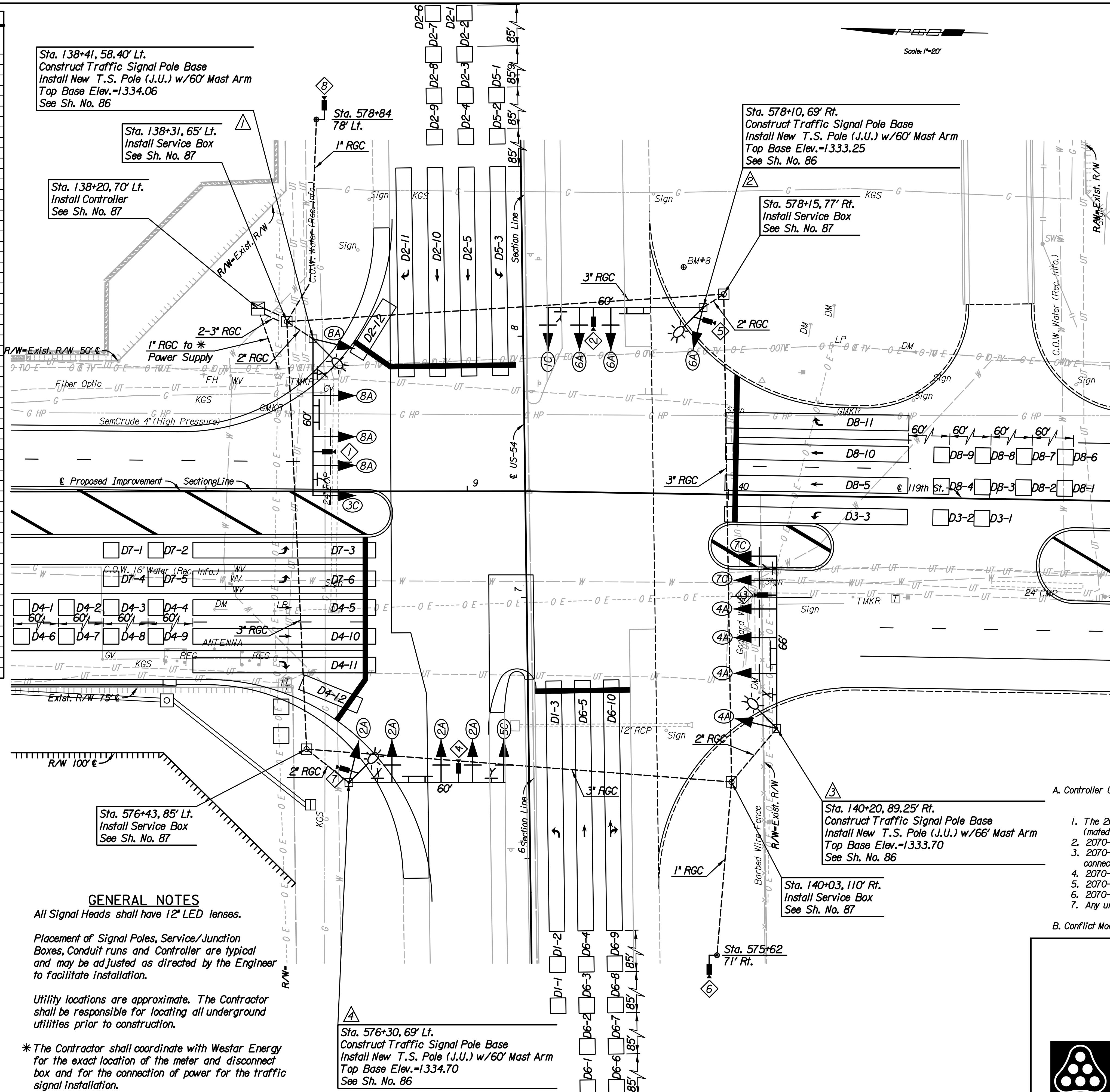

- LEGEND**
- 60' Traffic Signal Pole with Mast Arm & Length
 - Traffic Signal Head
 - Traffic Signal Head with Backplate
 - Traffic Signal Camera
 - Light Pole w/Luminaire Arm and Traffic Signal Camera
 - Pedestrian Signal Head
 - Controller
 - DX(Phase) Detector Zone
 - Service Box (Pre-Fab)
 - R3-5R Sign
 - R10-10 Sign
 - Rigid Galvanized Conduit (RGC)
 - Signal Phase & Head Arrangement
 - Signal Pole Reference Number
 - Traffic Signal Camera Reference Number
 - Street Name Sign
 - Luminaire with Arm
 - Meter and Enclosure

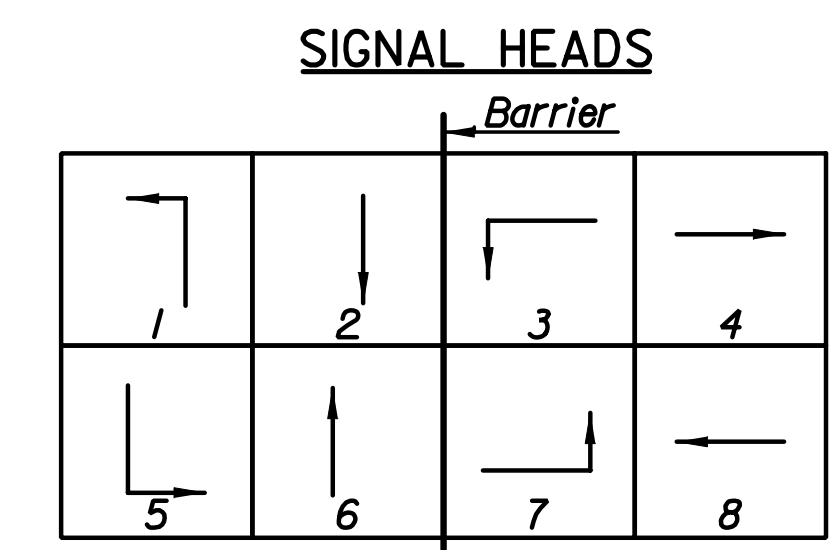
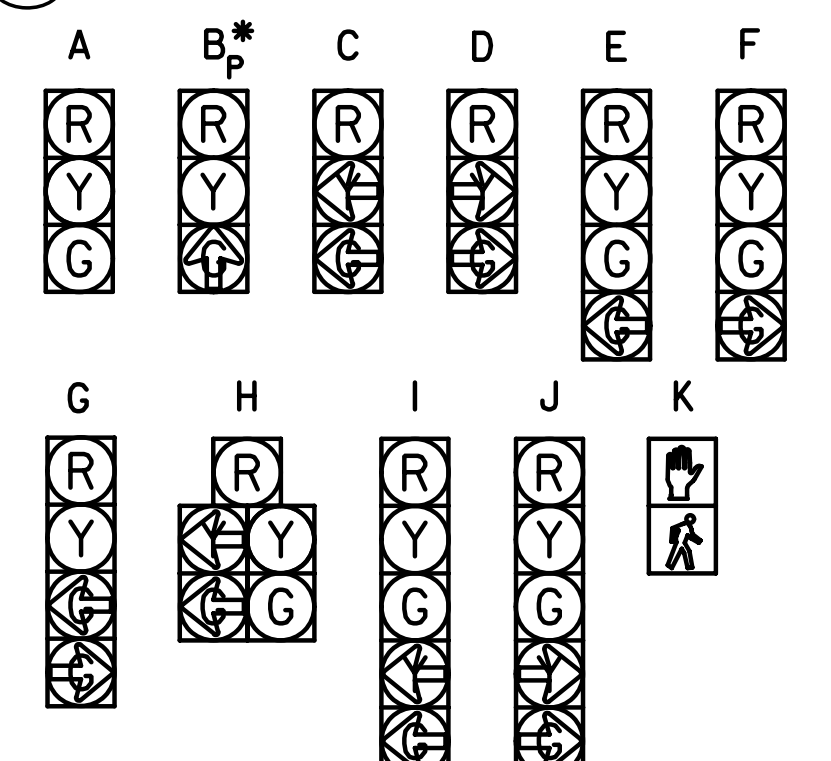

EQUIPMENT SPECIFICATIONS 2070 CONTROLLER

- A. Controller Unit: The 2070L controller supplied shall meet the requirements outlined in CalTrans TEES 2002 (latest revision), and the following requirements:
- The 2070L controller shall have a 19" EIA rack mountable chassis (mated to the 170 cabinet).
 - 2070-1B CPU module with RJ-45 Ethernet port.
 - 2070-2A CI field I/O module for compatibility with CalTrans style CI connector.
 - 2070-3B 8X40 front panel with LCD display.
 - 2070-4A 10 amp power supply.
 - 2070-7A asynchronous serial communications module (RS-232).
 - Any unused slot position shall have a cover plate.
- B. Conflict Monitor: The Conflict Monitor supplied shall be 2010 ECLIP conflict monitor.

No.	Revision	By	Date
119TH STREET			
TRAFFIC SIGNAL PLAN			
119TH STREET AND US-54			
JAMES L. ARMOUR, P.E. - CITY ENGINEER CITY OF WICHITA PROJECT NO. 472-34850			
Professional Engineering Consultants, P.A.			
303 S. TOPEKA - WICHITA, KANSAS 67202 316-262-2691 • FAX 316-262-3003			
Designed by	DRM	Job No.	05789
Drawn by	DRP	Date	August 2010

Plotted By: djb Date: 9/7/2010 7:10:02 AM
 FILE: I:\2005\05789\SIGNAL\05789-SIGNAL-TRAFFIC-SIGNAL.dgn