

Center Sec. 30, 2865, R1W

1/4 Sec. 30, 2865, R1W
#4 Blk of Mothing Cop

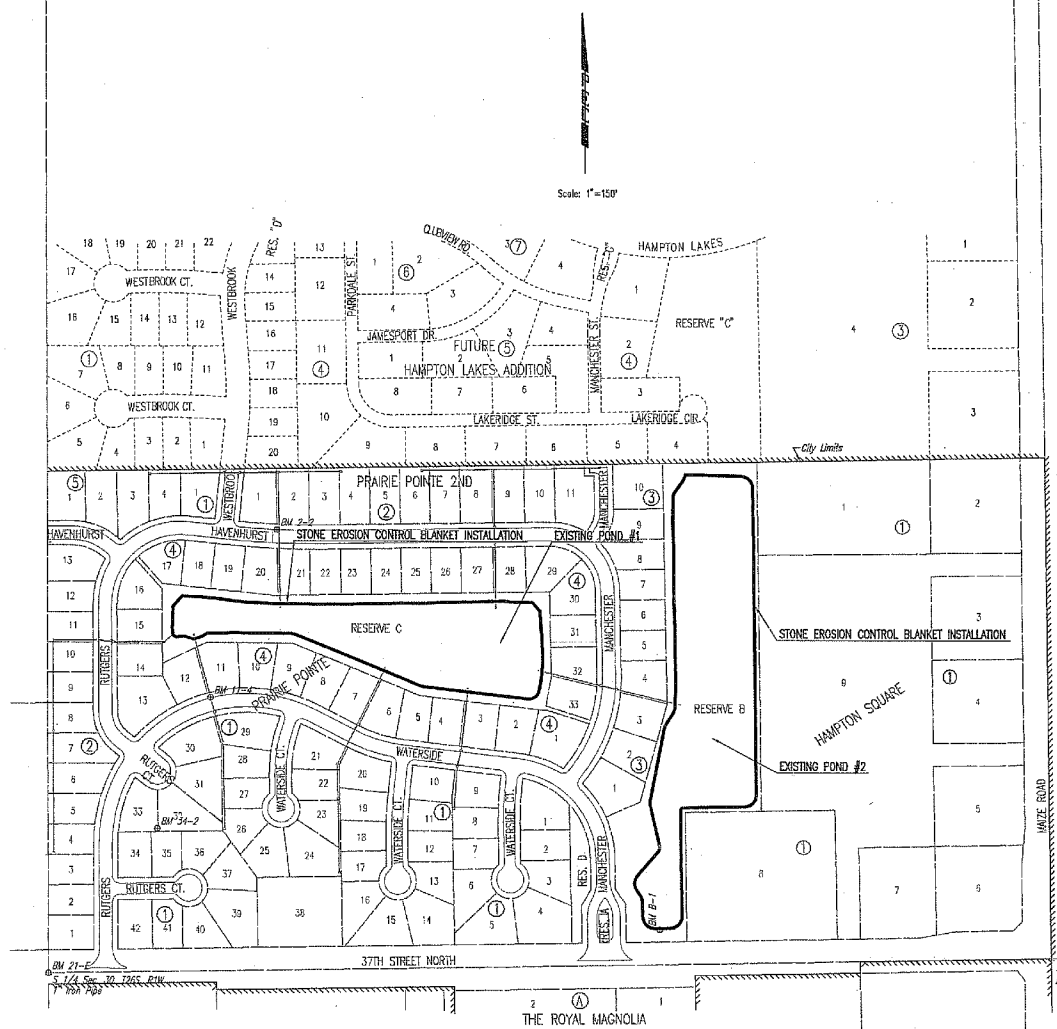

GENERAL NOTES

- UNDERGROUND UTILITY SERVICE LINES AND OVERHEAD UTILITY POLE LINES ARE TO BE ADJUSTED AS NECESSARY BY OTHERS PRIOR TO CONSTRUCTION UNLESS THE PLANS SPECIFICALLY CALL FOR THEIR ADJUSTMENT BY THE CONTRACTOR. EXISTING UTILITIES AND THEIR LOCATION AS SHOWN ON THE PLANS, REPRESENT THE BEST INFORMATION OBTAINABLE FOR DESIGN. LOCATION INFORMATION HAS BEEN OBTAINED FROM THE VARIOUS UTILITY COMPANIES AND IS EITHER FROM COMPANY RECORDED DRAWINGS OR COMPANY PROVIDED FIELD LOCATIONS. THE CONTRACTOR WILL BE REQUIRED TO WORK AROUND EXISTING UTILITIES WITHIN THE RIGHT-OF-WAY WHICH DO NOT COMPLY WITH PROPOSED CONSTRUCTION.
- DEBRIS FROM THE REMOVAL OF MISCELLANEOUS STRUCTURES SHALL BE DISPOSED OF ON SITES TO BE PROVIDED BY THE CONTRACTOR AND APPROVED AS NOTED BELOW.
ALL DISPOSAL SITES MUST BE APPROVED BY THE KANSAS DEPARTMENT OF HEALTH AND ENVIRONMENT. MATERIAL EITHER STOCKPILED OR DISPOSED OF IN A FLOOD PLAIN WOULD REQUIRE A KANSAS STATE BOARD OF AGRICULTURE PERMIT. ANY MATERIAL QUARIED IN WISCONSIN OF THE UNITED STATES OR WISCONSIN IS SUBJECT TO U.S. CORPS OF ENGINEERS PERMITTING REGULATIONS. ANY MATERIAL, BARRIERS OR STOCKPILED BEYOND APPROVED CONSTRUCTION LINES WOULD REQUIRE ADDITIONAL GEOLOGICAL INVESTIGATIONS UNLESS SITED BY A PROBABLY APPROVED BORROW LOCATION.
- CONTRACTOR SHALL SATISFY HIS/HERSELF OF SURFACE AND SUBSURFACE CONDITIONS PRIOR TO BEGINNING.
- CONTRACTOR SHALL PROVIDE A MINIMUM SEVENTY-TWO (72) HOUR ADVANCE NOTICE (INCLUDING WEEKENDS AND HOLIDAYS) PRIOR TO BEGINNING ANY EXCAVATION TO KANSAS ONE-CALL SYSTEM, A UTILITY LOCATION SERVICE, AT (316) 887-2420 TO REQUEST THE FOLLOWING UTILITY COMPANIES TO LOCATE ALL EXISTING LINES WITHIN THE PROJECT AREA: KANSAS NETWORK, WESTAR ENERGY, AT&T, COX COMMUNICATIONS, CITY OF WICHITA SEWER MAINTENANCE AND CITY OF WICHITA WATER DEPARTMENT.
- PRIOR TO CONSTRUCTION, THE CONTRACTOR SHALL RE-ESTABLISH CONTROL POINTS AND BENCH MARKS AND VERIFY THEIR ACCURACY.
- THE CONTRACTOR SHALL ASSUME ALL DISTURBED AREAS TO BE RE-CONSTRUCTION CONDITION ACCORDING TO THE REQUIREMENTS OF CITY OF WICHITA ADMINISTRATIVE REGULATION 70. THIS WORK SHALL BE PAID FOR AS PART OF THE BID ITEM "SITE RESTORATION".

WASTE EXCAVATION

EXCESS EXCAVATED MATERIAL FROM THIS PROJECT SHALL REMAIN ON SITE AND MAY BE WASTED ON UNDEVELOPED LOTS ALONG THE WESTERN EDGE OF THE SUBDIVISION, OUTSIDE STREET RIGHT-OF-WAY AND EASEMENTS, UNFORMALLY SPREADING SUCH MATERIAL AND SLOPING TO DRAIN. PAYMENT FOR PLACING AND SPREADING OF WASTE EXCAVATION SHALL BE SUBSIDIARY TO OTHER CONTRACT ITEMS OF WORK.

EROSION CONTROL

CONTRACTOR SHALL INSTALL SILT FENCE WHERE EVER NECESSARY TO CONTROL EROSION. AN ESTIMATED QUANTITY IS SHOWN IN THE END DOCUMENTS; HOWEVER PAYMENT FOR SILT FENCE WILL BE DETERMINED OR UNDERBID BASED ON MEASURED QUANTITY ACTUALLY INSTALLED ON THE PROJECT.

BENCHMARK LIST

- BM #9-1 - CHISELED "C" ON THE WEST END OF CONCRETE HEADWALL, 63 FEET NORTH OF CENTERLINE OF 37TH STREET NORTH AND 130 FEET EAST OF CENTERLINE OF MANCHESTER STREET AT SOUTH END OF POND.
ELEV. = 168.12
- BM #2-2 - CHISELED "C" ON THE NORTH TOP OF HAVENHURST STREET NEAR THE SOUTHWEST CORNER OF LOT 2, BLOCK 2, PRAIRIE POINTE ADDITION.
ELEV. = 176.77
- BM #11-4 - CHISELED "C" ON CENTER OF CURB INLET ON NORTH SIDE OF WATERBURY STREET NEAR SOUTHWEST CORNER OF LOT 11, BLOCK 4, PRAIRIE POINTE ADDITION.
ELEV. = 172.778
- BM #21-E - CHISELED "C" ON CONCRETE BASE OF BRICK FENCE POST ON SOUTH SIDE OF 37TH STREET NORTH, 440 FEET EAST OF ONE HALF MILE LINE, 300 FEET EAST OF RUTHERS STREET.
ELEV. = 169.61
- BM #34-2 - "T" POST 4 FEET NORTH OF TELEPHONE PEDESTAL NEAR NORTHEAST CORNER OF LOT 34, BLOCK 2, PRAIRIE POINTE ADDITION, 280 FEET EAST AND 100 FEET NORTH OF THE SOUTH QUARTER CORNER, SECTION 30, T8S, R1W. (THIS IS ALSO CONTROL POINT #2330)
ELEV. = 172.455

DEVELOPER CONTACT

MR. MARVIN SCHELLERSBERG
PREMIER REALTY
7926 W. 21st ST. N.
WICHITA, KS 67265
(316) 721-2167

Drawn by: BJS
 Checked by: BJS
 Date: 05/02/2007
 Project: 05-07227-002
 Sheet: 2 of 8

NO.	Revision	BY	Date
HAMPTON SQUARE STORM WATER DRAIN NO. 328 KEY MAP AND GENERAL NOTES JAMES L. ARMOUR, P.E. - CITY ENGINEER CITY OF WICHITA PROJECT NO. LBB-84356 Professional Engineering Consultants, P.A. 505 E. WORTH - WICHITA, KANSAS 67202 316-262-2091 • FAX 316-262-3003			
Designed by	EDB, BMAI	Job No.	05-07227-002
Drawn by	BJS	Date	May 2007
		Sheet	2 of 8