

BENCHMARK:
 BM #2 - Railroad Spike in Wooden Fence Post in the Northwest
 Corner of the City Park Gravel Parking Lot
 Sta. 17+97, 103' Lt.
 Elev. = 1280.15 (MSL)

FHWA REGION NO.	STATE	PROJECT NO.	FISCAL YEAR	SHEET NO.	TOTAL SHEETS
7	KANSAS	87 N-0394-01	2010	30	129

SCALE:
 HORIZONTAL: 1" = 20'
 VERTICAL: 1" = 5'

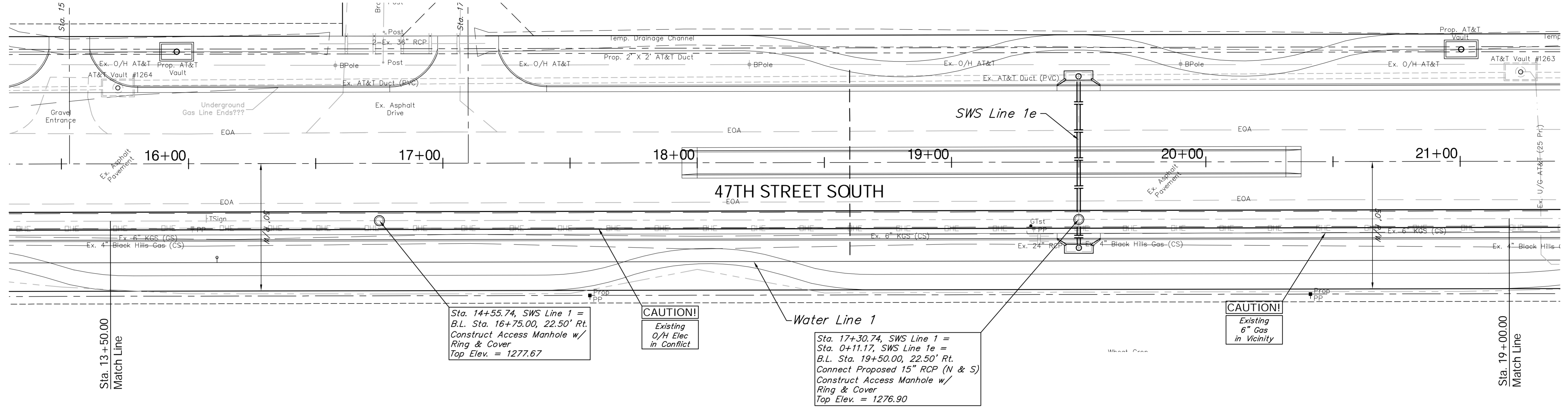

Sta. 14+55.74, SWS Line 1 =
 B.L. Sta. 16+75.00, 22.50' Rt.
 Construct Access Manhole w/
 Ring & Cover
 Top Elev. = 1277.67

CAUTION!
 Existing
 O/H Elec
 in Conflict

Sta. 17+30.74, SWS Line 1 =
 Sta. 0+11.17, SWS Line 1e =
 B.L. Sta. 19+50.00, 22.50' Rt.
 Connect Proposed 15" RCP (N & S)
 Construct Access Manhole w/
 Ring & Cover
 Top Elev. = 1276.90

CAUTION!
 Existing
 6" Gas
 in Vicinity

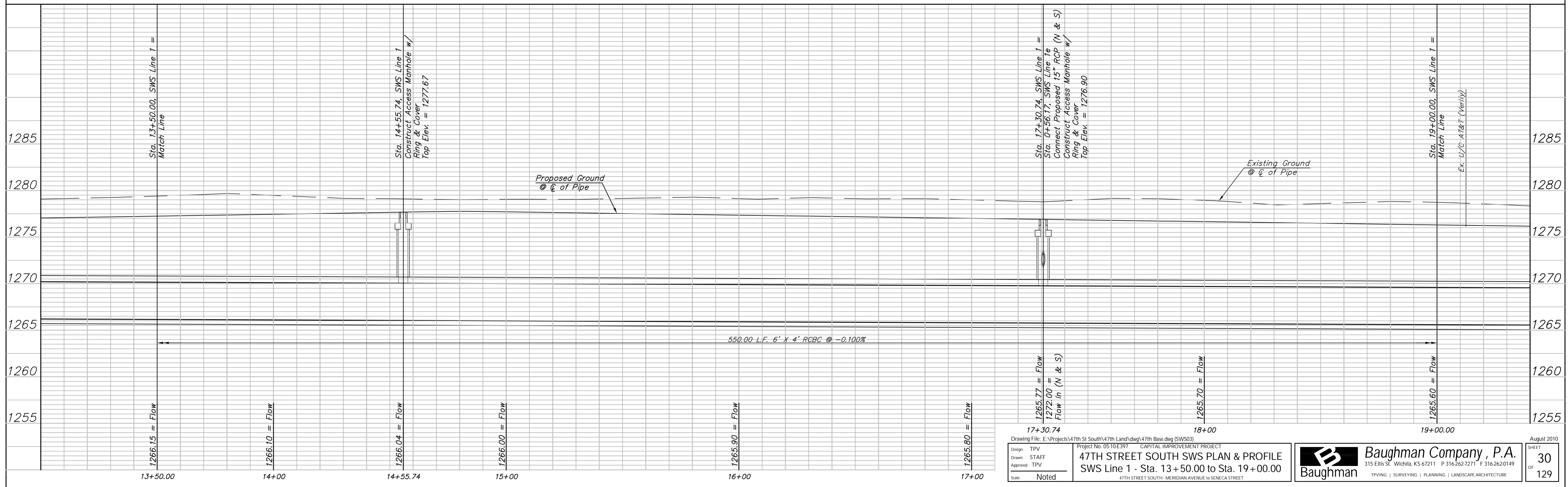

Design: TPV
 Drawn: STAFF
 Approved: TPV
 Scale: Noted

Project No. 05-10-E397 CAPITAL IMPROVEMENT PROJECT
47TH STREET SOUTH SWS PLAN & PROFILE
 SWS Line 1 - Sta. 13+50.00 to Sta. 19+00.00
 47TH STREET SOUTH - MERIDIAN AVENUE to SENECA STREET

Baughman Company, P.A.
 315 Ellis St. Wichita, KS 67211 P 316.262.1271 F 316.262.0149
 TPVING | SURVEYING | PLANNING | LANDSCAPE ARCHITECTURE

August 2010
 SHEET
 OF
 30
 129