

BENCHMARK:
 BM #3 - "I" Cut in the Concrete Base of Metal Fence Post
 28' West of the Fourth Concrete Pillar West of the
 South Lakes Park Entrance
 Sta. 25+86, 54' Rt.
 Elev. = 1277.92 (MSL)

FHWA REGION NO.	STATE	PROJECT NO.	FISCAL YEAR	SHEET NO.	TOTAL SHEETS
7	KANSAS	87 N-0394-01	2010	31	129

SCALE:
 HORIZONTAL: 1" = 20'
 VERTICAL: 1" = 5'

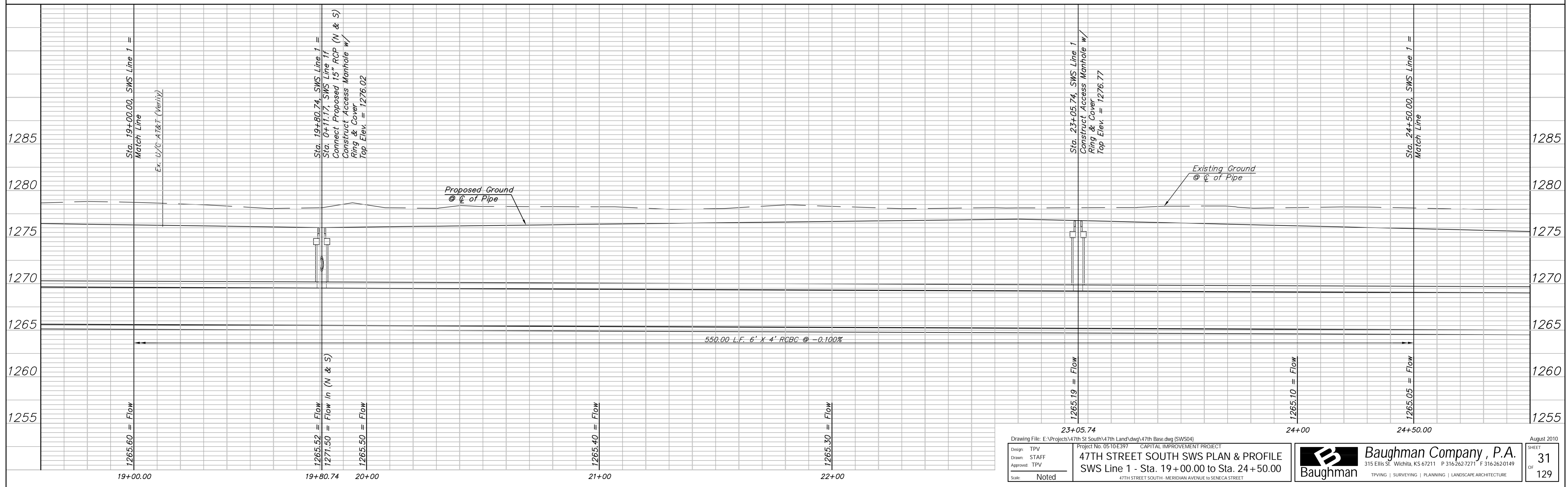
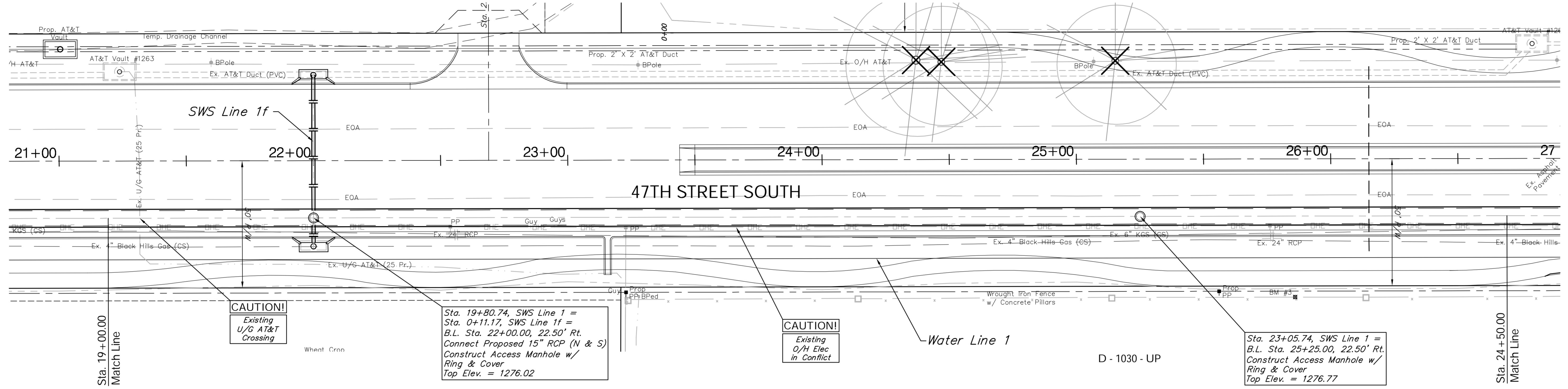

Drawing File: E:\Projects\47th St South\47th Land\dwg\47th Base.dwg [SWS04]
 Project No: 05-10-E397 CAPITAL IMPROVEMENT PROJECT

Design: TPV
 Drawn: STAFF
 Approved: TPV
 Scale: Noted

47TH STREET SOUTH SWS PLAN & PROFILE
 SWS Line 1 - Sta. 19+00.00 to Sta. 24+50.00
 47TH STREET SOUTH, MERIDIAN AVENUE to SENECA STREET

Baughman Company, P.A.
 315 Ellis St., Wichita, KS 67211 P 316-262-7271 F 316-262-0149
 TYPING | SURVEYING | PLANNING | LANDSCAPE ARCHITECTURE

August 2010
 SHEET 31 OF 129