

**BENCHMARK:**  
 BM #6 - Cut into Top of Curb in the Southwest Corner of the Intersection of 47th Street South and Elizabeth Circle  
 Sta. 53+44, 63' Rt.  
 Elev. = 1273.40 (MSL)

FHWA REGION NO.	STATE	PROJECT NO.	FISCAL YEAR	SHEET NO.	TOTAL SHEETS
7	KANSAS	87 N-0394-01	2010	41	129

SCALE:  
 HORIZONTAL: 1" = 20'  
 VERTICAL: 1" = 5'

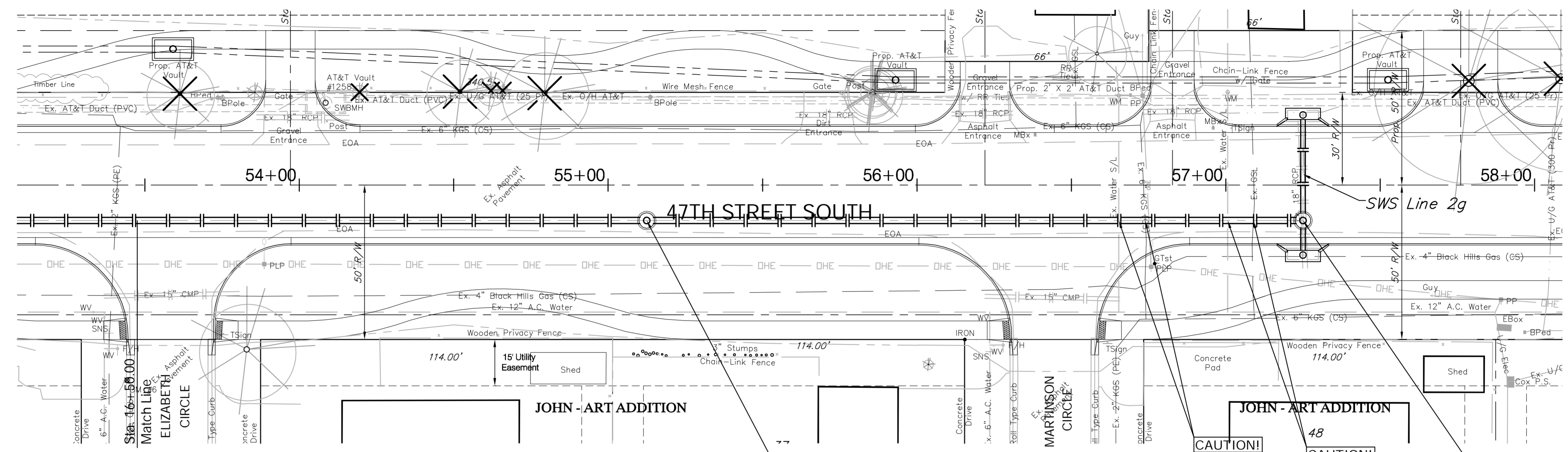

Sta. 18+15.02, SWS Line 2 = B.L. Sta. 55+12.50, 11.50' Rt. Construct Shallow Type "P" Manhole. (5' Dia.) Top Elev. = 1273.53

**CAUTION!**  
 Existing Water S/L  
 6" Gas  
 O/H Elec Crossings

**CAUTION!**  
 Existing Water S/L  
 Gas S/L Crossings

Sta. 20+17.28, End SWS Line 2 = B.L. Sta. 57+25.00, 11.50' Rt. Construct Shallow Type "P" Manhole. (5' Dia.) Top Elev. = 1272.42

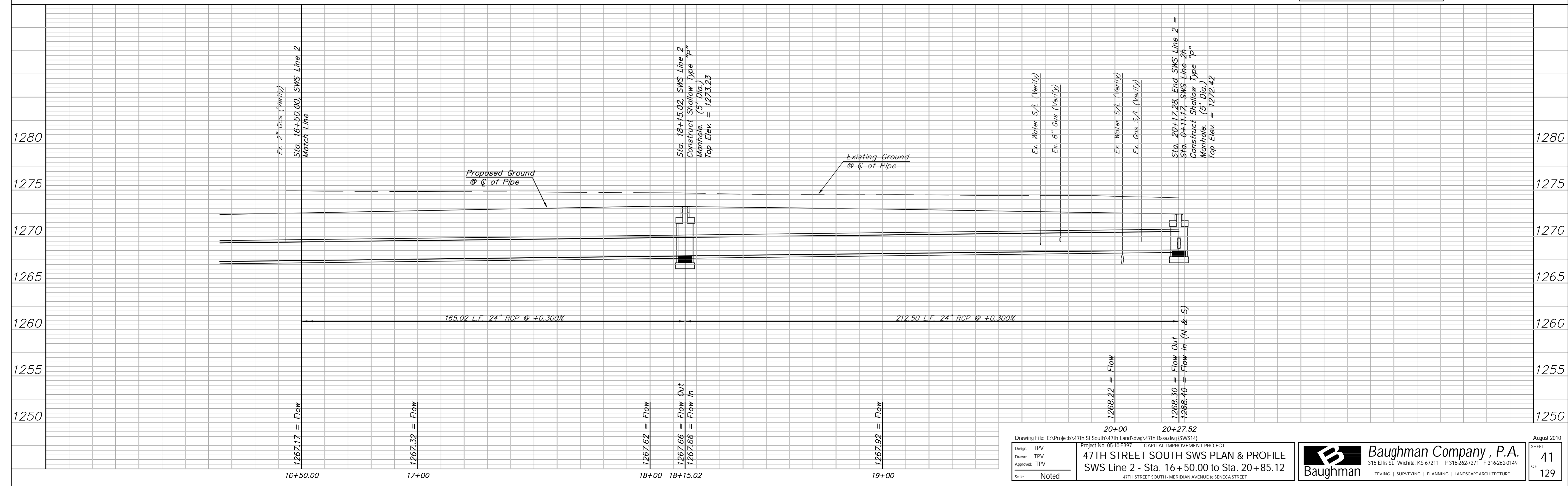

Drawing File: E:\Projects\47th St South\47th Land\dwg\47th Base.dwg (SWS14)  
 Project No: 05-10-E397 CAPITAL IMPROVEMENT PROJECT  
**47TH STREET SOUTH SWS PLAN & PROFILE**  
 SWS Line 2 - Sta. 16+50.00 to Sta. 20+85.12  
 47TH STREET SOUTH - MERIDIAN AVENUE TO SENECA STREET  
 Design: TPV  
 Drawn: TPV  
 Approd: TPV  
 Scale: Noted

**Baughman Company, P.A.**  
 315 Ellis St. Wichita, KS 67211 P 316.262.1271 F 316.262.0149  
 TPVING | SURVEYING | PLANNING | LANDSCAPE ARCHITECTURE

August 2010  
 SHEET  
**41**  
 OF  
**129**