

BENCHMARK:  
 BM #6 -  $\square$  Cut into Top of Curb in the Southwest Corner  
 of the Intersection of 47th Street South and  
 Elizabeth Circle  
 Sta. 53+44, 63' Rt.  
 Elev. = 1273.40 (MSL)

FHWA REGION NO.	STATE	PROJECT NO.	FISCAL YEAR	SHEET NO.	TOTAL SHEETS
7	KANSAS	87 N-0394-01	2010	61	129

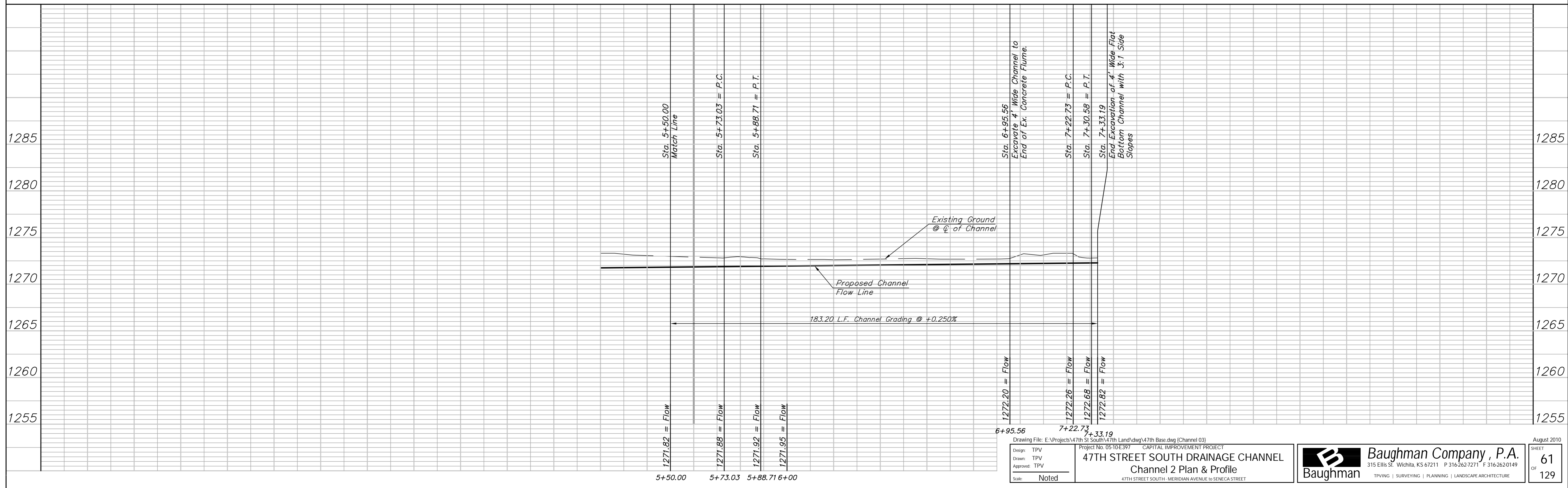
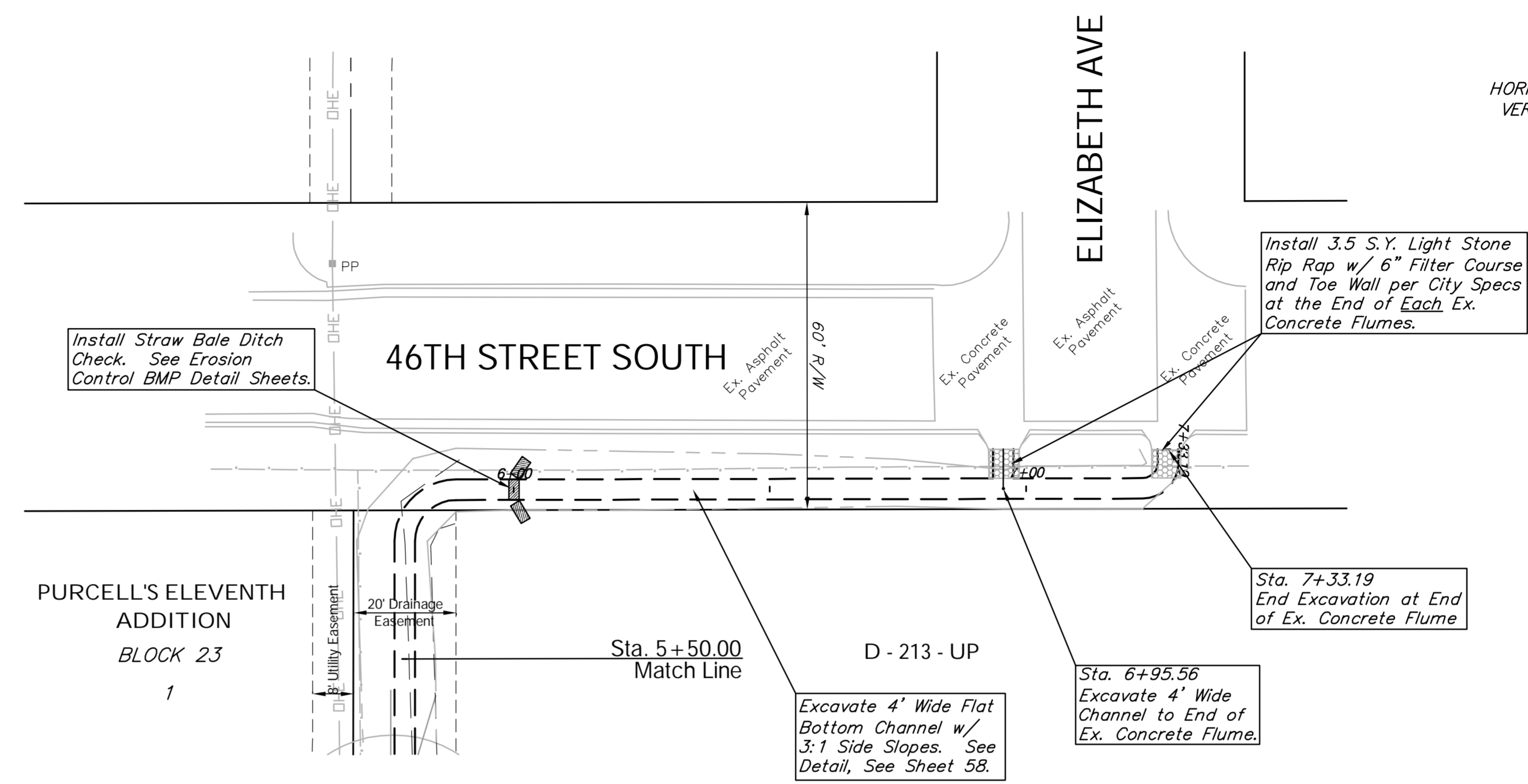
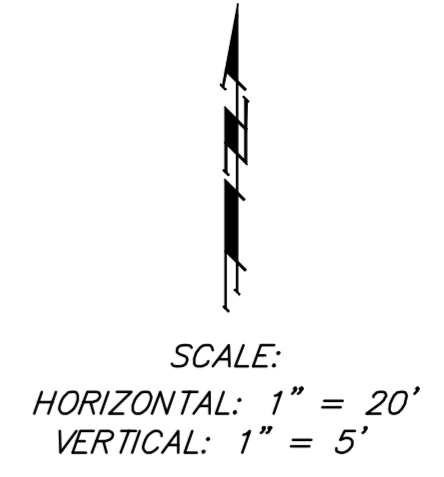

Drawing File: E:\Projects\47th St South\47th Land\dwg\47th Base.dwg (Channel 03)  
 Project No: 05-10-E-397 CAPITAL IMPROVEMENT PROJECT  
**47TH STREET SOUTH DRAINAGE CHANNEL**  
 Channel 2 Plan & Profile  
 47TH STREET SOUTH- MERIDIAN AVENUE TO SENECA STREET

**Baughman Company, P.A.**  
 315 Ellis St., Wichita, KS 67211 P 316-262-7271 F 316-262-0149  
 TPVING | SURVEYING | PLANNING | LANDSCAPE ARCHITECTURE