

BENCHMARK:
 BM #4 - City of Wichita Disc Located in the Northeast Corner of the Intersection of 47th Street South and Clarence Avenue
 Sta. 36+56, 54' Lt.
 Elev. = 1272.50 (MSL)

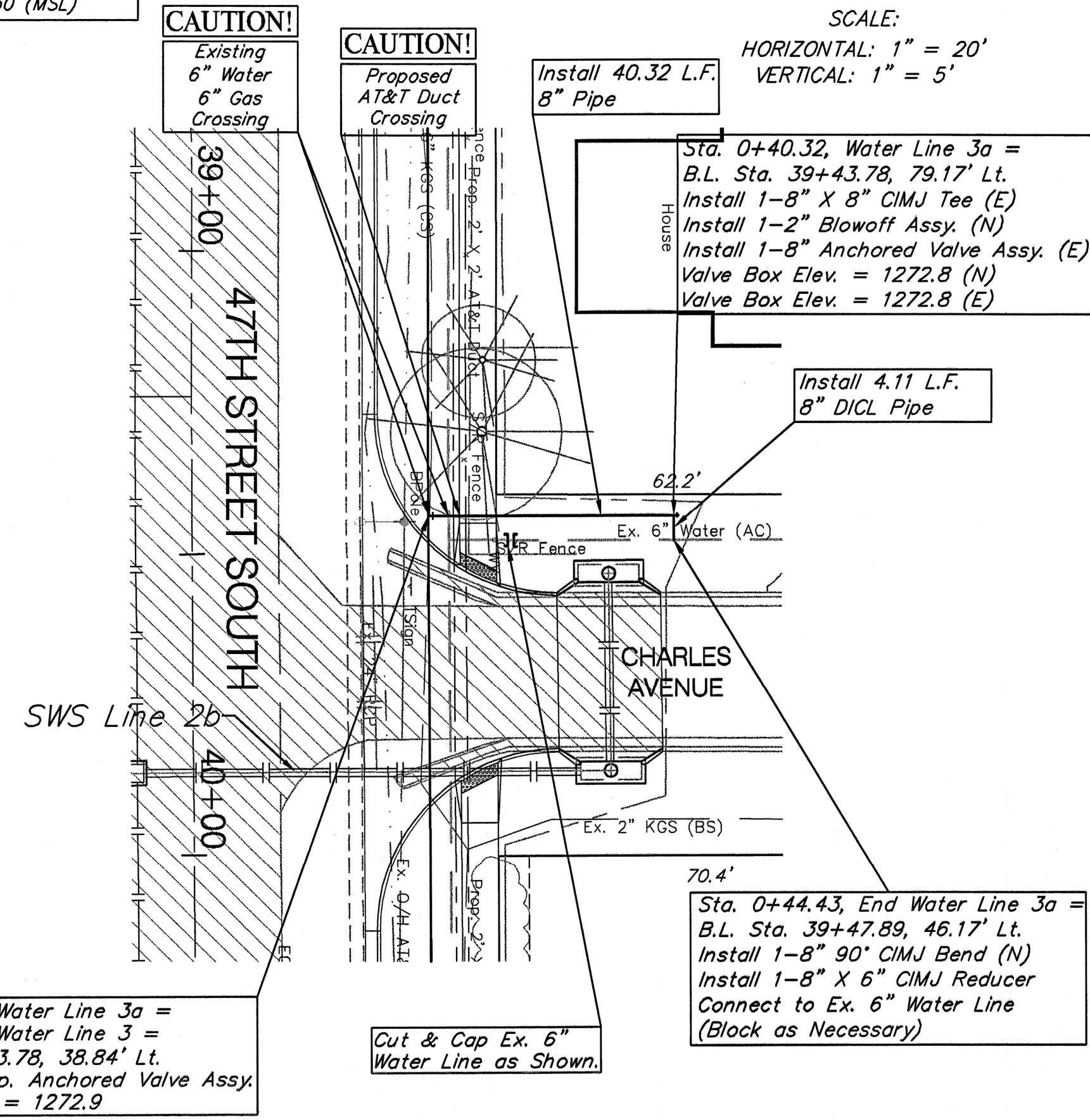

BENCHMARK:
 BM #5 - Cut into Top of Curb in the Northwest Corner of the Intersection of 47th Street South and Vine Avenue
 Sta. 45+17, 66' Lt.
 Elev. = 1272.89 (MSL)

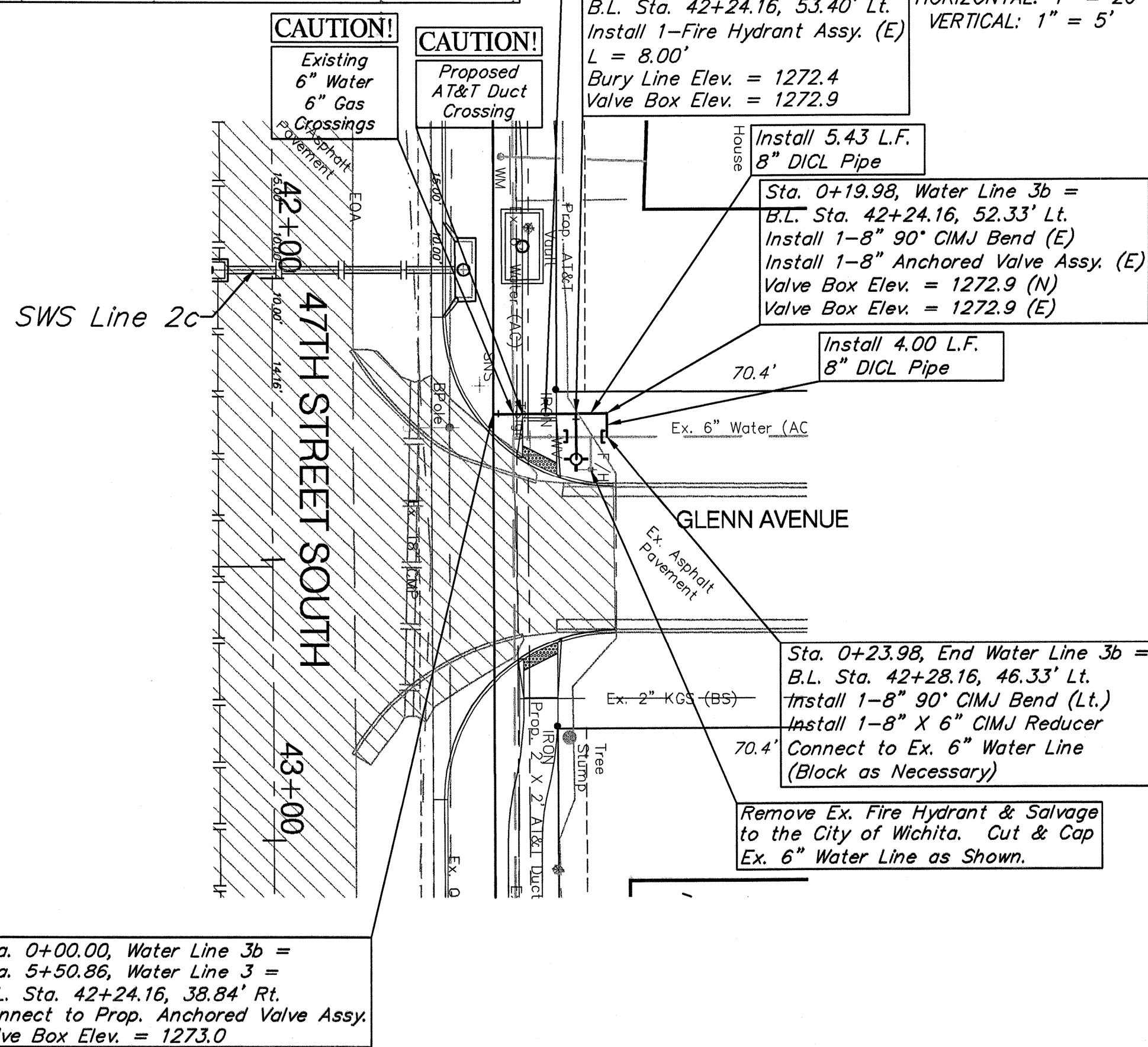

BENCHMARK:
 BM #5 - Cut into Top of Curb in the Northwest Corner of the Intersection of 47th Street South and Vine Avenue
 Sta. 45+17, 66' Lt.
 Elev. = 1272.89 (MSL)

