

FHWA REGION NO.	STATE	PROJECT NO.	FISCAL YEAR	SHEET NO.	TOTAL SHEETS
7	KANSAS	87 N-0394-01	2010	84	129

See Detour Detail Sheet 81 for Detour Signing.

# 47th STREET SOUTH

Contractor to add R1-3 (4-Way) Signs to R1-1 (Stop) Signs at Intersection of 47th Street South & Meridian Avenue Intersection.

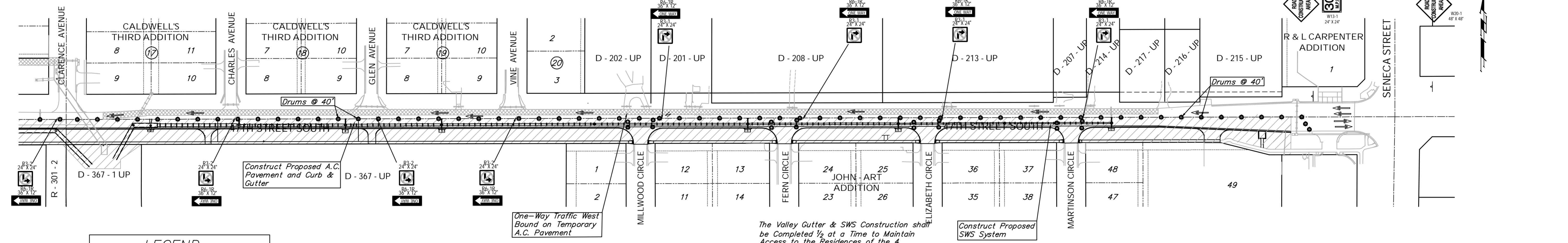
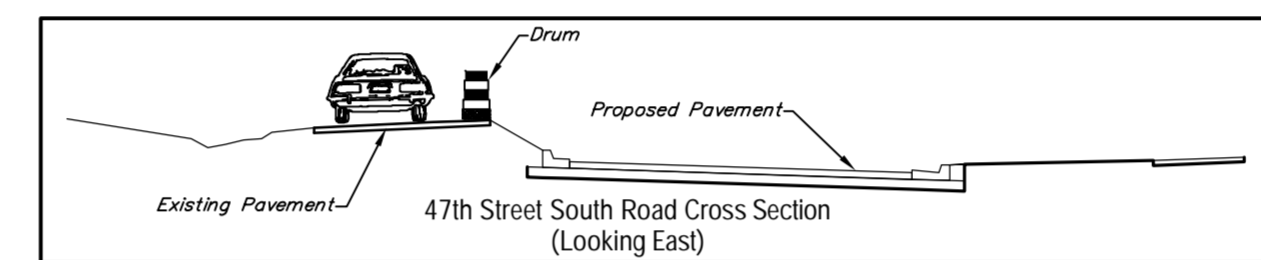
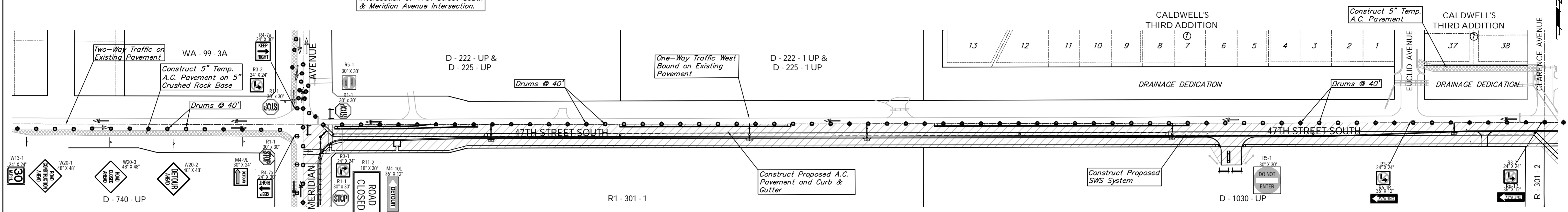

The Valley Gutter & SWS Construction shall be Completed 1/2 at a Time to Maintain Access to the Residences of the 4 Cul-De-Sacs South of 47th Street South.

**LEGEND**

	Work Area		Temp. A.C. Pavement
	Reflectorized Drum (40' Spacing)		
	Tubular Marker (60' Spacing)		
	Type III Barricade		
	Traffic Flow Pattern		

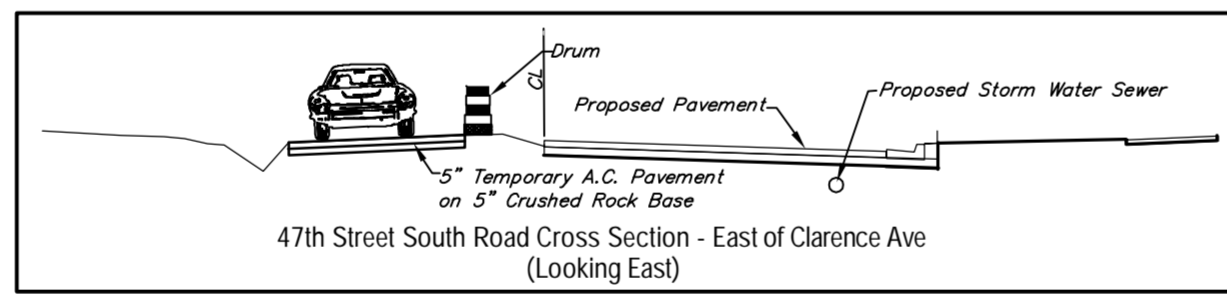

# MERIDIAN AVENUE

**PHASE 2b**

Continue constructing SWS system and new pavement on the south half of 47th Street South from Meridian to Seneca. Move traffic to the west on Meridian and construct the southeast quadrant of the 47th Street South-Meridian intersection. Construct new pavement on the west half of Meridian north of 47th Street South. Construct 11' wide Temporary A.C. Pavement lane on the south side of 47th Street South west of Meridian. Construct 18' wide 5" temporary A.C. Pavement on the north side of 47th Street South between Euclid Ave and Clarence Ave. Begin installation of Signal System at the Intersection. Traffic on 47th Street South between Meridian and Seneca is to be west bound only on existing pavement. Two-way traffic on Meridian is to be carried on both existing and temporary pavement.

**PAVEMENT QUANTITIES FOR PHASE 2b**

5" Temporary A.C. Pavement on 5" Crushed Rock Base - 704 S.Y.
FOR INFORMATION ONLY. Cost to be SUBSIDIARY to the Lump Sum Bid Item "Traffic Control (Construction)."

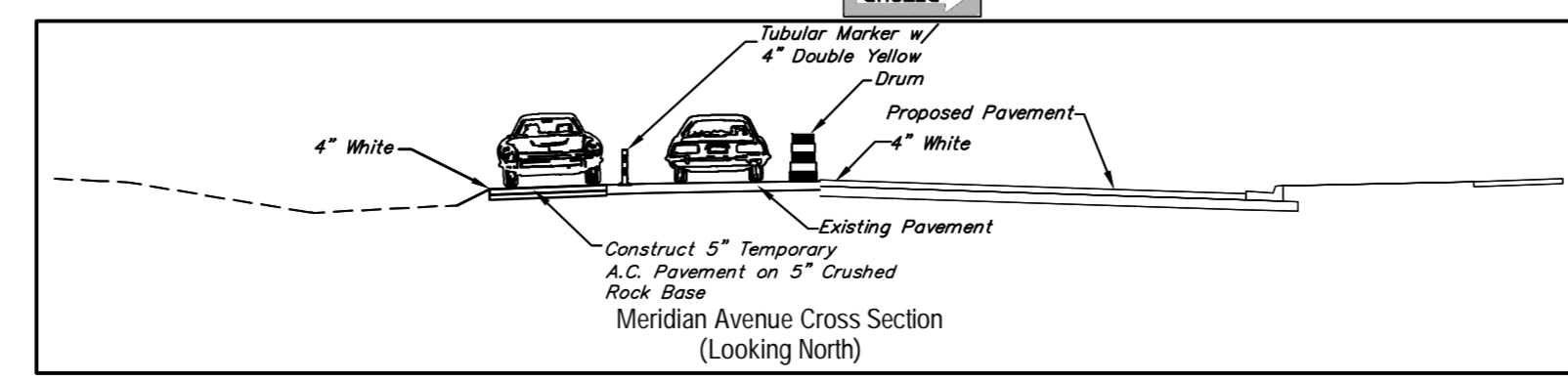
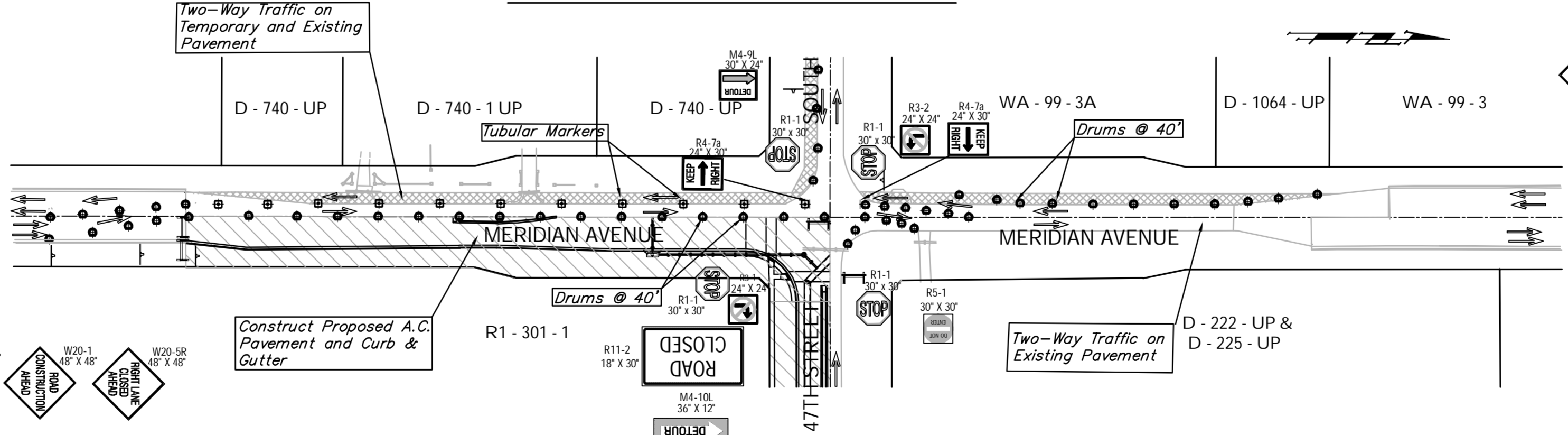

Design: TPV  
 Drawn: STAFF  
 Approved: TPV  
 Scale: 1" = 100'

Project No. 05-10E397 CAPITAL IMPROVEMENT PROJECT  
**47th STREET SOUTH CONSTRUCTION SEQUENCING PLAN - PHASE 2b**  
 47TH STREET SOUTH - MERIDIAN AVENUE TO SENECA STREET

**Baughman Company, P.A.**  
 315 Ellis St., Wichita, KS 67211 P 316-262-1271 F 316-262-0149  
 ENGINEERING | SURVEYING | PLANNING | LANDSCAPE ARCHITECTURE