

FHWA REGION NO.	STATE	PROJECT NO.	FISCAL YEAR	SHEET NO.	TOTAL SHEETS
7	KANSAS	87 N-0394-01	2010	87	129

# 47th STREET SOUTH

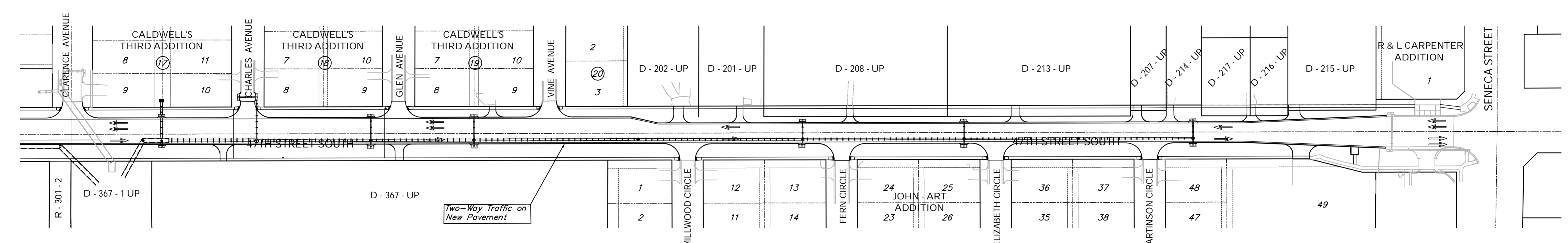
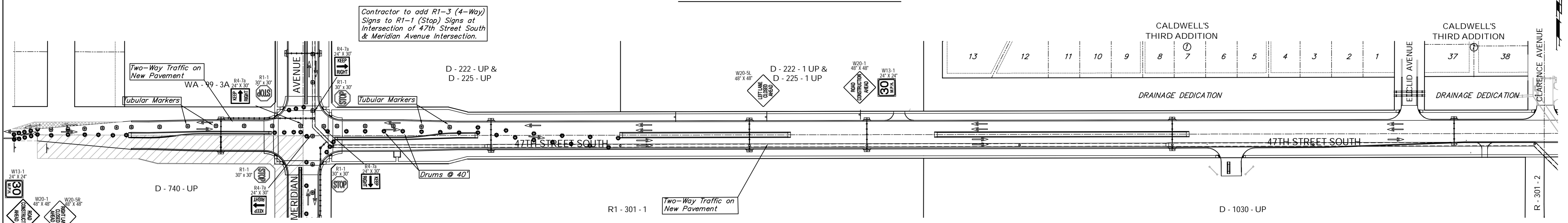

**LEGEND**

	Work Area		Temp. A.C. Pavement
	ReflectORIZED Drum (40' Spacing)		
	Tubular Marker (60' Spacing)		
	Type III Barricade		
	Traffic Flow Pattern		

# MERIDIAN AVENUE

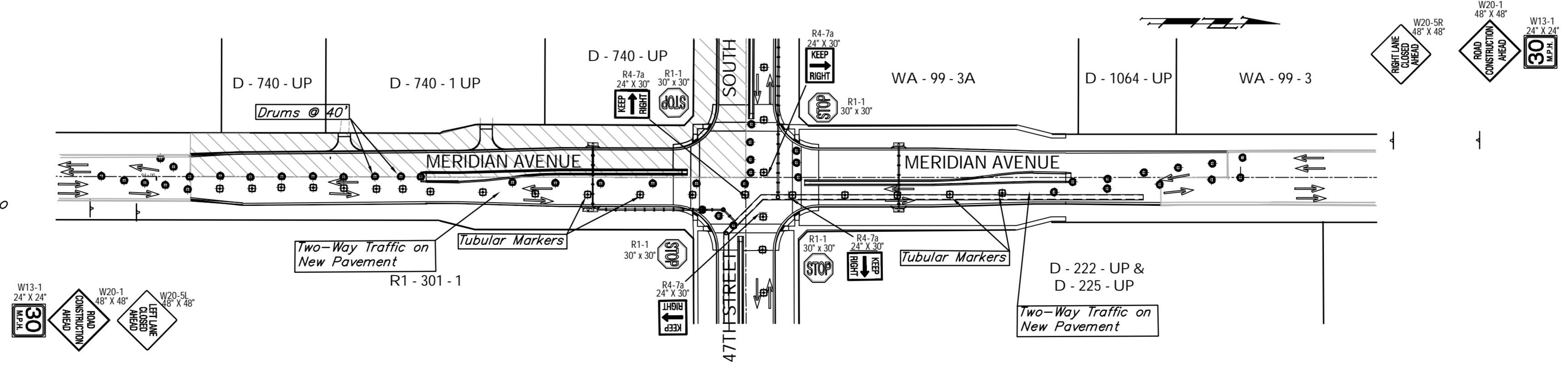

**PHASE 5**

Move traffic on 47th Street South west of Meridian north to the new pavement. Construct the southwest quadrant of the intersection, the south half of the SWS and pavement on 47th Street South west of Meridian, and the west half of the SWS and pavement of Meridian south of 47th Street South. Two-way traffic is to be carried on the new pavement on Meridian and on 47th Street South.

Drawing File: E:\Proj\47th St South\Traffic\47th ConSeq.dwg (Phase 5)  
 Project No. 05-10E397 CAPITAL IMPROVEMENT PROJECT  
**47th STREET SOUTH CONSTRUCTION SEQUENCING PLAN - PHASE 5**  
 47TH STREET SOUTH - MERIDIAN AVENUE TO SENECA STREET

**Baughman Company, P.A.**  
 315 Ellis St. Wichita, KS 67211 P 316-262-7271 F 316-262-0149  
 ENGINEERING | SURVEYING | PLANNING | LANDSCAPE ARCHITECTURE