

STAKING COORDINATE NOTE:
 ALL COORDINATES SHOWN REFERENCE EACH PROPOSED STRUCTURE TO THE PERPENDICULAR DISTANCE FROM THE CENTER OF THE STRUCTURE TO THE CENTER LINE OF PARKWOOD LANE TO THE WEST AND THE CENTERLINE OF E. HARRY STREET TO THE SOUTH.

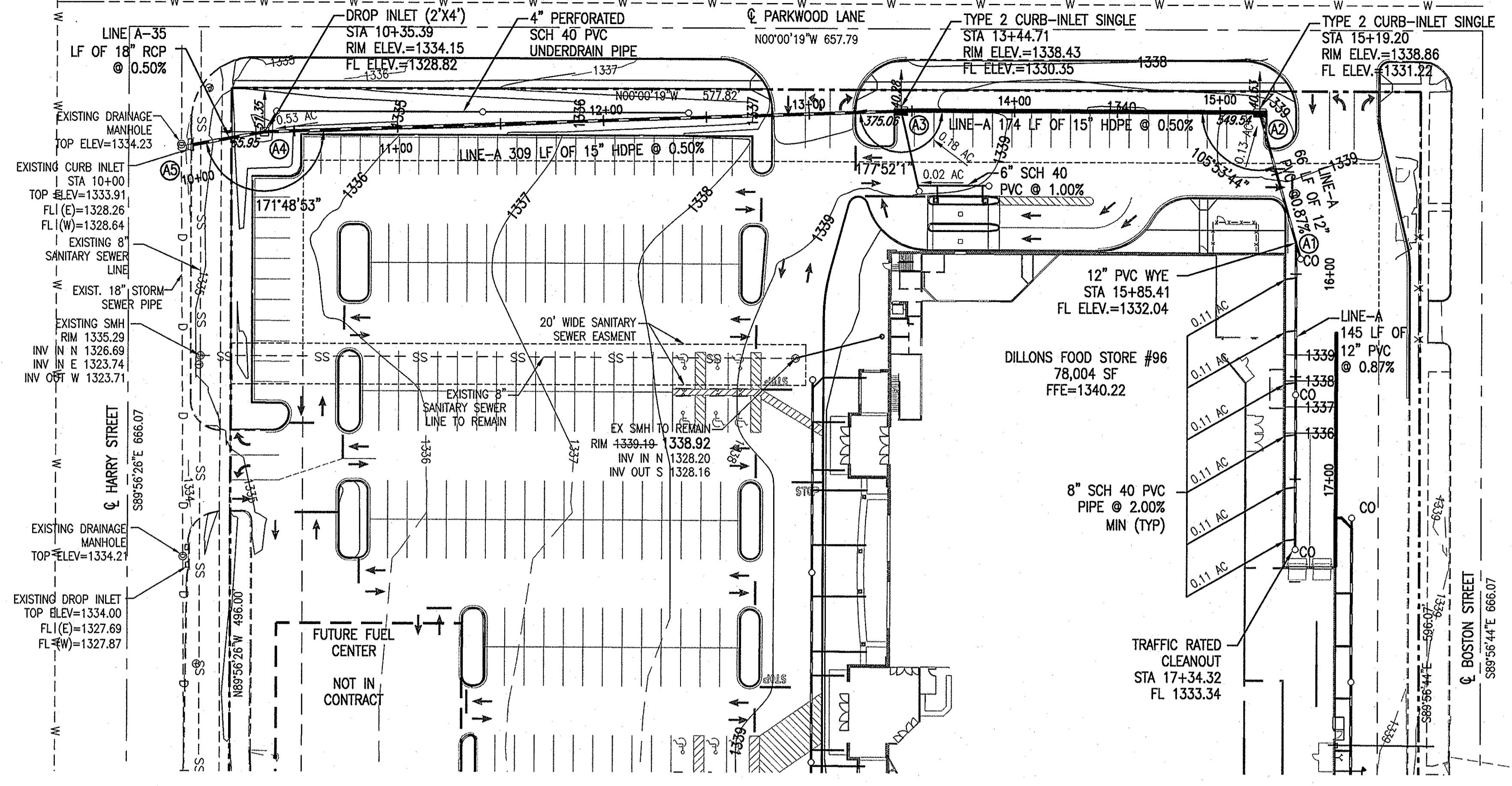

1 LINE A - STORM SEWER PLAN
 SCALE: 1"=40'

STORM DRAINAGE - PIPE DATA

FROM	FLOW LINE ELEV	TO	FLOW LINE ELEV	PIPE DIA (IN)	SLOPE (%)	LENGTH (FT)	DESIGN Q (5 YR) (CFS)	PIPE CAPACITY (CFS)	MAX VELOCITY (FPS)	DRAIN AREA (AC)
A1	1332.04	A2	1331.47	12 PVC	0.87	66	2.80	3.32	4.2	0.66
A2	1331.22	A3	1330.35	15 HDPE	0.50	174	3.35	4.56	3.7	0.79
A3	1330.35	A4	1328.82	15 HDPE	0.50	309	4.20	4.54	3.7	0.99
A4	1328.82	A5	1328.64	18 RCP	0.50	35	6.15	7.49	4.2	1.52
B1	1333.85	B2	1330.53	12 PVC	1.31	253	3.27	4.06	5.2	0.77
B2	1330.53	B3	1329.67	12 PVC	1.31	66	3.27	4.06	5.2	0.77
B3	1329.67	B4	1328.36	15 RCP	1.31	100	4.76	7.36	6.0	1.12

* ALL STORM DRAINAGE PIPES SHALL BE CLASS III RCP, ADS N-12 ST 18 HDPE OR SCH 40 PVC (S12) INSTALLED PER CITY OF WICHITA STANDARD CONSTRUCTION SPECIFICATIONS

STORM DRAINAGE - STRUCTURE DATA

STRUC NO.	STRUCTURE TYPE	GRATE / THROAT ELEV	INVERT	AREA (AC)	Q (5 YR) CFS
A1	WYE	---	1332.04	---	---
A2	TYPE 2 CURB-INLET SINGLE	1338.86	1331.22	0.13	0.55
A3	TYPE 2 CURB-INLET SINGLE	1338.43	1330.35	0.18	0.76
A4	DROP INLET (2'x4')	1334.15	1328.82	0.53	1.95
A5	EXISTING CURB INLET	1333.91	1328.26	---	---
B1	CLEANOUT	1339.50	1333.85	---	---
B2	WYE	---	1330.53	---	---
B3	4" DIA. SHALLOW MANHOLE	1337.35	1329.67	---	---
B4	EXISTING CURB INLET	1335.81	1328.36	---	---

* ALL STORM DRAINAGE STRUCTURES SHALL BE INSTALLED PER CITY OF WICHITA STANDARD CONSTRUCTION SPECIFICATIONS

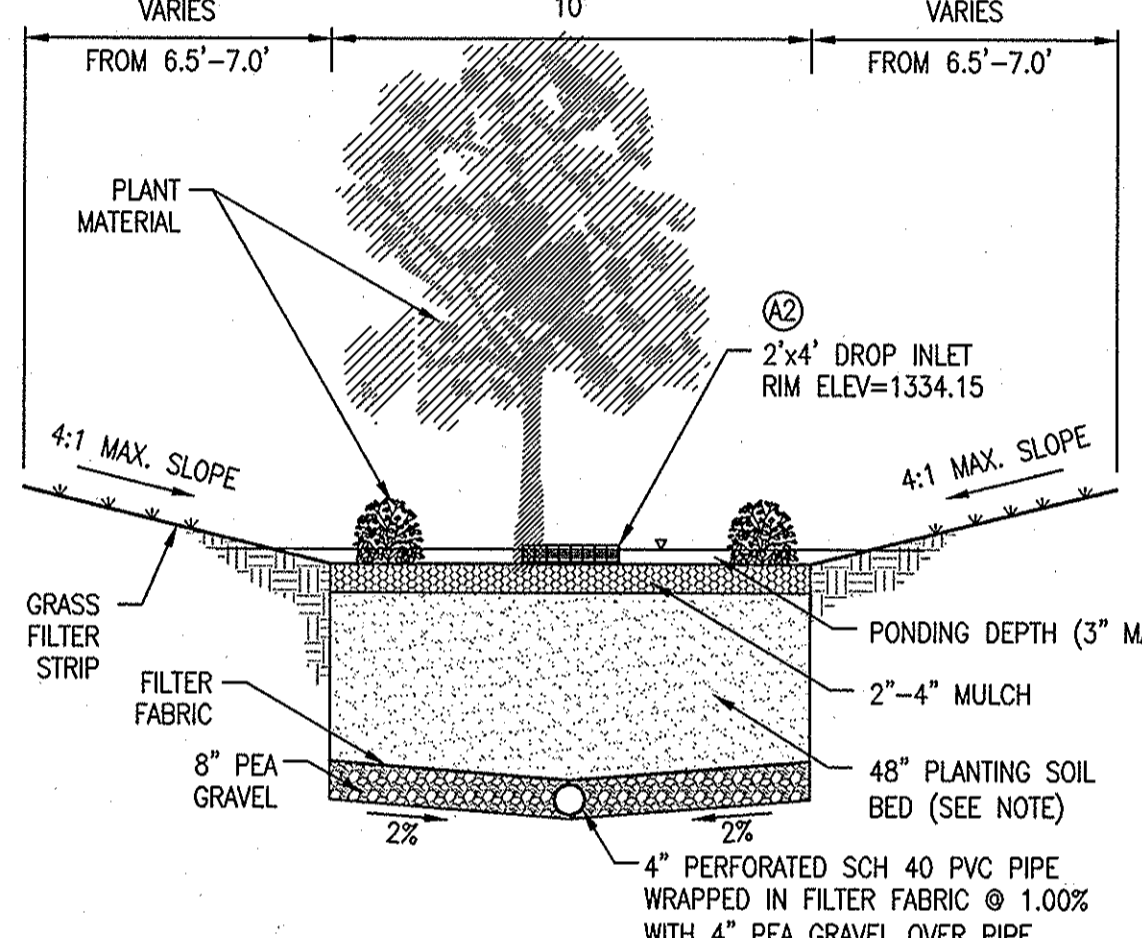

NOTE:
 PLANTING SOILS SHOULD BE SANDY LOAM, LOAMY SAND, OR LOAM TEXTURE WITH A CLAY CONTENT RANGING FROM 5 TO 8%. THE SOIL MUST HAVE AN INFILTRATION RATE OF AT LEAST 0.5 INCHES PER HOUR (1.0 IN/HR PREFERRED) AND A PH BETWEEN 5.5 AND 6.5. IN ADDITION, THE PLANTING SOIL SHOULD HAVE A 1.5 TO 3% ORGANIC CONTENT AND A MAXIMUM 500 PPM CONCENTRATION OF SOLUBLE SALTS.

3 RAIN GARDEN TYPICAL SECTION
 SCALE: NOT TO SCALE

SITE DATA:
 DILLONS STORE #96
 5500 E HARRY ST
 WICHITA, KS 67218
 ZONING: LC (LIMITED COMMERCIAL)
 W/ PROTECTIVE OVERLAY
 PARCEL SIZE: 7.5± ACRES

PICKERING FIRM INCORPORATED UNDERGROUND UTILITIES DISCLAIMER

INFORMATION REGARDING THE REPUTED PRESENCE, SIZE, CHARACTER AND LOCATION OF EXISTING UNDERGROUND UTILITIES AND STRUCTURES RELATED TO UNDERGROUND UTILITIES IS SHOWN HEREON. THERE IS NO CERTAINTY OF THE ACCURACY OF THIS INFORMATION AND IT SHALL BE CONSIDERED IN THAT LIGHT BY THOSE USING THIS DRAWING. THE LOCATION AND ARRANGEMENT OF UNDERGROUND UTILITIES AND STRUCTURES RELATED TO UNDERGROUND UTILITIES SHOWN HEREON MAY BE INACCURATE AND UTILITIES AND STRUCTURES RELATED TO UNDERGROUND UTILITIES NOT SHOWN MAY BE ENCOUNTERED. THE OWNER, HIS EMPLOYEES, HIS CONSULTANTS AND HIS CONTRACTORS SHALL HEREBY DISTINCTLY UNDERSTAND THAT THE ENGINEER IS NOT RESPONSIBLE FOR THE CORRECTNESS OR SUFFICIENCY OF THIS INFORMATION REGARDING THE UNDERGROUND UTILITIES AND STRUCTURES RELATED TO UNDERGROUND UTILITIES SHOWN HEREON.

GRADING AND DRAINAGE NOTES

- SITE PREPARATION SHALL BE DONE IN ACCORDANCE WITH THE GEOTECHNICAL REPORT DATED AUGUST/SEPTEMBER, 2009, PREPARED BY ALLIED LABORATORIES OR THE PROJECT SPECIFICATIONS, WHICHEVER IS MORE STRINGENT.
- IN ALL AREAS OF CONSTRUCTION, TOPSOIL SHALL BE STRIPPED AS REQUIRED BY THE GEOTECHNICAL ENGINEER. THIS TOPSOIL WILL BE USED FOR THE FINISH GRADING WORK. PROVIDE EROSION CONTROL AS NECESSARY TO PREVENT TOPSOIL FROM ERODING AND DAMAGING ADJACENT PROPERTIES.
- CLEAR AND GRUB ALL AREAS OF THE SITE WHERE CUT OR FILL IS TO OCCUR. REMOVE ORGANIC MATTER, FOREIGN MATERIAL, PAVEMENT, TOPSOIL, FENCES, TRASH, BRUSH, BURIED OBSTRUCTIONS SUCH AS TREE STUMPS, ROOTS AND INACTIVE DRAINAGE STRUCTURES. DISPOSE OF ALL MATERIAL REMOVED WHICH IS NOT TO BE REPLACED. BURNING OF MATERIAL ON THE SITE WILL NOT BE PERMITTED UNLESS APPROVED IN WRITING BY THE DESIGNER AND AFTER THE REQUIRED PERMITS HAVE BEEN OBTAINED FROM THE APPLICABLE AUTHORITIES.
- ALL AREAS SHALL BE COMPACTED PER THE RECOMMENDATIONS OF THE GEOTECHNICAL INVESTIGATION PREPARED BY ALLIED LABORATORIES DATED AUGUST/SEPTEMBER, 2009.
- PROPER DRAINAGE SHALL BE MAINTAINED THROUGHOUT THE PROJECT SITE TO PREVENT THE INCREASE OF THE IN-SITU SOILS MOISTURE CONTENT. FLUCTUATIONS MAY NECESSITATE SOIL IMPROVEMENTS PER THE RECOMMENDATIONS OF THE GEOTECHNICAL ENGINEER.
- THE SUBGRADE SHALL BE PROOF-ROLLED WITH A LOADED DUMP TRUCK TO DETECT ZONES OF UNSUITABLE AND/OR EXCESSIVELY WET SOILS.
- SITE CONTRACTOR SHALL PROVIDE SUBGRADE FOR BUILDING PAD PER THE RECOMMENDATIONS OF THE GEOTECHNICAL REPORT PREPARED BY ALLIED LABORATORIES. THE EXPOSED SURFACE IN PAVEMENT OR BUILDING FLOOR AREAS SHALL BE INSPECTED BY THE GEOTECHNICAL ENGINEER AND MAY REQUIRE SOME IMPROVEMENTS IF THE MOISTURE CONTENTS ARE BEYOND ACCEPTABLE LIMITS.
- THE PREPARED SUBGRADE SHALL PROVIDE A MAXIMUM ALLOWABLE BEARING PRESSURE OF 2500 PSF. ALL FOOTING AND FOUNDATION EXCAVATIONS SHALL BE INSPECTED BY THE GEOTECHNICAL ENGINEER BEFORE PLACING FOUNDATIONS.
- ESTABLISH PERMANENT VEGETATION WITH SOD ON ALL DISTURBED AREAS.
- ALL SPOT ELEVATIONS ALONG CURBLINE ARE TOP OF PAVEMENT ELEVATION UNLESS NOTED OTHERWISE.

BENCHMARK:
 SITE TBM: CITY OF WICHITA BENCH MARK DISC. 35.2' EAST OF THE CENTER LINE OF EDGEWOOD 56.70' SOUTH OF THE CENTER LINE OF HARRY 4.50' EAST OF BACK OF CURB 6.50' SOUTH OF BACK OF CURB
 ELEVATION: 1333.00 NGVD29

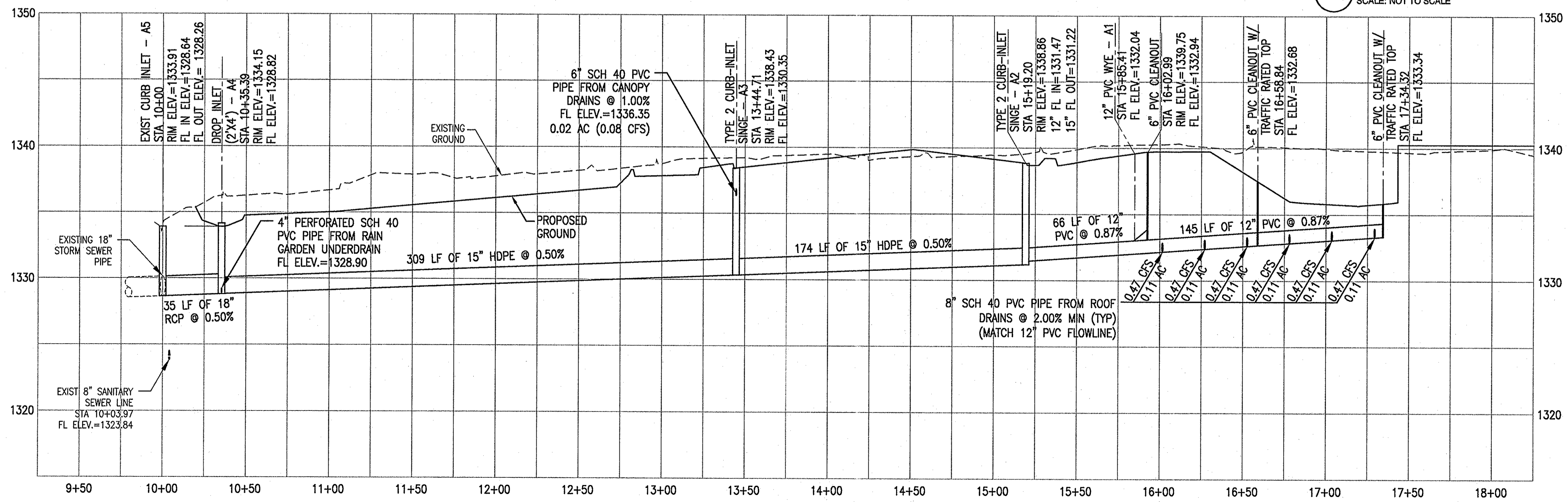

2 LINE A - STORM SEWER PROFILE
 SCALE: 1"=40' HORIZONTAL, 1"=5' VERTICAL

Pickering Firm Incorporated
 Architecture • Engineering • Planning • Surveying
 6775 Lenox Center Court, Suite 300
 Memphis, TN 38116
 901.728.0810

DILLONS FOOD STORE #96
 PROJECT NAME
 LINE A - STORM SEWER PLAN & PROFILE
 SHEET TITLE

GTW	GTW	CLM
02-03-10	21047-08	2 OF 11
DATE	JOB NUMBER	SHEET