

C CURVE DATA						
A=29°58'59" L D=16°22'12.8" R=350.00' L=183.16' T=93.73' E=12.33'						
CURVE DATA BASED ON C radius Δ/2= 14° 59' 29.5"						
STATION	ARC LENGTH	FACE CURB LENGTH		CHORD LENGTH		DEFLECTION ANGLE
		LEFT CURB	RIGHT CURB	B' OFF LEFT FACE CURB	B' OFF RIGHT FACE CURB	
134+80.05						0°00'00.0"
135+00.00	19.95'	19.15'	20.75'	18.69'	21.20'	01°37'58.6"
135+25.00	25.00'	24.00'	26.00'	23.42'	26.57'	02°02'46.6"
135+50.00	25.00'	24.00'	26.00'	23.42'	26.57'	02°02'46.6"
135+75.00	25.00'	24.00'	26.00'	23.42'	26.57'	02°02'46.6"
136+00.00	25.00'	24.00'	26.00'	23.42'	26.57'	02°02'46.6"
136+25.00	25.00'	24.00'	26.00'	23.42'	26.57'	02°02'46.6"
136+50.00	25.00'	24.00'	26.00'	23.42'	26.57'	02°02'46.6"
136+63.20	13.20'	12.68'	13.73'	12.38'	14.04'	01°04'52.5"
TOTAL	183.16'	175.83'	190.48'			14°59'29.5"

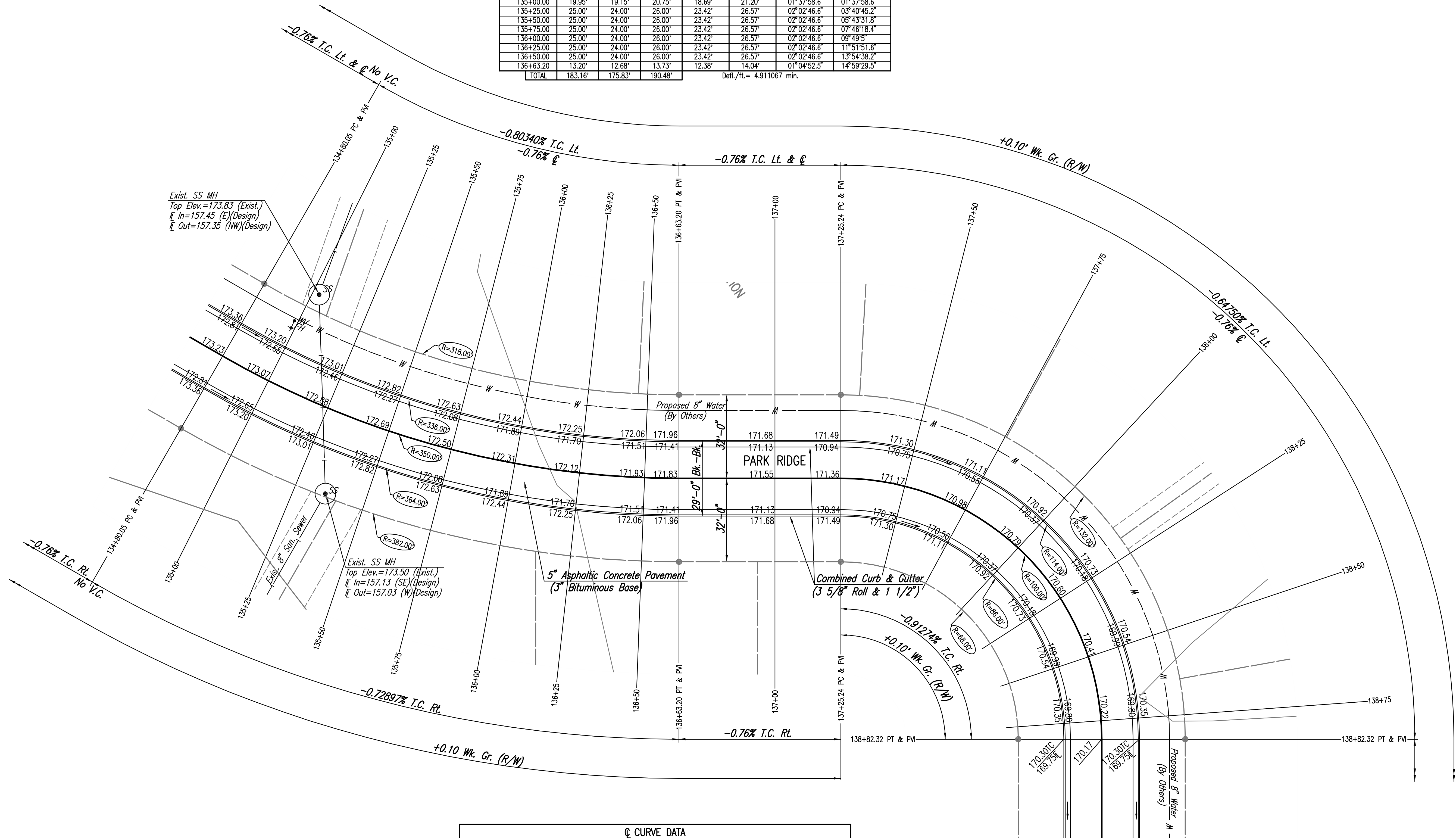
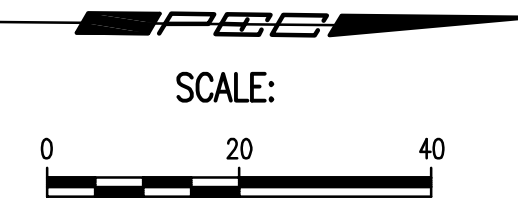

C CURVE DATA						
A=90°0'0" R D=57°17'44.8" R=100.00' L=157.08' T=100.00' E=41.42'						
CURVE DATA BASED ON C radius Δ/2= 45° 0' 0"						
STATION	ARC LENGTH	FACE CURB LENGTH		CHORD LENGTH		DEFLECTION ANGLE
		LEFT CURB	RIGHT CURB	B' OFF LEFT FACE CURB	B' OFF RIGHT FACE CURB	
137+25.24						0°00'00.0"
137+50.00	24.76'	28.23'	21.29'	30.13'	19.26'	07°05'35.8"
137+75.00	25.00'	28.50'	21.50'	30.42'	19.45'	07°09'43.1"
138+00.00	25.00'	28.50'	21.50'	30.42'	19.45'	07°09'43.1"
138+25.00	25.00'	28.50'	21.50'	30.42'	19.45'	07°09'43.1"
138+50.00	25.00'	28.50'	21.50'	30.42'	19.45'	07°09'43.1"
138+75.00	25.00'	28.50'	21.50'	30.42'	19.45'	07°09'43.1"
138+82.32	7.32'	8.34'	8.29'	8.93'	5.71'	02°05'49.3"
TOTAL	157.08'	179.07'	135.09'			45°00'1.1"

NOTE: THIS STREET TO BE CONSTRUCTED WITH ROLL-TYPE CURB. TOP OF CURB ELEVATIONS GIVEN ARE FOR FULL HEIGHT CURB.

Served 09-30-2010 11:58 PM by BJS
 Plot Scale 1:20 11-12-2010 2:29:52 PM by BILL J. SECKSON
 G:\2009\08389\000\08389-000-C-STR-136-138

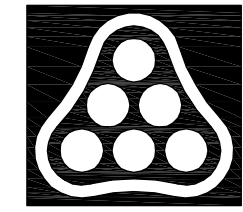

No.	Revision	By	Date
FONTANA 4TH ADDITION-PHASE 1			
PARK RIDGE			
STA. 134+80.05 TO STA. 138+82.32			
JAMES L. ARMOUR, P.E. - CITY ENGINEER			
CITY OF WICHITA PROJ. NO. 472-84800			
Professional Engineering Consultants, P.A.			
303 S. TOPKA • WICHITA, KANSAS 67202			
316-262-2691 • FAX 316-262-3003			
Designed by	BMM	Job No.	35-08389-000
Drawn by	BJS	Date	July 2008
			Sheet 12 of 50