

WATER VALVE BOX ELEVATIONS			
STREET	STATION	OFFSET	PROPOSED ELEVATION
PARK RIDGE	139+34.32	26.0' Lt.	170.0

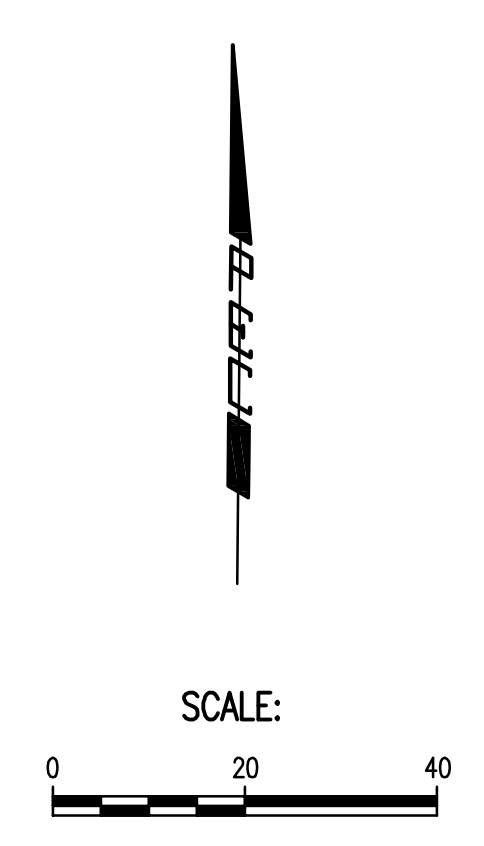
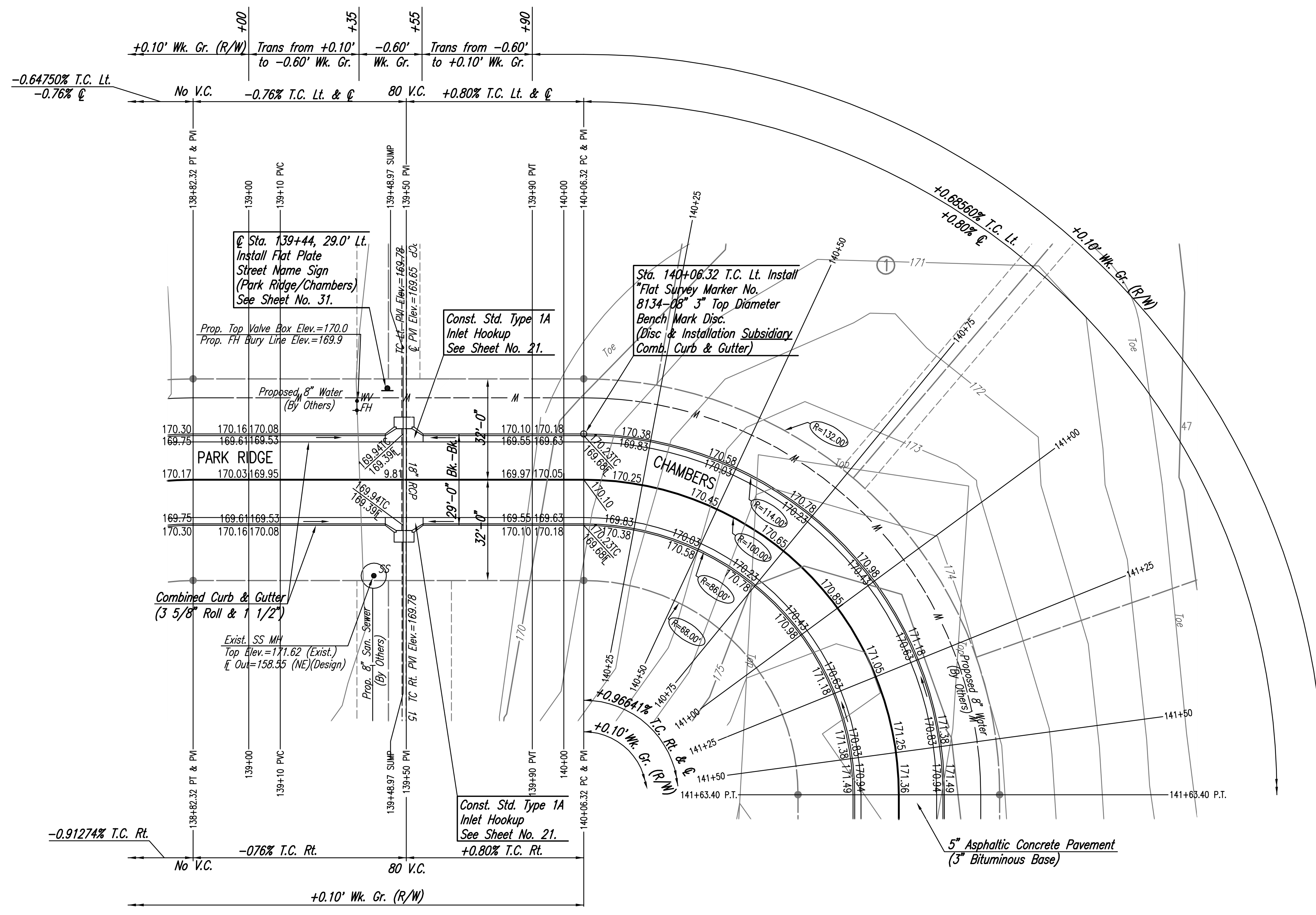

CURVE DATA											
A=90° 0' 0" R		D= 57' 17" 44.8"		R= 100.00'		L= 157.08'		T= 100.00'		E= 41.42'	
CURVE DATA BASED ON @ radius Δ/2= 45° 0' 0"											
@ STATION	@ ARC LENGTH	FACE CURB LENGTH		CHORD LENGTH		DEFLECTION ANGLE	@ TOTAL DEFLECTION				
		LEFT CURB	RIGHT CURB	8' OFF LEFT FACE CURB	8' OFF RIGHT FACE CURB						
140+06.32						0° 00' 00.0"	0° 00' 00.0"				
140+25.00	18.68'	21.30'	16.06'	22.76'	14.55'	05° 21' 05.1"	05° 21' 05.1"				
140+50.00	25.00'	28.50'	21.50'	30.42'	19.45'	07° 09' 43.1"	12° 30' 48.3"				
140+75.00	25.00'	28.50'	21.50'	30.42'	19.45'	07° 09' 43.1"	19° 40' 31.4"				
141+00.00	25.00'	28.50'	21.50'	30.42'	19.45'	07° 09' 43.1"	26° 50' 14.5"				
141+25.00	25.00'	28.50'	21.50'	30.42'	19.45'	07° 09' 43.1"	33° 59' 57.6"				
141+50.00	25.00'	28.50'	21.50'	30.42'	19.45'	07° 09' 43.1"	41° 09' 40.8"				
141+63.40	13.40'	15.28'	11.52'	16.34'	10.44'	03° 50' 19.8"	45° 00' 1.1"				
TOTAL	157.08'	179.07'	135.09'					Defl./ft. = 17.188734 min.			

NOTE: THIS STREET TO BE CONSTRUCTED WITH ROLL-TYPE CURB. TOP OF CURB ELEVATIONS GIVEN ARE FOR FULL HEIGHT CURB.

Served 09-30-2010 1:16:32 PM by BJS
 Plot Scale 1:20 11-12-2010 2:31:11 PM by BILL J. SECKSON
 G:\2009\08389\000\08389-000-C-STR-139-141

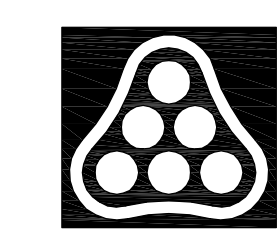

No.	Revision	By	Date
FONTANA 4TH ADDITION-PHASE 1 PARK RIDGE/CHAMBERS STA. 138+82.32 TO STA. 141+63.40 JAMES L. ARMOUR, P.E. - CITY ENGINEER CITY OF WICHITA PROJ. NO. 472-84800			
Professional Engineering Consultants, P.A. 303 S. TOPEKA • WICHITA, KANSAS 67202 316-262-2691 • FAX 316-262-3003			
Designed by	BMM	Job No.	35-08389-000
Drawn by	BJS	Date	July 2008
			Sheet 13 of 50