

Scaled 11-12-2010 3:05:55 PM by BJS  
 Plot Scale 1:40 11-12-2010 4:49:56 PM by BILL J. SECKSON  
 Q:\2009\08389\003\08389-003-C-POND 4-2

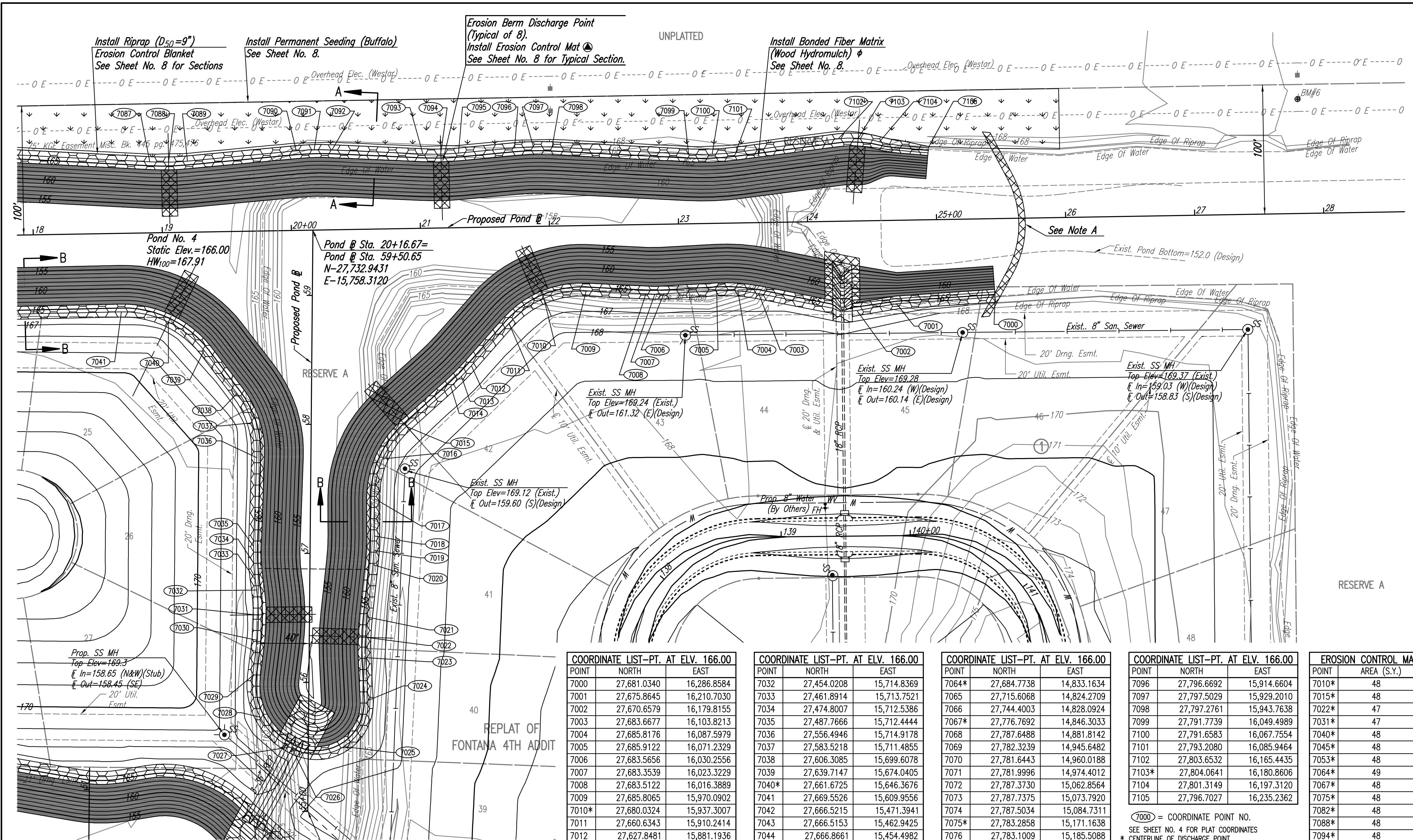

**Note A:** Construct Suitable Cofferdam and Dewater as Necessary to Construct Pond. Cofferdam may be of Compacted Earth Material or Sheet Piles. Upon Completion of Drainage Improvements and Filling of Newly Constructed Ponds, Remove Cofferdam and Restore Pond Banks to Pre-Construction Condition. This work shall be Subsidiary to "Pond Sealing".

**LEGEND**

- RIPRAP (D<sub>50</sub>=9")
- PERMANENT SEEDING
- BONDED FIBER MATRIX
- EROSION CONTROL MAT

⊗ EROSION CONTROL MAT SHALL BE LANDLOK TRM 450, NORTH AMERICAN GREEN C350 OR EQUIVALENT. INSTALLED PER MANUFACTURER'S RECOMMENDATIONS.

PAID FOR AS S.Y. "EROSION CONTROL MAT" AS INDICATED IN PLANS. THE BID PRICE SHALL BE CONSIDERED FULL COMPENSATION FOR ALL MATERIALS, LABOR, EQUIPMENT, TOOLS, AND INCIDENTALS NECESSARY TO COMPLETE THE WORK.

⊕ BONDED FIBER MATRIX (WOOD HYDROMULCH) SHALL BE SPRAYMATT OR APPROVED EQUAL.

PAID FOR AS S.Y. "BONDED FIBER MATRIX" AS INDICATED IN PLANS AND INCLUDES RYEGRASS SEED INSTALLED AT 5 LBS. PER 1,000 SQUARE FEET. THE BID PRICE SHALL BE CONSIDERED FULL COMPENSATION FOR ALL MATERIALS, LABOR, EQUIPMENT, TOOLS, AND INCIDENTALS NECESSARY TO COMPLETE THE WORK.

COORDINATE LIST--PT. AT ELEV. 166.00			EROSION CONTROL MAT	
POINT	NORTH	EAST	POINT	AREA (S.Y.)
7000	27,681.0340	16,286.8584	7096	27,796.6692 15,914.6604
7001	27,675.8645	16,210.7030	7097	27,797.5029 15,929.2010
7002	27,670.6579	16,179.8155	7098	27,797.2761 15,943.7638
7003	27,683.6677	16,103.8213	7099	27,791.7739 16,049.4989
7004	27,685.8176	16,087.5979	7100	27,791.6583 16,067.7554
7005	27,685.9122	16,071.2329	7101	27,793.2080 16,085.9464
7006	27,683.5656	16,030.2556	7102	27,803.6532 16,165.4435
7007	27,683.3539	16,023.3229	7103*	27,804.0641 16,180.8606
7008	27,683.5122	16,016.3889	7104	27,801.3149 16,197.3120
7009	27,685.8065	15,970.0902	7105	27,796.7027 16,235.2362
7010*	27,680.0324	15,937.3007		
7011	27,660.6343	15,910.2414		
7012	27,627.8481	15,881.1936		
7013	27,619.5829	15,873.4419		
7014	27,611.7699	15,865.2345		
7015*	27,580.8230	15,830.8240		
7016	27,555.5005	15,812.4324		
7017	27,524.8769	15,805.9764		
7018	27,495.8048	15,806.0465		
7019	27,484.6635	15,805.7628		
7020	27,473.5552	15,804.8590		
7021	27,432.9938	15,800.4180		
7022*	27,417.3277	15,799.3230		
7023	27,401.6241	15,799.4606		
7024	27,368.4051	15,801.0573		
7025	27,332.6900	15,782.5025		
7026	27,331.1888	15,742.2832		
7027	27,332.2059	15,740.3756		
7028	27,355.4087	15,717.4330		
7029	27,387.5267	15,711.6741		
7030	27,415.0252	15,715.0945		
7031*	27,434.5314	15,716.2383		
7032	27,454.0208	15,714.8369		
7033	27,461.8914	15,713.7521		
7034	27,474.8007	15,712.5386		
7035	27,487.7666	15,712.4444		
7036	27,556.4946	15,714.9178		
7037	27,583.5218	15,711.4855		
7038	27,606.3085	15,699.6078		
7039	27,639.7147	15,674.0405		
7040*	27,661.6725	15,646.3676		
7041	27,669.5526	15,609.9556		
7042	27,666.5215	15,471.3941		
7043	27,666.5153	15,462.9425		
7044	27,666.8661	15,454.4982		
7045*	27,672.4494	15,365.4954		
7046	27,672.7930	15,348.5545		
7047	27,671.7013	15,331.6453		
7048	27,667.9932	15,297.0719		
7049	27,666.8826	15,279.2018		
7050	27,667.3747	15,261.3041		
7051	27,674.3708	15,164.6539		
7052	27,674.8909	15,151.0864		
7053*	27,674.4892	15,137.5148		
7054	27,668.7074	15,046.6446		
7055	27,668.3960	15,027.8723		
7056	27,669.8463	15,009.1536		
7057	27,674.2712	14,973.7319		
7058	27,674.6392	14,968.8589		
7059	27,674.5298	14,963.9732		
7060	27,669.5077	14,893.6335		
7061	27,669.2585	14,887.4863		
7062	27,669.3878	14,881.3354		
7063	27,670.3977	14,861.8526		
7064*	27,684.7738	14,833.1634		
7065	27,715.6068	14,824.2709		
7066	27,744.4003	14,828.0924		
7067*	27,776.7692	14,846.3033		
7068	27,781.6488	14,881.8142		
7069	27,782.3239	14,945.6482		
7070	27,781.6443	14,960.0188		
7071	27,781.9996	14,974.4012		
7072	27,787.3730	15,062.8564		
7073	27,787.7375	15,073.7920		
7074	27,787.5034	15,084.7311		
7075*	27,783.2858	15,171.1638		
7076	27,783.1009	15,185.5088		
7077	27,783.9449	15,199.8302		
7078	27,791.2248	15,276.4443		
7079	27,792.1185	15,296.4751		
7080	27,791.0021	15,316.4947		
7081	27,784.5990	15,376.7572		
7082*	27,783.5395	15,402.7890		
7083	27,785.8729	15,428.7376		
7084	27,790.5362	15,458.6087		
7085	27,792.6648	15,479.1697		
7086	27,792.6599	15,499.8407		
7087	27,785.7925	15,631.9391		
7088*	27,785.5673	15,646.5419		
7089	27,786.4084	15,661.1223		
7090	27,794.3707	15,745.4528		
7091	27,795.1953	15,759.3159		
7092	27,795.0558	15,773.2027		
7093	27,791.9063	15,843.5129		
7094*	27,791.7658	15,857.3546		
7095	27,792.5831	15,871.1729		

See Previous Sheet for Section A-A and Section B-B and Pond Grading Notes and Pond Sealing Notes.

No.	Revision	By	Date
	FONTANA 4TH ADDITION--PHASE 1 STORM WATER DRAIN NO. 282		
<b>GRADING PLAN--POND 4</b>			
JAMES L. ARMOUR, P.E. - CITY ENGINEER CITY OF WICHITA PROJ. NO. 468-84121			
<b>Professional Engineering Consultants, P.A.</b> 303 S. TOPKA • WICHITA, KANSAS 67202 316-262-2691 • FAX 316-262-3003			
Designed by	BMM	Job No.	35-08389-003
Drawn by	BJS	Date	July 2008
			Sheet 9 of 29