

COORDINATE LIST		
POINT	NORTH	EAST
6099	26,594.6379	15,768.3044
6100	26,632.6217	15,815.0557
6101	26,546.4571	15,967.9751
6102	26,545.7222	15,969.2796
6103	26,529.8471	15,997.4537
6104	26,529.1121	15,998.7581
6105	26,513.6066	16,046.6471
6106	26,469.4258	16,125.0566
6107	26,372.3379	16,070.3114

EROSION CONTROL MAT SHALL BE LANDLOK TRM 450, NORTH AMERICAN GREEN C350 OR EQUIVALENT. INSTALLED PER MANUFACTURER'S RECOMMENDATIONS.

PAID FOR AS S.Y. "EROSION CONTROL MAT" AS INDICATED IN PLANS. THE BID PRICE SHALL BE CONSIDERED FULL COMPENSATION FOR ALL MATERIALS, LABOR, EQUIPMENT, TOOLS, AND INCIDENTALS NECESSARY TO COMPLETE THE WORK.

6099 = COORDINATE POINT NO.  
SEE SHEET NO. 4 FOR PLAT COORDINATES

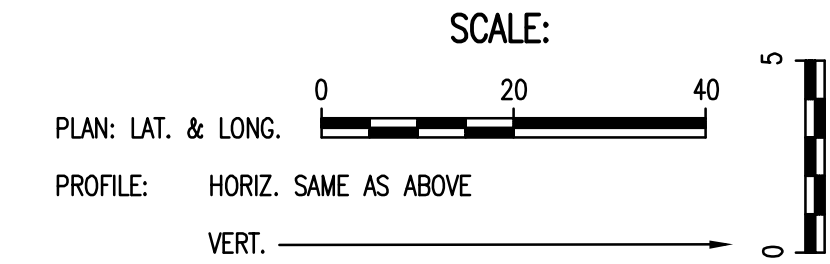
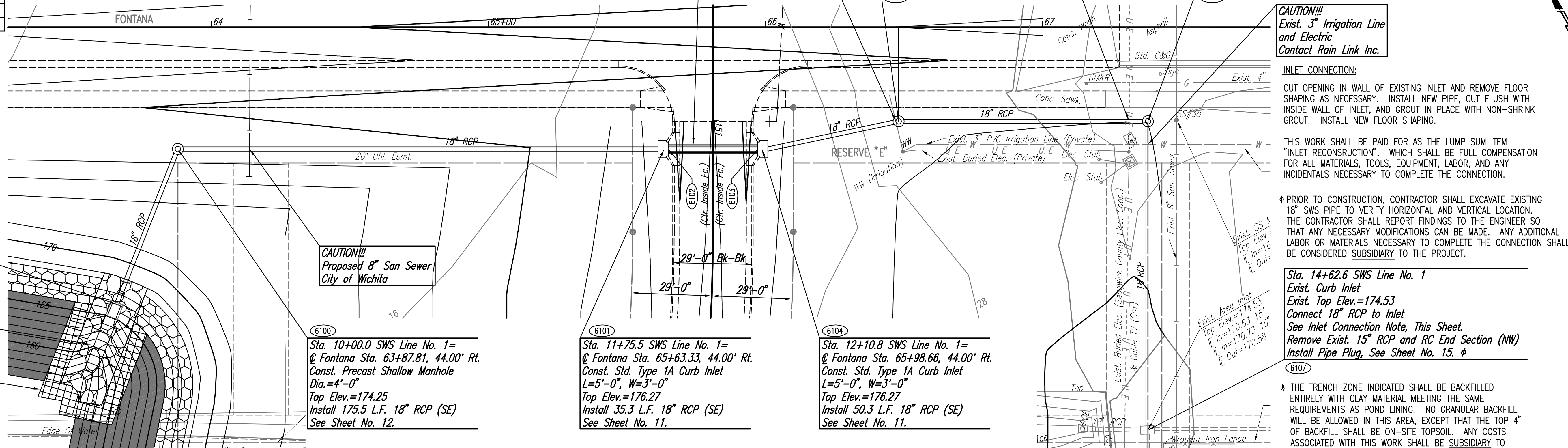

**CAUTION!!!**  
Exist. 3" Irrigation Line and Electric Contact Rain Link Inc.

**INLET CONNECTION:**  
CUT OPENING IN WALL OF EXISTING INLET AND REMOVE FLOOR SHAPING AS NECESSARY. INSTALL NEW PIPE, CUT FLUSH WITH INSIDE WALL OF INLET, AND GROUT IN PLACE WITH NON-SHRINK GROUT. INSTALL NEW FLOOR SHAPING.

THIS WORK SHALL BE PAID FOR AS THE LUMP SUM ITEM "INLET RECONSTRUCTION". WHICH SHALL BE FULL COMPENSATION FOR ALL MATERIALS, TOOLS, EQUIPMENT, LABOR, AND ANY INCIDENTALS NECESSARY TO COMPLETE THE CONNECTION.

PHI PRIOR TO CONSTRUCTION, CONTRACTOR SHALL EXCAVATE EXISTING 18" SWS PIPE TO VERIFY HORIZONTAL AND VERTICAL LOCATION. THE CONTRACTOR SHALL REPORT FINDINGS TO THE ENGINEER SO THAT ANY NECESSARY MODIFICATIONS CAN BE MADE. ANY ADDITIONAL LABOR OR MATERIALS NECESSARY TO COMPLETE THE CONNECTION SHALL BE CONSIDERED SUBSIDIARY TO THE PROJECT.

Sta. 14+62.6 SWS Line No. 1  
Exist. Curb Inlet  
Exist. Top Elev.=174.53  
Connect 18" RCP to Inlet  
See Inlet Connection Note, This Sheet.  
Remove Exist. 15" RCP and RC End Section (NW)  
Install Pipe Plug, See Sheet No. 15. phi

\* THE TRENCH ZONE INDICATED SHALL BE BACKFILLED ENTIRELY WITH CLAY MATERIAL MEETING THE SAME REQUIREMENTS AS POND LINING. NO GRANULAR BACKFILL WILL BE ALLOWED IN THIS AREA, EXCEPT THAT THE TOP 4" OF BACKFILL SHALL BE ON-SITE TOPSOIL. ANY COSTS ASSOCIATED WITH THIS WORK SHALL BE SUBSIDIARY TO THE PRICE BID FOR 18" RCP.

DATE	
BY	
CHECKED	
CHECKED	
PLAN	

DATE	
BY	
CHECKED	
CHECKED	
PROFILE	

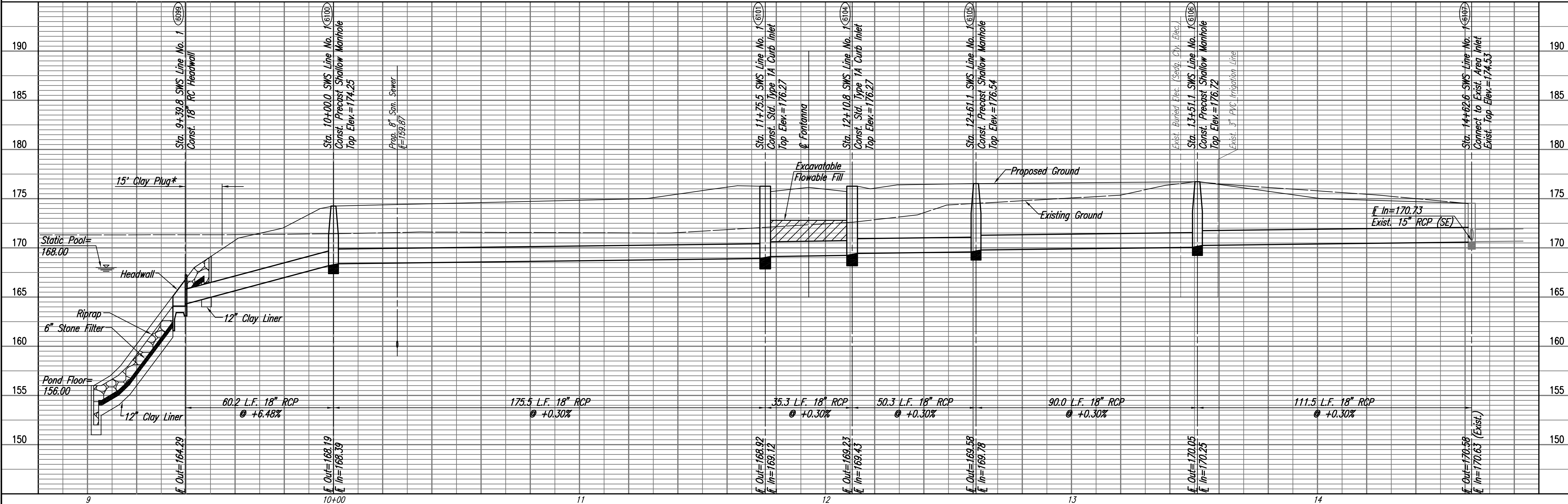

Saved: 11-12-2010 4:56:26 PM by BLS  
Plot Scale: 1:20 (11-12-2010 4:56:50 PM by BILL J. SEIXSON  
G:\2009\08389\004\08389-004-C-SWSLINE 1

Fontana 4th Addition-Phase 2  
Storm Water Drain No. 283

### SWS LINE NO. 1

JAMES L. ARMOUR, P.E. - CITY ENGINEER  
CITY OF WICHITA PROJ. NO. 468-84172

Professional Engineering Consultants, P.A.  
303 S. TOPEKA AVE., SUITE 100, WICHITA, KANSAS 67202  
316-262-2091 • FAX 316-262-3003

Designed By: BMM  
Date: September 2009

Job No.: 35-08389-004  
Drawn By: BUS

Sheet 10 of 28