

GENERAL NOTES

- UNLESS SHOWN OR STATED OTHERWISE ON THESE DRAWINGS, MATERIALS AND CONSTRUCTION SHALL BE IN ACCORDANCE WITH CITY OF WICHITA STANDARD SPECIFICATIONS.
- THE TOPS OF INLETS AND MANHOLES AS NOTED ON THE PLANS MAY VARY SO AS TO MEET PROPOSED TOP OF CURB ELEVATIONS OR PAVEMENT ELEVATIONS. THE CONTRACTOR SHALL BE RESPONSIBLE FOR PRESERVING PROPERTY IRONS.
- THE CONTRACTOR SHALL BE REQUIRED TO RE-ESTABLISH ANY PROPERTY IRONS WHICH ARE DAMAGED OR DESTROYED BY HIS CONSTRUCTION OPERATIONS. SUCH IRONS SHALL BE RE-ESTABLISHED BY A LICENSED LAND SURVEYOR IN ACCORDANCE WITH STATE LAWS. CONTRACTOR SHALL NOTIFY UTILITY COMPANIES OF CONSTRUCTION SCHEDULING.
- EXISTING UTILITIES AND THEIR LOCATIONS, AS SHOWN ON THE PLANS REPRESENT THE BEST INFORMATION OBTAINABLE FOR DESIGN. THE PLAN LOCATIONS SHOWN ARE NOT GUARANTEED. ADDITIONAL EXISTING UTILITIES MAY ALSO BE ENCOUNTERED.
- CONTRACTOR WILL BE REQUIRED TO PROVIDE A MINIMUM ADVANCE NOTICE OF FORTY-EIGHT (48) HOURS TO UTILITY COMPANIES PRIOR TO STARTING ANY EXCAVATION AS FOLLOWS:
KANSAS ONE-CALL 800-344-7233 OR 687-2470 (LOCAL WICHITA)
THE CONTRACTOR MUST NOTIFY THE FOLLOWING IN CASE OF EMERGENCY:
COX COMMUNICATIONS (CABLE) 262-0661
WESTAR ENERGY (ELECTRIC) 261-6512
AT&T (TELEPHONE) 1-800-225-5288
CITY OF WICHITA WATER & SEWER 262-6000
AQUILA (GAS) 946-0016
KANSAS GAS SERVICE (GAS) 832-3101
- RUBBLE FROM THE REMOVAL OF MISCELLANEOUS STRUCTURES AND EXCESS EXCAVATION WHICH IS TO BE WASTED SHALL BE DISPOSED OF ON SITES TO BE PROVIDED BY THE CONTRACTOR. THESE SITES SHALL BE APPROVED BY THE ENGINEER AS TO SUITABILITY, APPEARANCE AND SITE LOCATION. LOCATIONS THAT, IN THE OPINION OF THE ENGINEER, WILL LEAVE AN UNSIGHTLY APPEARANCE WILL NOT BE APPROVED. ALL DISPOSAL SITES MUST BE APPROVED BY THE KANSAS DEPARTMENT OF HEALTH AND ENVIRONMENT. MATERIAL EITHER STOCKPILED OR DISPOSED OF IN A FLOOD PLAIN WOULD REQUIRE A KANSAS STATE BOARD OF AGRICULTURE PERMIT. ANY MATERIAL DUMPED IN WATERS OF THE UNITED STATES OR WETLANDS IS SUBJECT TO U.S. CORPS OF ENGINEERS PERMITTING REGULATIONS.
- ALL COMPACTION OF EARTHWORK SHALL BE 95% STANDARD DENSITY.
- OTHER CONSTRUCTION MAY BE UNDER WAY SIMULTANEOUSLY WITH THIS PROJECT. THE CONTRACTOR SHALL COORDINATE WITH ANY CONTRACTORS CONSTRUCTING OTHER PORTIONS OF THE PROJECT.
- EXCESS EXCAVATION SHALL BE STOCKPILED ON-SITE IN A LOCATION APPROVED BY THE OWNER'S REPRESENTATIVE.
- STORE MATERIAL BACK FOR CLAY LINER IN PONDS. CONTRACTOR SHALL WORK WITH THE CITY OR OWNER'S REPRESENTATIVE TO SELECT DESIRED MATERIAL.

LEGEND:

- - - 1369 - - - EXISTING CONTOURS
- 1371 — PROPOSED CONTOURS
- - - - - LIMITS OF GRADING
- 70.60
0.10 - TOP OF CURB ELEVATION
- FLOWLINE ELEVATION

NOTE:
COORDINATE SIDEWALK/H.C. RAMP LOCATIONS W/
ARCHITECT DRAWINGS. SIDEWALKS SHALL NOT
EXCEED A 2% CROSS SLOPE OR 5% LONGITUDINAL
SLOPE.

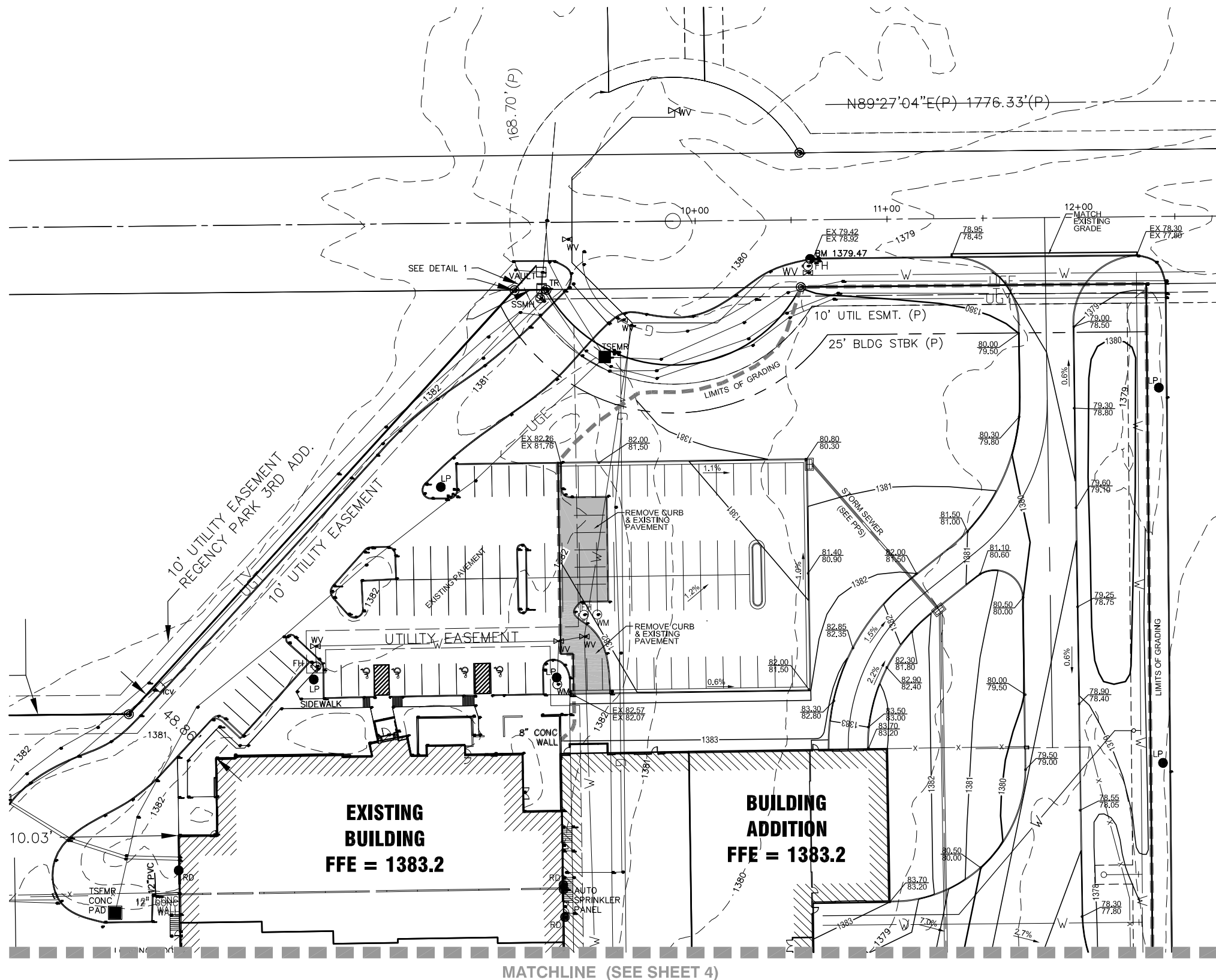

MATCHLINE (SEE SHEET 4)

GRADING PLAN
SCALE: 1" = 30'-0"

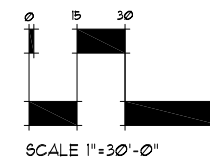

THE LDF COMPANIES
OFFICE & WAREHOUSE
ADDITION AND REMODEL

GRADING PLAN

SHEET TITLE
09492
PROJECT NUMBER

GLA / RKO / GJA
DESIGNED / DRAWN / CHECKED

ISSUED
October 2009

REVISED

SHEET NO.

3 of 7