

THE LDF COMPANIES
OFFICE & WAREHOUSE
ADDITION AND REMODEL

GRADING PLAN

SHEET TITLE
09492
PROJECT NUMBER

GLA / RKO / GJA
DESIGNED / DRAWN / CHECKED

ISSUED
October 2009

REVISED

SHEET NO.
4 of 7

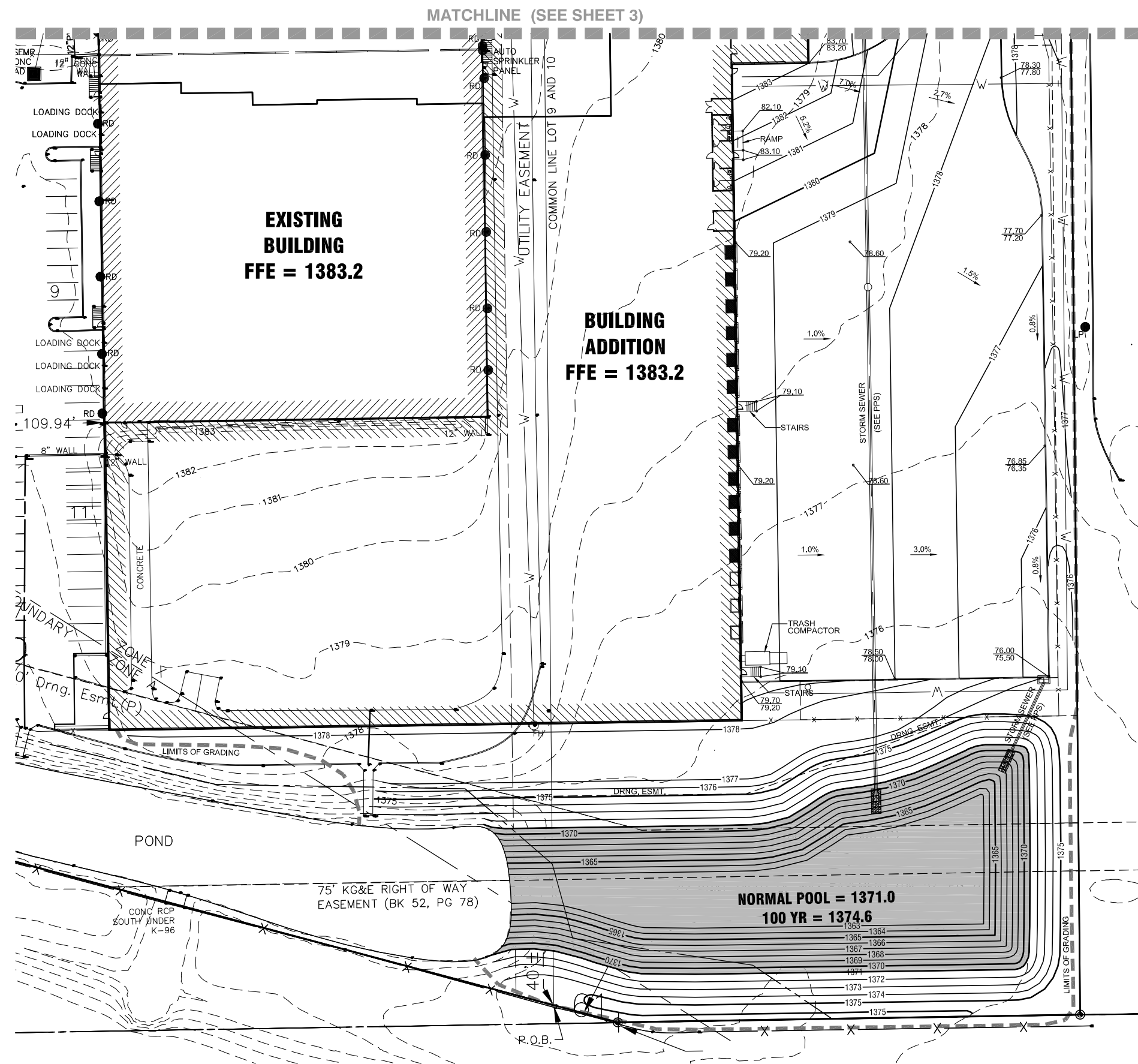

NOTE:
1. CONTRACTOR SHALL MAKE EVERY EFFORT TO USE THE CHOICE MATERIAL FOR CLAY LINER. PI-31 IS A MINIMUM.

OVER EXCAVATE 12" OF SOIL. PLACE IN TWO 6" LIFTS CLAY LINER (PI=31). COMPACT TO 2% ABOVE OPTIMUM ASTM D698 95% RELATIVE MAX. DENSITY. A PERMIABILITY TEST OF THE LINER MATERIAL SHALL BE PERFORMED BY A GEOTECHNICAL SOILS ENGINEER AT A RANDOM LOCATION AS DETERMINED BY THE PROJECT INSPECTOR AND AT THE CONTRACTORS EXPENSE (1 PER POND). THE CLAY LINER MATERIAL SHALL MEET OR EXCEED A PERMIABILITY RATING VALUE OF 10 -7. ALL COST ASSOCIATED WITH THIS WORK SHALL BE SUBSIDIARY TO EARTHWORK ITEMS.

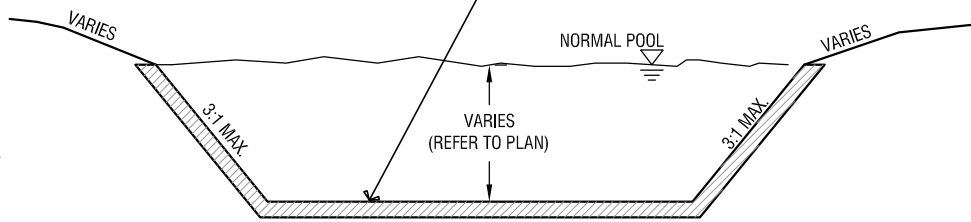

LEGEND:

- - - 1369 - - - EXISTING CONTOURS
- 1371 — PROPOSED CONTOURS
- - - LIMITS OF GRADING
- 70.60
0.10 - TOP OF CURB ELEVATION
- - - FLOWLINE ELEVATION

NOTE:
COORDINATE SIDEWALK/H.C. RAMP LOCATIONS W/ ARCHITECT DRAWINGS. SIDEWALKS SHALL NOT EXCEED A 2% CROSS SLOPE OR 5% LONGITUDINAL SLOPE.

GRADING PLAN

SCALE: 1" = 30'-0"

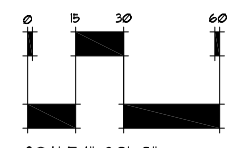

SCALE 1" = 30'-0"