

THE LDF COMPANIES
OFFICE & WAREHOUSE
ADDITION AND REMODEL

PAVING & UTIL

SHEET TITLE
09492
PROJECT NUMBER

GLA / RKO / GJA
DESIGNED / DRAWN / CHECKED





ISSUED
October 2009

REVISED

SHEET NO.

5 of 7

PAVING LEGEND:

-  7" CONCRETE ON 8" MODIFIED SUBGRADE
-  2" SURFACE COARSE AND 3.5" BASE COURSE ON 8" MODIFIED SUBGRADE
-  EXISTING PAVEMENT REMOVAL
-  4" CONCRETE WALK

NOTE:
SEE PAVEMENT SECTION OF TERRACON REPORT
#01045024 FOR ADDITIONAL PAVEMENT DETAILS.

GENERAL NOTES

1. PIPE MATERIALS SHALL BE AS FOLLOWS:
WATER LINE
2 1/2" OR SMALLER - CLASS 200 PVC
4" OR LARGER - C900 OR C905 PVC
SANITARY SEWER
6" OR SMALLER - SCHEDULE 40 PVC
8" OR LARGER - SDR-35 PVC
STORM SEWER AND RAIN LEADERS
6" OR SMALLER - SCHEDULE 40 PVC
12" OR SMALLER - SDR-35 PVC
15" OR LARGER - CLASS III RCP (PAVEMENT)
- HDPE (LANDSCAPE)
2. REFER TO PRIVATE PROJECT PLAN & PROFILES FOR CONSTRUCTION OF STORM WATER SEWER AND WATER LINE.

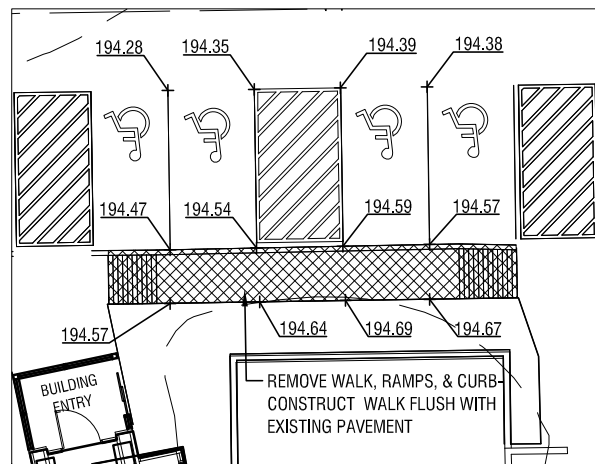

ADDITIONAL HANDICAP STALLS DETAIL
SCALE: 1"=10'-0"

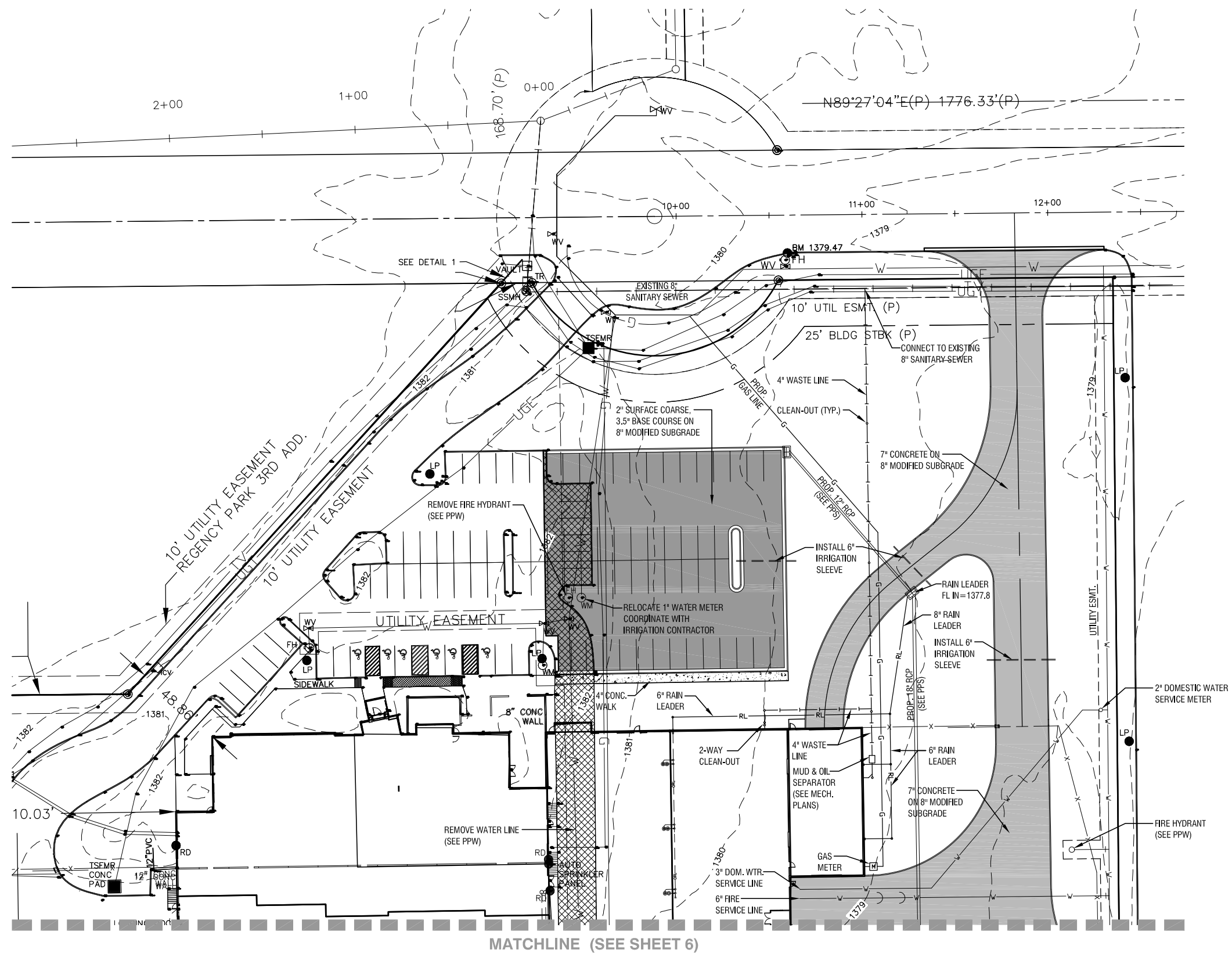

PAVING & UTILITY PLAN
SCALE: 1" = 30'-0"

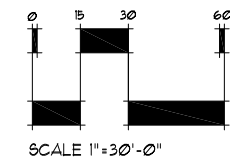

PLOTED: Thursday, February 18, 2010 @ 10:36AM

J:\CIVIL\09492\DWG\SHEETS\09492_PAV_1.DWG