

# CONSTRUCTION PLANS FOR PRIVATE WATER LINE IMPROVEMENTS HORIZON MILLINGS

TO  
**THE CITY OF WICHITA, KANSAS**  
**JAMES ARMOUR, P.E. – CITY ENGINEER**  
**1538 PPW OCA NO. 607853**

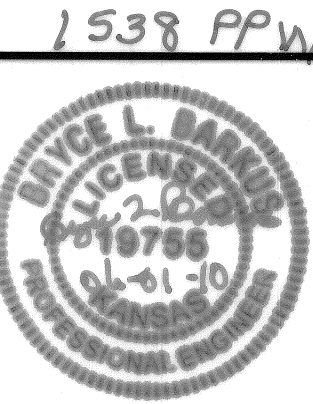

Rev.	Date	By	Description

**GENERAL NOTES:**

- Existing utilities, both above and below ground, and their locations as shown on the plans, represent the best information available for design. The locations of utilities as shown on the plans are not guaranteed and the Contractor shall verify all utilities and their locations before beginning construction. Additional utilities, including relocated utilities, which are not shown on the plans may be encountered. In this event, the Contractor shall adjust his schedule and cooperate with the utility companies to ensure that their facilities be adjusted as required to clear construction. The Contractor shall exercise extreme caution while working near utilities.
- All water mains and appurtenances shall be installed in accordance with the City of Wichita, Kansas Standard Specifications for Water Main Construction.
- The Water Department shall field locate water valves one time during construction when requested by the Contractor. It shall be the responsibility of the Contractor to preserve such field locations during the construction process. Water valves, water valve boxes, or fire hydrants damaged during construction shall be repaired at the Contractor's expense. Contact Greg Lolley with the Wichita Water Department for water service information at 268-4555.
- Opening and closing water valves shall be done slowly to prevent damage to the distribution system by a water hammer. All valves that are closed by the Contractor must be reopened as new construction permits. The Project Inspector must ascertain that any valve closed by the Contractor is reopened. The Contractor will be permitted to operate a water valve only when the Project Inspector assigned to the project is present.
- The Contractor shall not start work on the project until the Project Inspector assigned to the project is present. Any work done without inspection will be required to be uncovered for inspection.
- Power Poles within close proximity to the new water line may require temporary bracing to facilitate construction. Contractor shall contact Shane Price at Westar Energy at 261-6315 prior to construction to coordinate pole bracing.
- Temporary Blow-off Valves necessary to flush lines at existing water line tie-ins shall not be paid directly, but shall be considered INCIDENTAL to other items bid.
- All open cut pipe trench under new pavement shall be back-filled with sand, flushed with water and vibrated.
- All water pipe trench in pavement or driveways which will be required to carry traffic until permanent replacement shall be topped with a minimum of 6" crushed rock (Compacted) to be INCIDENTAL to the project. Contractor shall be required to maintain temporary crushed rock until permanent pavement is installed.
- Contractor shall give all Property Owners and/or Tenants of developed property directly abutting the construction of the project a minimum of ten (10) days notice prior to the start of construction and a 24 hour notice prior to any planned water shut down.
- Each Bidder shall visit the site of the project before submitting a proposal in order to become better informed of the existing field condition and obstacles which might be encountered during construction. Each Bidder should understand that no additional compensation will be awarded for extra work that should have been evaluated prior to bidding.
- This project to be coordinated with the adjacent private street project PPP 607879. The proposed grades shown are based on the elevations shown on the street plans.
- The Contractor shall provide all construction staking.
- The Owner shall provide all construction inspection, testing and shop drawing review.

**SHEET INDEX**

C100	TITLE SHEET
C101	CONTROL POINT MAP
C200	WATER LINE PLAN & PROFILE
C201	WATER LINE DETAILS
C400	EROSION CONTROL PLAN
C401-C405	BMP DETAILS
S100	UTILITY PROTECTION PLAN
S101	UTILITY PROTECTION QUANTITIES & NOTES
S102-S103	UTILITY PROTECTION DETAILS

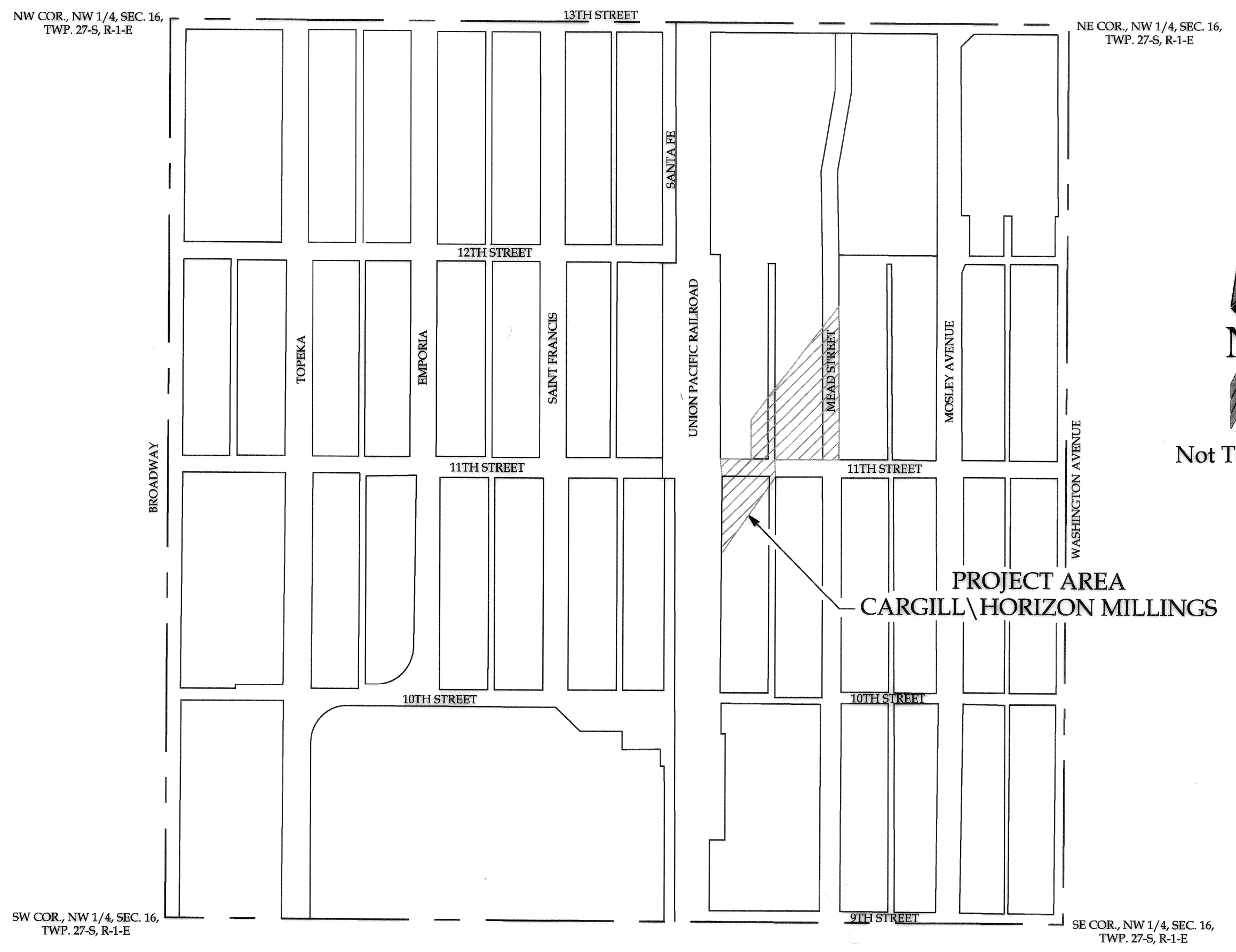

AS BUILT PLANS  
CONTRACTOR: MCCA CONSTRUCTION, Inc.  
INSPECTOR: ASM ENGINEERING  
PDF BY: BLB 1-13-11  
PROJECT WAS CONSTRUCTED AS SHOWN  
ON AS BUILT PLANS

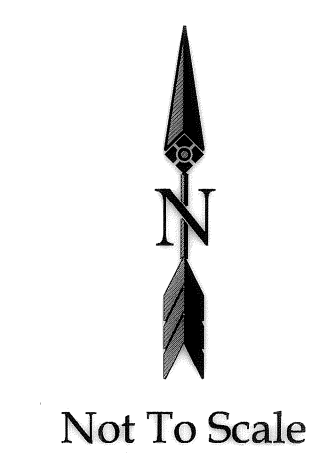

APPROVED AS NOTED  
BY CITY ENGINEER OF WICHITA  
Water Mains [Signature] 6/1/10  
[Signature] 6/1/2010  
NOTE TO CONTRACTORS  
Installation, inspection and testing for this project is to be provided by a Licensed Consulting Engineering Firm under contract with the Owner/Developer. Said inspection to be in accordance with the City of Wichita standard construction engineering practices and certified by a Licensed Professional Engineer. No work shall be performed in dedicated easements or public right-of-way by the Contractor without such inspection nor shall any work be commenced without written authorization by the City Engineer. All Construction and Materials shall comply with the City of Wichita Specifications and Standards (on file and available in the City Engineer's Office).

**MAY 2010**

AMERITRACK WEST, INC.  
12469 SW 15th  
Benton, KS 67017  
OF: 316-778-2215  
F: 316-778-1204

**Ameritrack WEST**

HORIZON MILLINGS  
WICHITA, KANSAS  
JAMES ARMOUR, P.E. - CITY ENGINEER  
1538 PPW OCA No. 607853

Client:

TITLE SHEET

Drawing No.  
**C100**

Project No.  
**465**