

PLAN	CHECKED	CHECKED
BY		
DATE		

PROFILE	CHECKED	CHECKED
BY		
DATE		

COORDINATE LIST FOR ROADWAY ESMT.		
POINT	NORTH	EAST
6200	40,550.4482	40,004.7211

6200 = COORDINATE POINT NO.
SEE SHEET NO. 3 FOR HORIZONTAL CONTROL.

ALL TREES OR SHRUBS WITHIN THE ROADWAY AND ACCESS AND DRAINAGE EASEMENT SHALL BE REMOVED. SEE SHEET NO. 2, GENERAL NOTE 15.

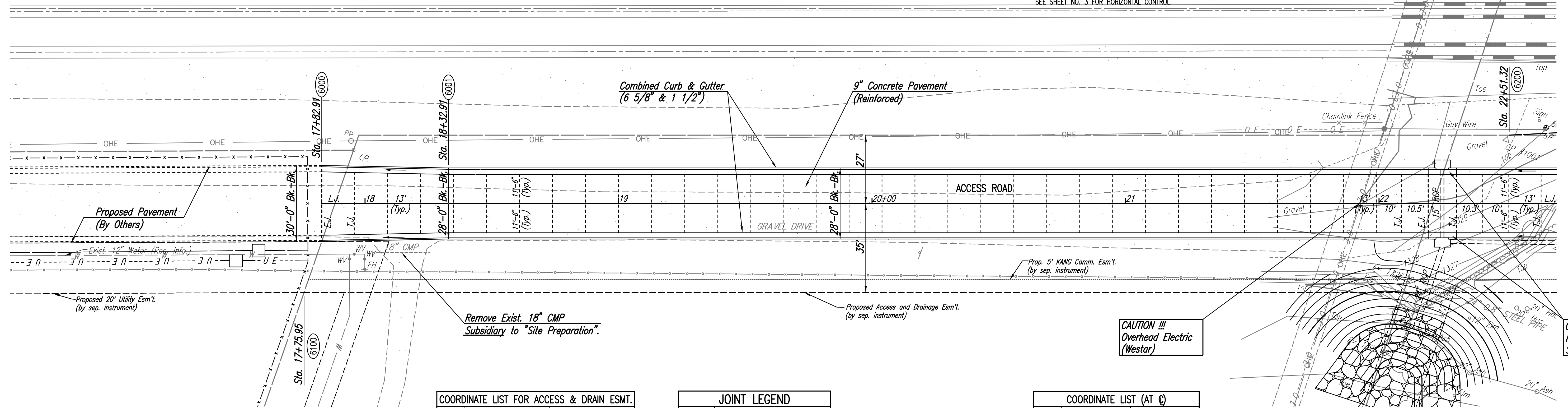
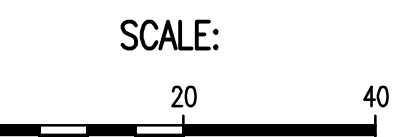

COORDINATE LIST FOR ACCESS & DRAIN ESMT.		
POINT	NORTH	EAST
6100	40,330.1133	39,578.9683

6100 = COORDINATE POINT NO.
SEE SHEET NO. 3 FOR HORIZONTAL CONTROL.

JOINT LEGEND	
TYPE	DESCRIPTION
E.J.	EXPANSION JOINT
L.J.	LONGITUDINAL JOINT
T.J.	TRANSVERSE JOINT

See Sheet No. 18 for Joint Details

ANY DEVIATIONS FROM THE JOINTING PLAN MUST BE APPROVED BY THE ENGINEER.

COORDINATE LIST (AT @)		
POINT	NORTH	EAST
6000	40,365.4003	39,573.5758
6001	40,382.4477	39,620.5799

6000 = COORDINATE POINT NO.
SEE SHEET NO. 3 FOR HORIZONTAL CONTROL.

CAUTION !!!
Overhead Electric (Westar)

Const. Std. Type 1
Inlet Hookups (2)
See Sheet No. 35.

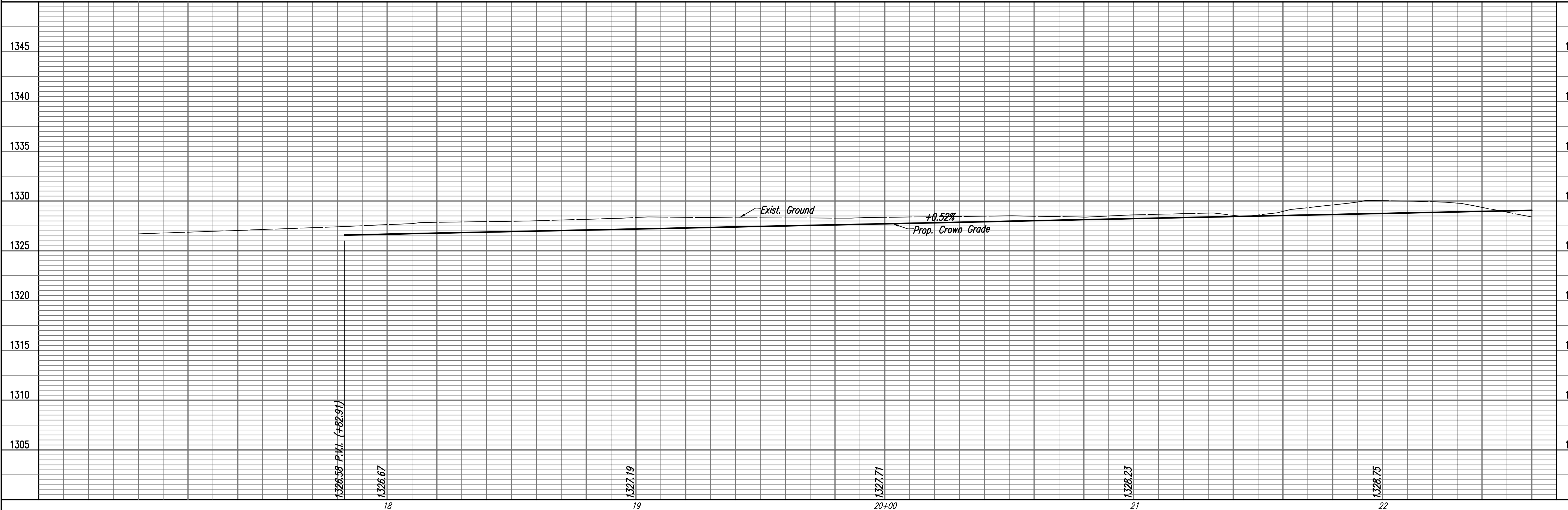

Drawn 01-18-2011 5:26:28 PM by BIS
Plot Scale 1:20 01-18-2011 5:50:47 PM by BILL J. SEASON
G:\2009\09307\000\PAVING\09307-10C-PAVING PLAN 1

HEARTLAND PREPAREDNESS CENTER
PAVING AND DRAINAGE IMPROVEMENTS
ACCESS ROAD
STA. 17+86.47 TO STA. 22+50
JAMES L. ARMOUR, P.E. - CITY ENGINEER
CITY OF WICHITA PROJ. NO. 472-84898

Professional Engineering Consultants, P.A.
309 S. TOPEKA, WICHITA, KANSAS 67202
316-262-2091 • FAX 316-262-3003
Designed By: BMM
Drawn By: BUS
Job No.: 35-09307
Date: December 2009